

ATTACHMENT B CONCEPTUAL SITE PLAN

ARBOT ROAD

**3M WIDE SRW
(PUBLIC PATH)
WITH 1.2M HIGH
FENCING**

PUBLIC TRAIL IN 3m RIGHT OF WAY 1.2m
HIGH FENCE W/ LANDSCAPE SCREENING TO
SUIT ACCEPTED DESIGN AT DP

SITE PLAN
SCALE: 1 : 300

**2
PLAN**

**AREA 2:
ONSITE TREE
PROTECTION &
RESTORATION
AREA**

**AREA 1:
PARK DEDICATION &
RESTORATION AREA**

**PART SECTION 10
SHOWN ON PLAN 2035
WESTWOOD LAKE**

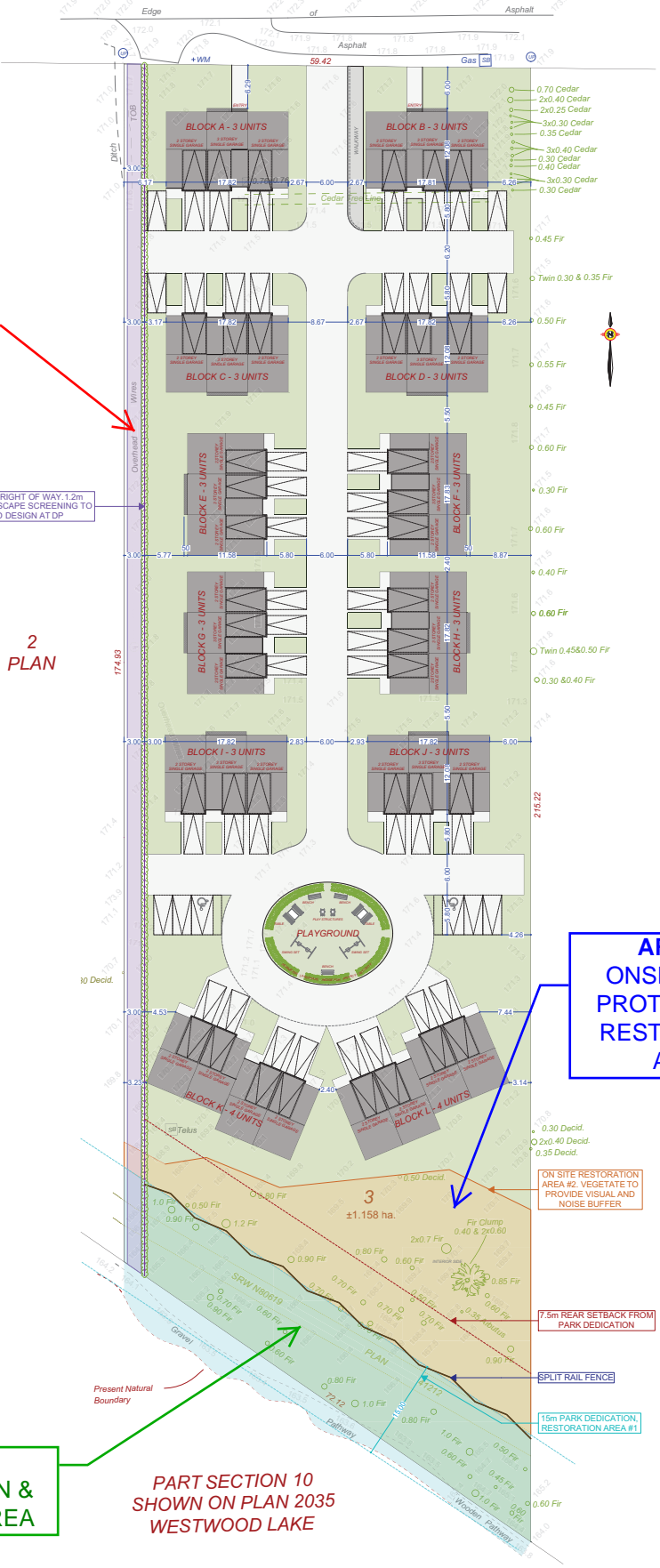

RECEIVED
RA512
2025-SEP-25
Current Planning

A1
SHEET
NUMBER

JAVA DESIGNS

102 - 2871 JACKLIN ROAD
VICTORIA BC V9B 0P3
JAVADESIGNS.CA
250.590.2468

ISSUE DATE:
SEPT 10, 2025
DRAWN BY:
NS
CHECKED BY:
KL

DRAWING NAME:
PROPOSED TOWNHOUSE
DEVELOPMENT
DRAWING SCALE:
SEE DRAWINGS

ADDRESS:
2367 ARBOT RD, NANAIMO BC
CUSTOMER:
LIMONA HOLDINGS LTD