

ATTACHMENT C SITE SURVEY

B.C. LAND SURVEYOR'S STAIR LOCATION CERTIFICATE ON:
LOT 7, DISTRICT LOT 41,
WELLINGTON DISTRICT, PLAN 25341.

P.I.D. 002-904-624

CIVIC ADDRESS: 3974 HAMMOND BAY ROAD NANAIMO

THIS DOCUMENT WAS PREPARED FOR MUNICIPAL AND MORTGAGE PURPOSES AND IS
EXCLUSIVE USE OF OUR CLIENT, KEN RUTLAND.

THIS DOCUMENT SHOWS THE RELATIVE LOCATION OF THE SURVEYED STRUCTURES AND
FEATURES WITH RESPECT TO THE BOUNDARIES OF THE PARCEL DESCRIBED ABOVE. THIS
DOCUMENT SHALL NOT BE USED TO DEFINE PROPERTY LINES OR PROPERTY CORNERS.
TURNER & ASSOCIATES LAND SURVEYING INC. ACCEPTS NO RESPONSIBILITY FOR AND
HEREBY DISCLAIM ALL OBLIGATIONS AND LIABILITIES FOR DAMAGES ARISING OUT OF OR IN
CONNECTION WITH ANY DIRECT OR INDIRECT USE OR RELIANCE UPON THE PLAN BEYOND
ITS INTENDED USE. CERTIFIED CORRECT THIS 23rd DAY OF MARCH, 2025.



BRODY PHILLIPS, B.C.L.S. #994

(THIS DOCUMENT IS NOT VALID UNLESS ORIGINALLY SIGNED AND SEALED).

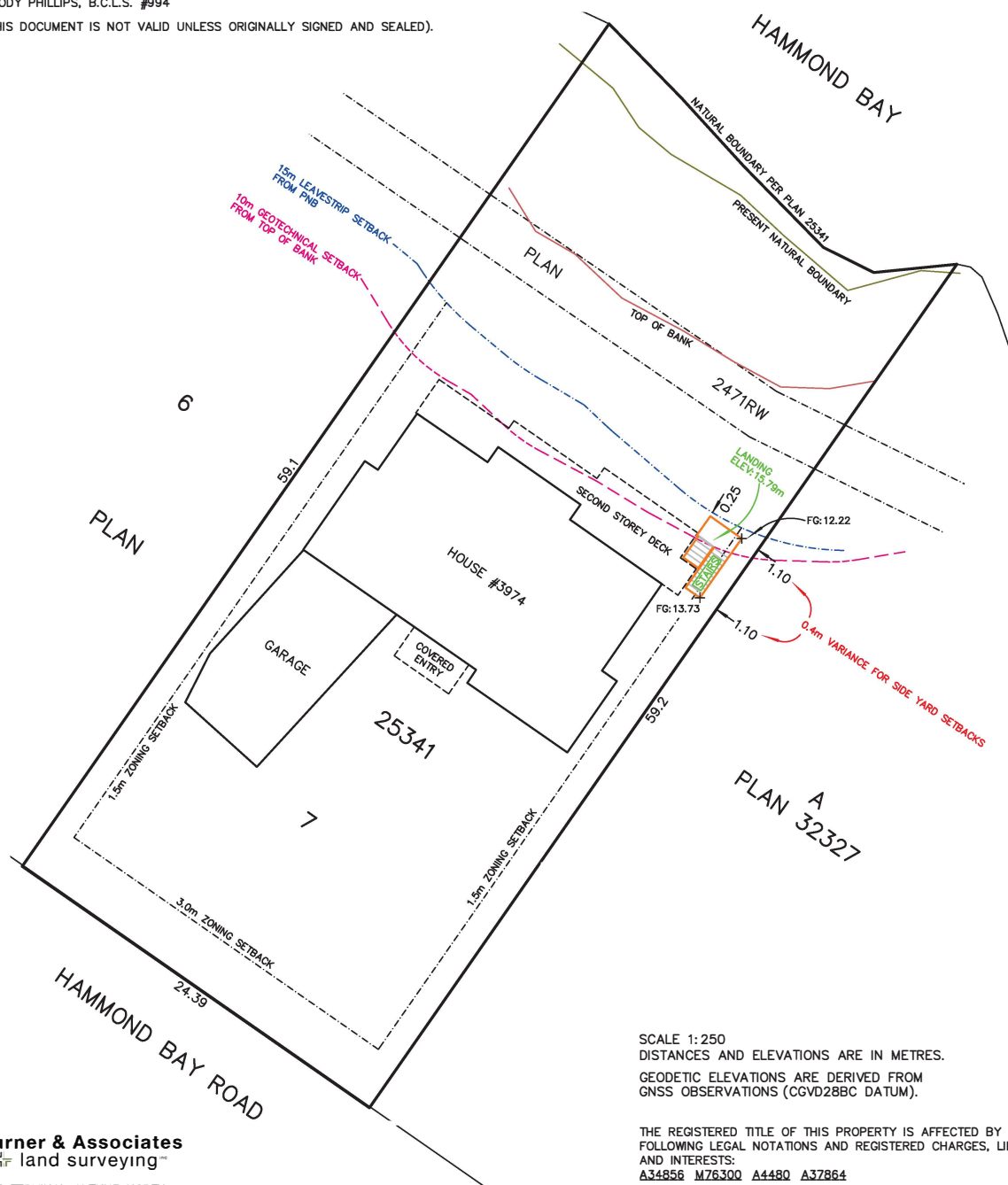

SCALE 1:250

DISTANCES AND ELEVATIONS ARE IN METRES.

GEODETIC ELEVATIONS ARE DERIVED FROM
GNSS OBSERVATIONS (CGVD28BC DATUM).

THE REGISTERED TITLE OF THIS PROPERTY IS AFFECTED BY THE
FOLLOWING LEGAL NOTATIONS AND REGISTERED CHARGES, LIENS
AND INTERESTS:

A34856 M76300 A4480 A37864

THIS SITE PLAN DOES NOT VERIFY COMPLIANCE WITH THE ABOVE
NOTED DOCUMENTS.

© ALL RIGHTS RESERVED. NO PERSON MAY COPY,
REPRODUCE, TRANSMIT, OR ALTER THIS DOCUMENT IN
WHOLE OR IN PART WITHOUT THE CONSENT OF THE SIGNATORY.

Turner & Associates
land surveying™

435 TERMINAL AVENUE NORTH
NANAIMO, B.C.
V9S 4J8
250-753-9778
www.turnersurveys.ca
File: 19-172-7