

ATTACHMENT C SITE PLAN

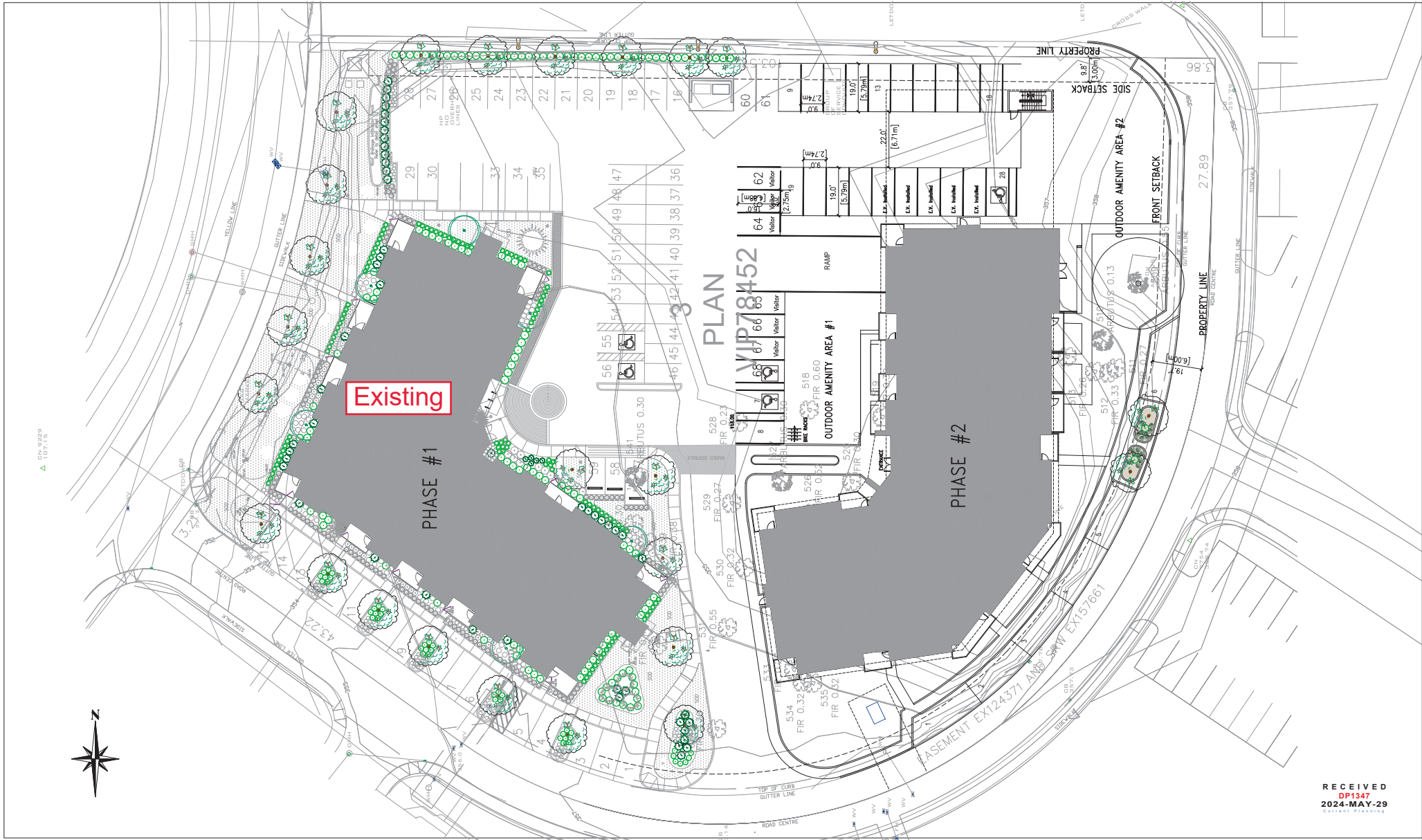

RECEIVED
DP1347
2024-MAY-29

NOTES
1. This drawing is an approved set of plans for the proposed development and shall be used in accordance with the approved conditions of approval. It is the responsibility of the applicant to ensure that the proposed development complies with all applicable laws, regulations, and codes. The applicant shall be responsible for obtaining all necessary permits and approvals from the appropriate authorities. The applicant shall also be responsible for ensuring that the proposed development is constructed and maintained in accordance with the approved conditions of approval. The applicant shall also be responsible for ensuring that the proposed development is operated and maintained in accordance with the approved conditions of approval. The applicant shall also be responsible for ensuring that the proposed development is demolished and removed in accordance with the approved conditions of approval.

D-ARCHITECTURE
2377 HANUS DRIVE, NANAIMO, BC V9V 1N4
T: 250-933-1991, E: FIRGULZI@D-ARCH.COM
DARYOUSH FIRGULZI ARCHITECTURE INC.

ARCHITECT SEAL: _____
CONSULTANT SEAL: _____
CONSULTANT SEAL: _____

SCALE: _____
DRAWN: _____
CHECKED: _____
DATE: 28 MAR 22

PROJECT: 6330 MCROBB AVENUE
NANAIMO, BC
PHASE #2

CLIENT: ROBIN KELLEY
PROJECT NO: 2750

SHEET TITLE: OVERALL SITE PLAN
PRELIMINARY

SHEET NO: **A0.1**
REVISION: _____

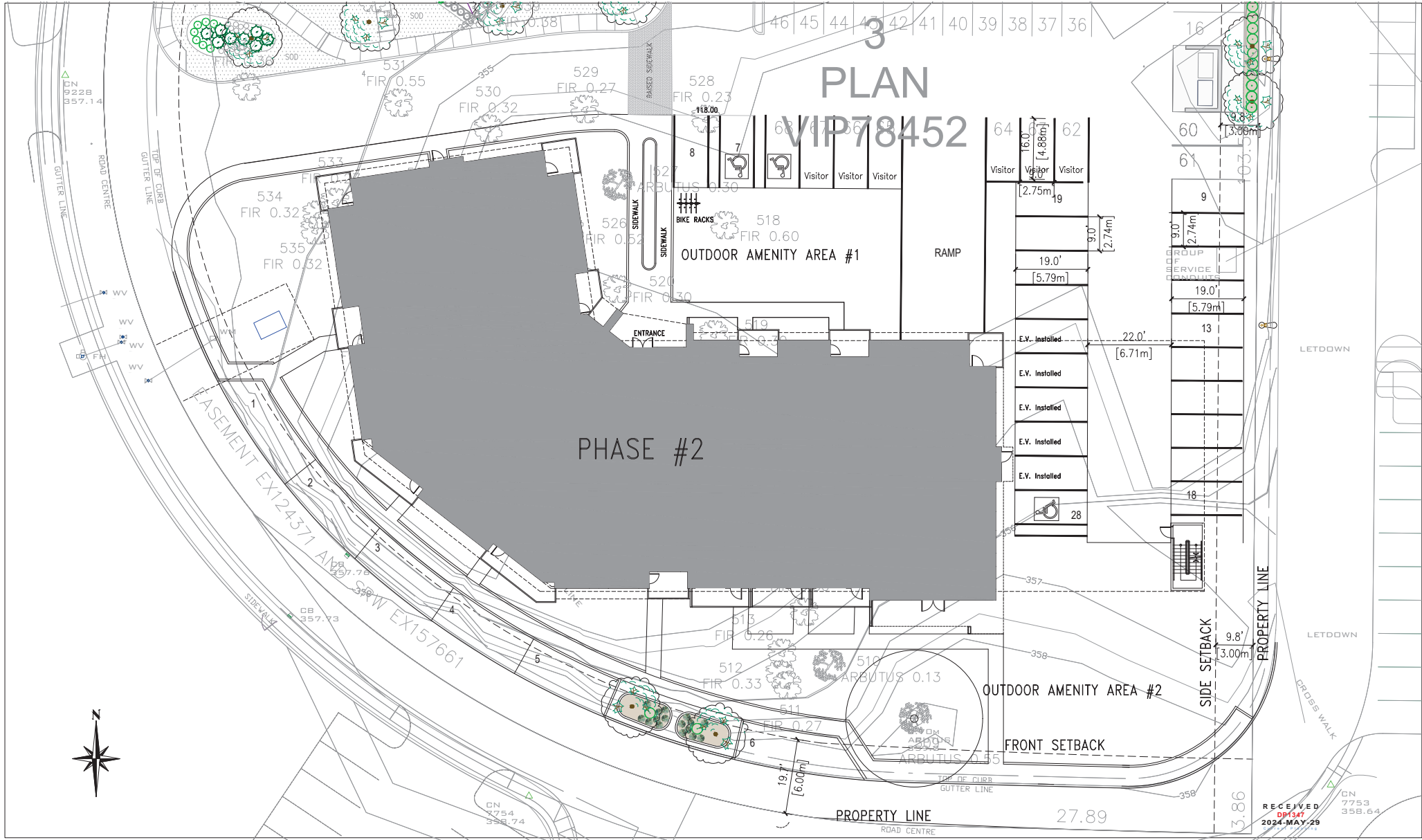

PLAN VIP78452

PHASE #2

OUTDOOR AMENITY AREA #1

OUTDOOR AMENITY AREA #2

FRONT SETBACK

SIDE SETBACK

PROPERTY LINE

RECEIVED
DP 1547
2024-MAY-29

NOTES
1. The owner is to be advised of all applicable laws, codes, and regulations that may affect the project. The architect is not responsible for the accuracy of the information provided by the owner or other sources. The architect is not responsible for the accuracy of the information provided by the owner or other sources. The architect is not responsible for the accuracy of the information provided by the owner or other sources.



D-ARCHITECTURE
6377 HARBOR DRIVE, NANAIMO, BC V9Y 1N4
T: 250-933-1991 F: 250-933-1991
WWW.D-ARCHITECTURE.COM

ARCHITECT SEAL

CONSULTANT LOGO

CONSULTANT SEAL

SCALE
3/32" = 1'-0"

DATE
28 MAR 22

PROJECT
6330 MCROBB AVENUE
NANAIMO, BC
PHASE #2

CLIENT
ROBIN KELLEY
PROJECT NO.
2750

SHEET TITLE
SITE PLAN
PRELIMINARY

SHEET NO.
A1.1
REVISION