

# ATTACHMENT C SITE AND PARKING PLAN

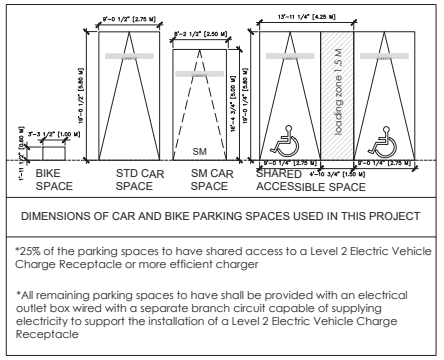
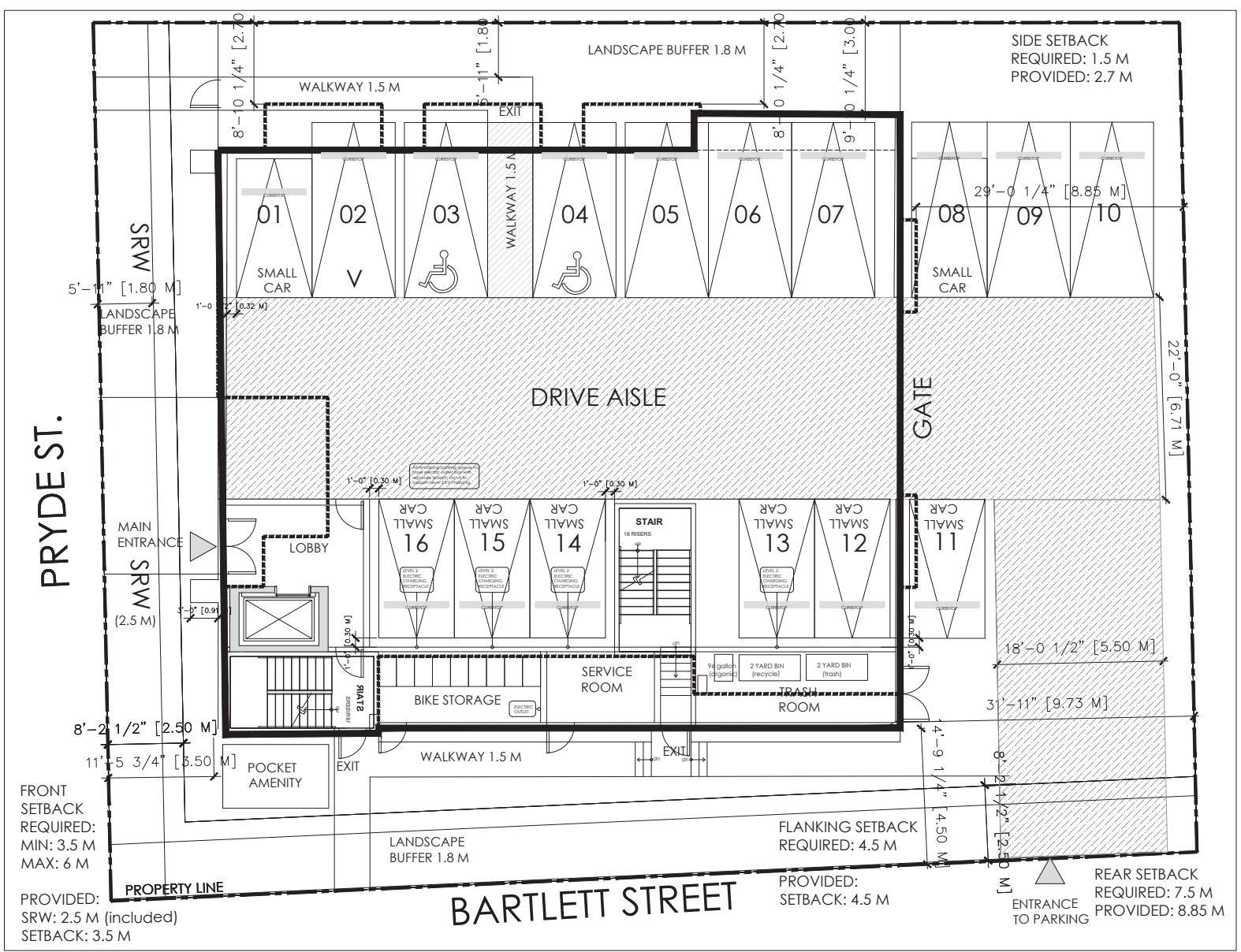

**JOYCE REID TROOST ARCHITECTURE**  
2515 GLENAYR DRIVE  
NANAIMO, BC V9S 3R9  
joyce@jrtarchitecture.com  
250.714.8749  
jrtarchitecture.com

THE DRAWING, DESIGN, DESIGN AND  
REVISIONS OF CONSTRUCTION-DRAWING  
HEREON ARE THE SOLE PROPERTY OF  
JOYCE REID TROOST ARCHITECTURE. ALL  
RIGHTS RESERVED. NO PART OF THIS  
DRAWING IS TO BE REPRODUCED OR  
TRANSMITTED IN ANY FORM OR BY ANY  
MEANS, ELECTRONIC OR MECHANICAL,  
INCLUDING PHOTOCOPYING, RECORDING,  
OR BY ANY INFORMATION STORAGE AND  
RETRIEVAL SYSTEM, WITHOUT THE  
WRITTEN PERMISSION OF JOYCE REID  
TROOST ARCHITECTURE. ANY UNLAWFUL  
USE OF THIS DRAWING BY A THIRD PARTY IS  
THE SOLE RESPONSIBILITY OF THAT PARTY.  
JOYCE REID TROOST ARCHITECTURE  
REID TROOST ARCHITECTURE RESPONSIBLE.

ARCH. STAMP  
**JOYCE REID TROOST ARCHITECTURE**  
116 PRYDE MULTI FAMILY  
NANAIMO, BC

CLIENT  
BC 1392056

REV. DATE	NUMBER	DESCRIPTION
2023-08-10	01	ISSUE FOR PERMIT
2023-08-10	02	ISSUE FOR PERMIT
2023-08-10	03	ISSUE FOR PERMIT
2023-08-10	04	ISSUE FOR PERMIT
2023-08-10	05	ISSUE FOR PERMIT
2023-08-10	06	ISSUE FOR PERMIT
2023-08-10	07	ISSUE FOR PERMIT
2023-08-10	08	ISSUE FOR PERMIT
2023-08-10	09	ISSUE FOR PERMIT
2023-08-10	10	ISSUE FOR PERMIT
2023-08-10	11	ISSUE FOR PERMIT
2023-08-10	12	ISSUE FOR PERMIT
2023-08-10	13	ISSUE FOR PERMIT
2023-08-10	14	ISSUE FOR PERMIT
2023-08-10	15	ISSUE FOR PERMIT
2023-08-10	16	ISSUE FOR PERMIT

DATE: OCT 11, 2023  
SCALE:  
**RECEIVED**  
**DP1342**  
**2024-AUG-19**  
Current Planning  
DRAWN BY: JRT  
SITE PLAN  
**A100**