

ATTACHMENT B FLOOR PLAN

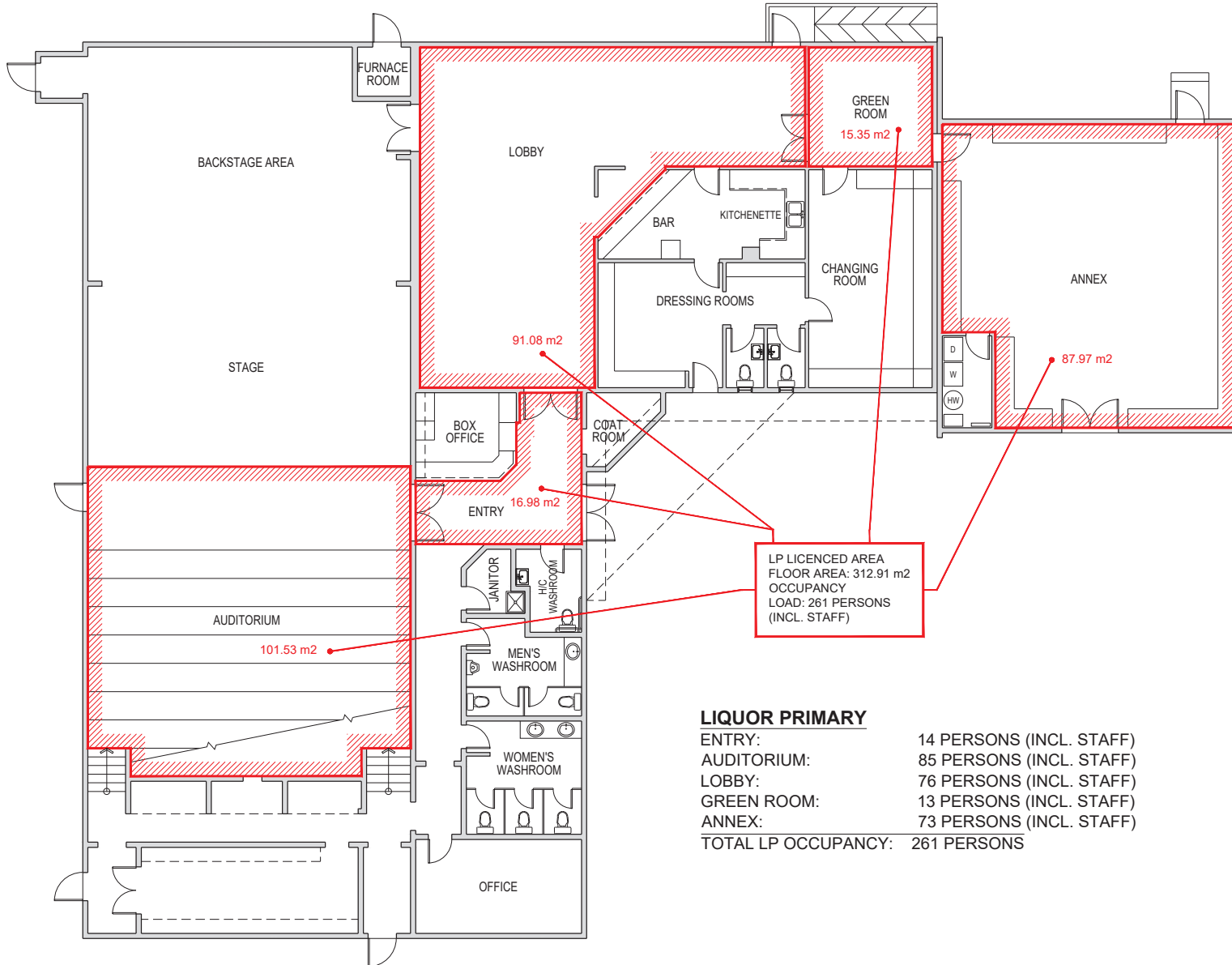

LP LICENCED AREA
FLOOR AREA: 312.91 m2
OCCUPANCY
LOAD: 261 PERSONS
(INCL. STAFF)

LIQUOR PRIMARY

ENTRY:	14 PERSONS (INCL. STAFF)
AUDITORIUM:	85 PERSONS (INCL. STAFF)
LOBBY:	76 PERSONS (INCL. STAFF)
GREEN ROOM:	13 PERSONS (INCL. STAFF)
ANNEX:	73 PERSONS (INCL. STAFF)
TOTAL LP OCCUPANCY:	261 PERSONS

NOTES

CONTRACTOR SHALL CHECK ALL DIMENSIONS ON THE WORK AND REPORT ANY DISCREPANCY TO THE ARCHITECT BEFORE PROCEEDING.
ALL DRAWINGS AND SPECIFICATIONS ARE THE PROPERTY OF THE ARCHITECT AND MUST BE RETURNED AT THE COMPLETION OF THE WORK.
THIS DRAWING IS NOT TO BE USED FOR CONSTRUCTION UNITS SIGNED BY THE ARCHITECT.
DO NOT SCALE FROM THESE DRAWINGS.

NO.	REVISION	DATE
1.	REVISED LICENCE AREA CALCULATIONS	AUG 22, 2024

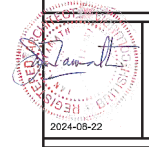

ARCHITECT
ian a. niamath
a.i.b.c.
151 SKINNER STREET, NANAIMO, B.C.
CELL: 250 758 8786 EMAIL: niamath@iaw.ca

PROJECT
NANAIMO THEATRE GROUP BLDG
2373 ROSSTOWN ROAD
NANAIMO, BC

SHEET TITLE
FLOOR PLAN W/ LICENCED AREAS
RECEIVED
LA156
2024-AUG-22
Current Planning

SCALE	DATE
3/32"=1'-0"	AUG 22, 2024
DRAWN	CHECKED
EK	

DRAWING NO.
A1.0 R1