

# ATTACHMENT D PROPOSED PUBLICLY ACCESSIBLE OPEN SPACE

- 128,621 sqf Public Area (including street plazas, school outdoor area, playground, daycare open space, internal pedestrian path connections, planting areas, garden restoration areas, water management retention zones and gathering building including concession patios)
- 30,606 sqf Private Area (BC Housing outdoor space and unit patios)
- 18,553 sqf Road Dedication

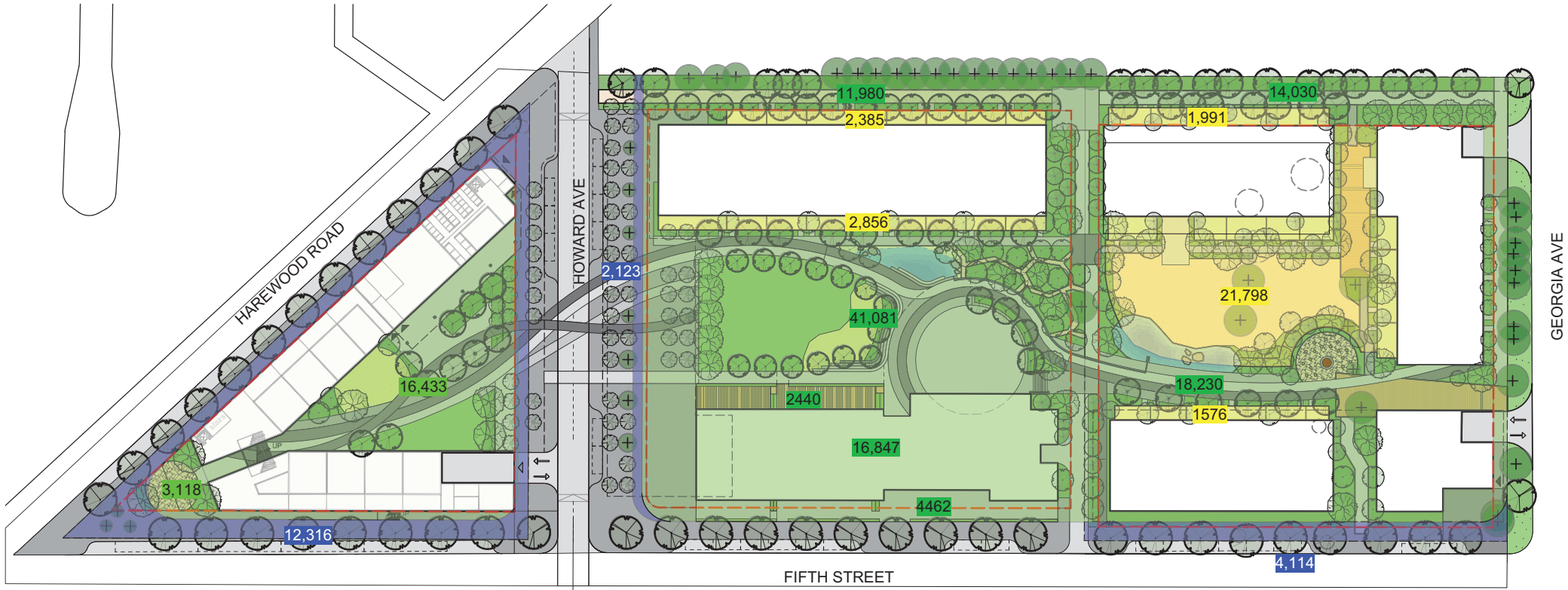

## Te'tuxwtun | Landscape Concept Plan

RECEIVED  
RA493  
2023-JUL-21  
Current Planning

**LADR LANDSCAPE ARCHITECTS**

Project No: 2035 Aug 18-22 #3-864 Queens Ave. Victoria B.C. V8T1M5  
Phone: (250) 598-0105