

ATTACHMENT G LANDSCAPE PLAN AND DETAILS

Page 1 of 5

LAYOUT LEGEND

ABBREVIATIONS	DESCRIPTION
(E)	EXISTING
E	PROPERTY LINE
TYP.	TYPICAL
ROW	RIGHT-OF-WAY
SYMBOL	DESCRIPTION
	PROPERTY LINE
	BROOM FINISH CONCRETE
	CUSTOM BENCH
	2-4 STALL BIKE RACK
	7-STALL BIKE RACK
	CABLE GUARDRAIL
	TIMBER BENCH
	COLOUR CONCRETE
	DRIFTWOOD
	BOULDER
	LANDSCAPING BOULDER
	DRIFTWOOD ACCENT

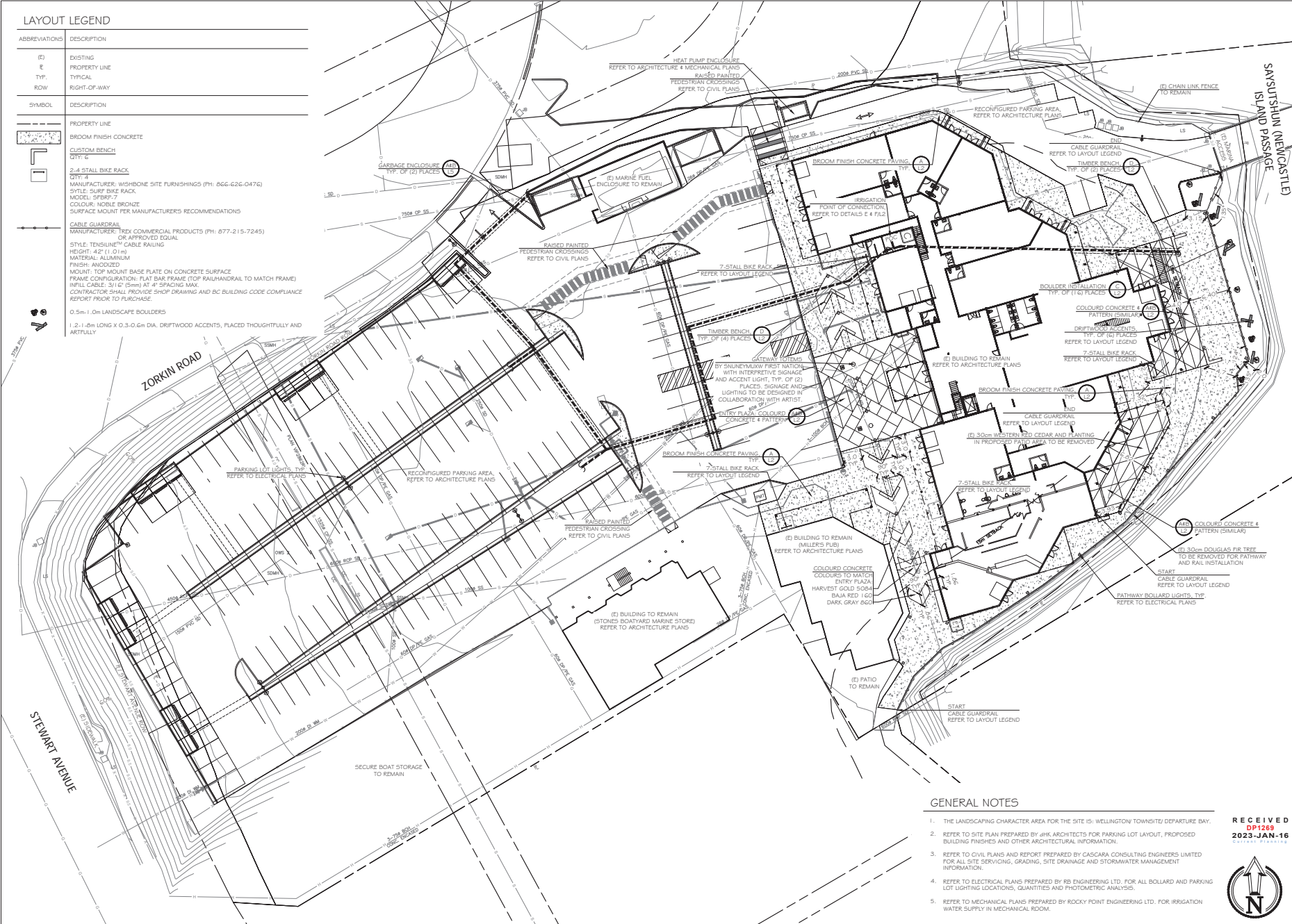

GENERAL NOTES

1. THE LANDSCAPING CHARACTER AREA FOR THE SITE IS: WELLINGTON TOWNSITE/DEPARTURE BAY.
2. REFER TO SITE PLAN PREPARED BY JHK ARCHITECTS FOR PARKING LOT LAYOUT, PROPOSED BUILDING FINISHES AND OTHER ARCHITECTURAL INFORMATION.
3. REFER TO CIVIL PLANS AND REPORT PREPARED BY CASCARA CONSULTING ENGINEERS LIMITED FOR ALL SITE SERVING, GRADING, SITE DRAINAGE AND STORMWATER MANAGEMENT INFORMATION.
4. REFER TO ELECTRICAL PLANS PREPARED BY RB ENGINEERING LTD. FOR ALL BOLLARD AND PARKING LOT LIGHTING LOCATIONS, QUANTITIES AND PHOTOMETRIC ANALYSIS.
5. REFER TO MECHANICAL PLANS PREPARED BY ROCKY POINT ENGINEERING LTD. FOR IRRIGATION WATER SUPPLY IN MECHANICAL ROOM.

RECEIVED
DP1289
2023-JAN-16
CITY OF VICTORIA



THIS DRAWING IS NOT FINAL AND SHALL NOT BE USED FOR CONSTRUCTION WORK UNLESS IT HAS BEEN STAMPED AND SIGNED BY THE LANDSCAPE ARCHITECT. THE COPYRIGHT TO ALL DESIGN AND DRAWINGS ARE THE PROPERTY OF MACDONALD GRAY ARCHITECTS INC. NO PART OF THIS DRAWING OR ANY PART THEREOF SHALL BE REPRODUCED OR TRANSMITTED IN ANY FORM OR BY ANY MEANS, ELECTRONIC OR MECHANICAL, INCLUDING PHOTOCOPYING, RECORDING, OR BY ANY INFORMATION STORAGE AND RETRIEVAL SYSTEM, WITHOUT PERMISSION IN WRITING FROM MACDONALD GRAY ARCHITECTS INC.

1840 Stewart Avenue
Petroglyph Development Group
Nanaimo, BC

LANDSCAPE ARCHITECTURE SITE & IRRIGATION PLAN	
Date:	December 21, 2022
Drawn:	CM
Checked:	CM
Scale:	1:250 metric
Project #:	22-0318 CITY 09001269/ENG
Drawing Number:	L1 of 5

#	Date	Notes
1	17MAY2022	DP/PP Coordination
2	18MAY2022	Revised for DP
3	21SEP2022	Revised for DP
4	06OCT2022	DP Coordination
5	12OCT2022	Revised for DP
6	19OCT2022	Revised for DP
7	20OCT2022	Issued for DP
8	21DEC2022	Revised for DP

IRRIGATION EQUIPMENT LEGEND

SYMBOL	MANUFACTURER	MODEL	DESCRIPTION
	HUNTER	IC-600-FLUX	XX-STATION (STATIONS TBD BY IRRIGATION CONTRACTOR) MODULAR IRRIGATION CONTROLLER MOUNTED IN MECHANICAL ROOM IN PLASTIC CABINET CW
	HUNTER	W55-SEN ROOM-XL	(1) WIRELESS SOLAR-SYNCH SENSOR AND (1) REMOTE CONTROL KIT PER CONTROLLER INSTALL PER MANUFACTURER'S RECOMMENDATIONS, REFER TO DETAIL 6A2
	PER MECHANICAL	PER MECHANICAL	BACKFLOW PREVENTER, REFER TO MECHANICAL PLANS
	HUNTER	ICV-151G	1.5" (38mm) MASTER VALVE TO BE INSTALLED DOWNSTREAM OF BACKFLOW PREVENTER PER MANUFACTURER'S RECOMMENDATIONS AND DETAIL E 4 FL2
	HUNTER	HPS-FC2-150	1.5" (38mm) FLOW SENSOR TO BE INSTALLED DOWNSTREAM OF MASTER VALVE PER MANUFACTURER'S RECOMMENDATIONS AND DETAIL E 4 FL2
	HUNTER	CLASS 200	PVC LATERAL LINES, REFER TO DETAIL C4S
	HUNTER	SCHEDULE 40	1.5" (38mm) PVC MAINLINE, REFER TO DETAIL C4S
	HUNTER	SCHEDULE 40	PVC SLEEVES UNDER ALL PAVING MIN. TYP. MAINLINE & CONTROL WIRE, 150mm (6") LATERALS: 100mm (4") BURIAL DEPTH TO MATCH DEPTH OF CARRIED PIPE, REFER TO DETAIL C4S

IRRIGATION NOTES

1. THE IRRIGATION SYSTEM LATERAL LINES, REMOTE CONTROL VALVES, EMISSION DEVICES AND APPURTENANCES SHALL BE DESIGN-BUILD BY THE IRRIGATION CONTRACTOR. ALL IRRIGATION EMISSION DEVICES SHALL BE MATCHED PRECIPITATION RATE LOW VOLUME ROTARY OR SPRAY NOZZLES OR DRIP EQUIPMENT. OVERHEAD MICROSPRAY DEVICES ARE NOT PERMITTED. LAWN AND SHRUBS SHALL BE ON SEPARATE IRRIGATION CONTROL ZONES. ZONES SHALL BE DESIGNED TO SEPARATE NORTH & EAST AND SOUTH & WEST FACING LANDSCAPE AREAS WHEREVER PRACTICAL.
2. ALL CONTROL EQUIPMENT MAKES AND MODELS AND PIPING SHALL BE PER THE IRRIGATION LEGEND OR APPROVED EQUAL. CONTACT THE LANDSCAPE ARCHITECT IN WRITING PRIOR TO PURCHASE FOR SUBSTITUTIONS.
3. IRRIGATION SYSTEM INSTALLATION AND MAINTENANCE SHALL MEET OR EXCEED THE REQUIREMENTS SET OUT IN SECTION 5 - IRRIGATION SYSTEMS OF THE CANADIAN NURSERY LANDSCAPE ASSOCIATION (CNLA) / CANADIAN SOCIETY OF LANDSCAPE ARCHITECTS (CSLA) CANADIAN LANDSCAPE STANDARD PER THE PROJECT SPECIFICATIONS AND DETAILS.
4. THE IRRIGATION SYSTEM IS DESIGNED TO OPERATE WITH A MINIMUM STATIC PRESSURE OF 50 PSI AFTER THE BACKFLOW PREVENTER. THE MINIMUM FLOW DEMAND FOR THE SYSTEM TO OPERATE THE FLOW SENSOR IS 5 GPM. THE MAXIMUM FLOW DEMAND FOR THE SYSTEM IS 30 GPM.
5. THE IRRIGATION PLAN IS DIAGRAMMATIC. NO IRRIGATION MAINLINE OR LATERAL LINE SHALL BE INSTALLED BEYOND ANY KNOWN LIMIT OF WORK, PROPERTY LINE OR ROAD RIGHT-OF-WAY. ALL EQUIPMENT AND PIPING SHALL BE INSTALLED WITHIN PLANTING BEDS OR THROUGH SLEEVES UNDER PAVING.
6. THE CONTRACTOR SHALL ADJUST THE PLACEMENT AND RADIUS OF SPRINKLERS AS REQUIRED BY FIELD CONDITIONS TO ACHIEVE FULL COVERAGE OF ALL PLANTED AREAS AND TO MINIMIZE OVER-SPRAY ONTO ADJACENT HARD SURFACES, FENCES AND PROPERTY LINES.
7. ALL PIPING AND WIRING UNDER PAVING SHALL BE INSTALLED IN SEPARATE PVC SLEEVES AT A MINIMUM DEPTH OF 600mm WITH 150mm OF SAND BACKFILL ABOVE AND BELOW PIPE. ALL SLEEVES SHALL BE INSTALLED PRIOR TO PAVEMENT INSTALLATION AND SHALL EXTEND 150mm BEYOND EDGE OF PAVEMENT OR CURB. BACKFILL FOR SLEEVES SHALL BE COMPACTED TO THE SPECIFIED DENSITY FOR THE SUBGRADE. REFER TO CIVIL PLANS FOR ADDITIONAL INFORMATION.
8. OPERATE IRRIGATION CONTROLLERS WITHIN THE CITY OF NANAIMO WATER RESTRICTION SCHEDULE.
9. THE CONTRACTOR SHALL PROVIDE AND INSTALL THE AUTOMATIC CONTROLLERS AND ALL CONTROL WIRE. THE ELECTRICAL CONTRACTOR SHALL PROVIDE THE ELECTRICAL SERVICES AND SERVICE HOOK-UPS FROM THE POWER SOURCE TO THE AUTOMATIC CONTROLLERS.
10. THE CONTRACTOR SHALL BE RESPONSIBLE FOR REPAIRING OR REPLACING ALL EXISTING SPRINKLER EQUIPMENT OR PROPERTY TO REMAIN DAMAGED BY CONSTRUCTION OPERATIONS.
11. THE CONTRACTOR SHALL COORDINATE ALL WORK WITH OTHER TRADES TO ENSURE PROGRESS OF WORK IS NOT INTERRUPTED AND CAN BE COMPLETED IN A TIMELY MANNER.
12. INSTALL SPRINKLER HEADS PERPENDICULAR TO SLOPES OR GRADE.
13. THE LANDSCAPE ARCHITECT CANNOT PROVIDE ASSURANCES FOR WORK WITHOUT THE FOLLOWING FIELD REVIEW ATTENDANCE:
A. REVIEW OF UNCOVERED PRESSURIZED IRRIGATION MAINLINE AND LATERALS.
B. REVIEW OF COMPLETE IRRIGATION INSTALLATION AND COVERAGE.

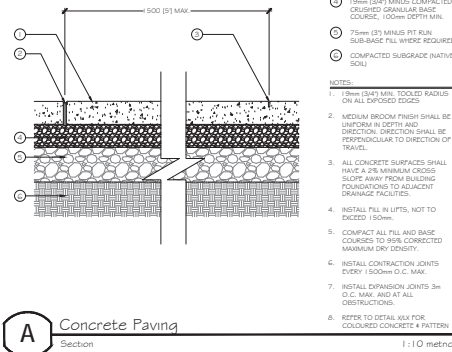
A Concrete Paving
Section

1:10 metric

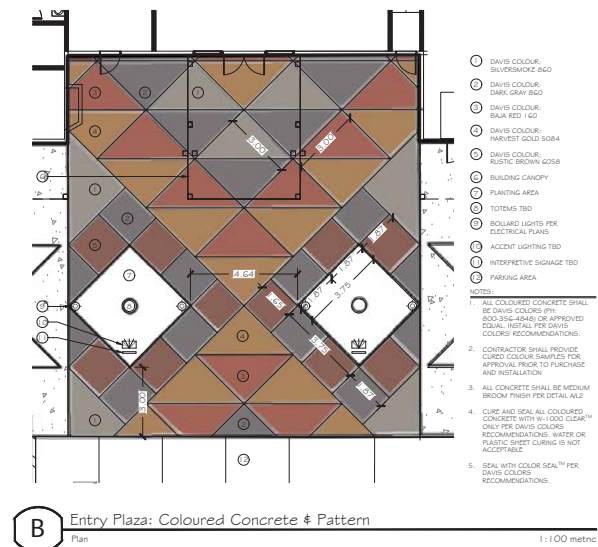
B Entry Plaza: Coloured Concrete & Pattern
Plan

1:100 metric

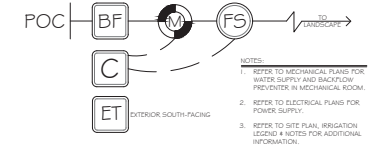
E Point of Connection
Schematic

Not To Scale

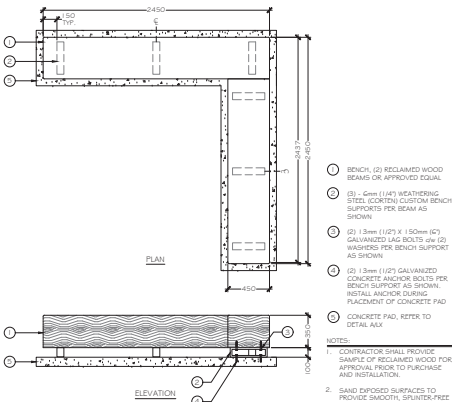
D Timber Bench
Plan/Elevation/Section

1:25 metric

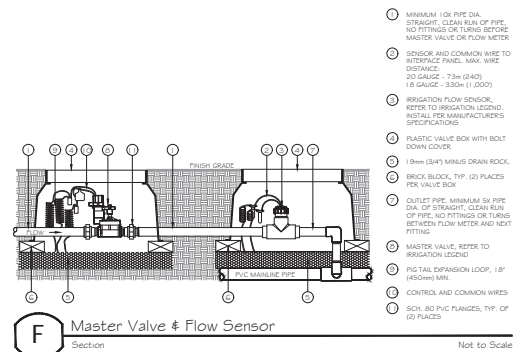
F Master Valve & Flow Sensor
Section

Not To Scale

C Boulder Installation
Section

1:20 metric

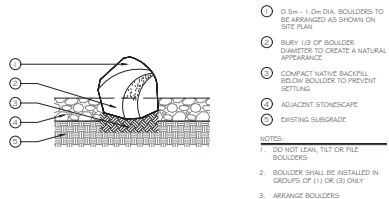

THIS DRAWING IS NOT FINAL AND SHALL NOT BE USED FOR CONSTRUCTION WORK UNLESS IT HAS BEEN STAMPED AND SIGNED BY THE LANDSCAPE ARCHITECT. THE COPYRIGHT TO ALL DESIGN AND DRAWINGS ARE THE PROPERTY OF MACDONALD GRAY LANDSCAPE ARCHITECTS. NO PART OF ANY DRAWING OTHER THAN THAT AUTHORIZED BY MACDONALD GRAY LANDSCAPE ARCHITECTS MAY BE REPRODUCED OR TRANSMITTED IN ANY FORM OR BY ANY MEANS, ELECTRONIC OR MECHANICAL, INCLUDING PHOTOCOPYING, RECORDING, OR BY ANY INFORMATION STORAGE AND RETRIEVAL SYSTEM.

1840 Stewart Avenue
Petroglyph Development Group
Nanaimo, BC

NOTES & DETAILS

Date: December 21, 2022
Drawn: CM
Checked: CM
Scale: AS NOTED
Project #: 22-0318 City: 09001249/ENG

DRAWING NUMBER: L2 of 5

#	Date	NOTES
3	17MAY2022	DP/JP Coordination
4	18MAY2022	Revised for GP
5	21SEP2022	Revised for GP
6	06OCT2022	DP Coordination
7	12OCT2022	Revised for GP
8	19OCT2022	Revised for GP
9	20OCT2022	Issued for GP
10	21DEC2022	Revised for GP

RECEIVED
DP1269
2023-JAN-16

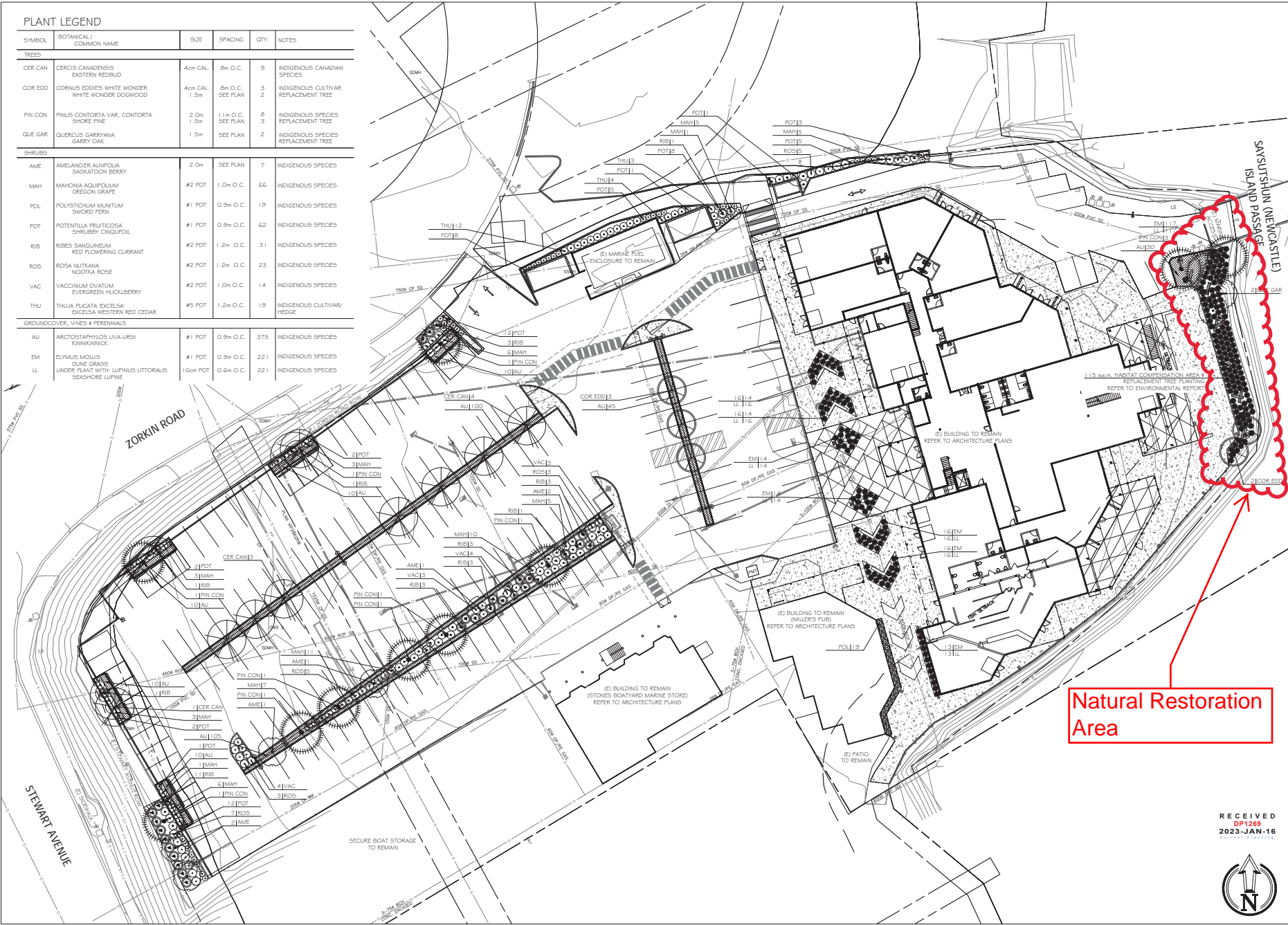

THIS DRAWING IS NOT FINAL AND SHALL NOT BE USED FOR CONSTRUCTION WORK UNLESS IT HAS BEEN STAMPED AND SIGNED BY THE LANDSCAPE ARCHITECT. THE COPYRIGHT TO ALL DESIGN AND DRAWINGS ARE THE PROPERTY OF MACDONALD GRAY. NO PART OF THIS DRAWING OR ANY PARTS THEREOF SHALL BE REPRODUCED OR TRANSMITTED IN ANY FORM OR BY ANY MEANS, ELECTRONIC OR MECHANICAL, WITHOUT PERMISSION IN WRITING FROM MACDONALD GRAY. (C) 2023 MACDONALD GRAY. ALL RIGHTS RESERVED.

1840 Stewart Avenue
Petroglyph Development Group
Nanaimo, BC

PLANTING PLAN & LEGEND	
Date:	December 21, 2022
Drawn:	CM
Checked:	CM
Scale:	1:250 metric
Project #:	22-0318 CITY 09001269/FNG
Drawing Number:	L3 of 5

REVISION SCHEDULE	
#	NOTES
3	17MAY2022 DP/JP Coordination
4	18MAY2022 Reissued for DP
5	21SEP2022 Reissued for DP
6	06OCT2022 DP Coordination
7	12OCT2022 Reissued for DP
8	19OCT2022 Reissued for DP
9	20OCT2022 Issued for DP
10	21DEC2022 Reissued for DP

RECEIVED
DP1269
2023-JAN-16



Date: December 21, 2022

Drawn:	CM

Project #: 22-0318 City: DP001269/ENG

DRAWING NUMBER: 14-E

3	17AUG2022	DP/BP Coordination
4	30AUG2022	Delivered for DP

4	18AUG2022	Released for DP
5	21SEP2022	Released for DP

6	06OCT2022	DP Coordination
---	-----------	-----------------

7	12OCT2022	Released for DP
---	-----------	-----------------

8	190C12022	Reissued for DP
9	200CT2022	Issued for BP

1. ALL LANDSCAPE INSTALLATION AND MAINTENANCE SHALL MEET OR EXCEED THE MOST RECENT STANDARDS SET OUT BY THE CANADIAN NURSERY LANDSCAPE ASSOCIATION (CNLA) CANADIAN SOCIETY OF LANDSCAPE ARCHITECTS (CSLA) CANADIAN LANDSCAPE STANDARD FOR THE PROJECT SPECIFICATIONS.
2. LANDSCAPE MAINTENANCE SHALL MEET OR EXCEED THE MINIMUM REQUIREMENTS SET OUT IN TABLE 1-1.4.2. MAINTENANCE LEVELS - LEVEL 2 GROOMED OF THE CANADIAN LANDSCAPE STANDARD PER THE PROJECT SPECIFICATIONS.
3. ESTABLISHMENT MAINTENANCE SHALL MEET THE REQUIREMENTS SET OUT IN SECTION 13 ESTABLISHMENT MAINTENANCE OF THE CANADIAN LANDSCAPE STANDARD PER THE PROJECT SPECIFICATIONS. ALL PROPOSED PLANT MATERIAL SHALL BE MAINTAINED BY THE CONTRACTOR FOR THE ONE YEAR MAINTENANCE PERIOD FROM THE TIME OF SUBSTANTIAL COMPLETION TO ENSURE PLANT ESTABLISHMENT AND TO MAINTAIN PLANT VIGOR.
4. THE IRRIGATION SYSTEM SHALL BE OPERATIONAL AND COVERAGE APPROVED BY THE LANDSCAPE ARCHITECT PRIOR TO THE INSTALLATION OF PLANT MATERIAL.
5. PLANT QUANTITIES ARE FOR INFORMATION ONLY. IN CASE OF ANY DISCREPANCY THE PLAN SHALL GOVERN.
6. PROVIDE MINIMUM SLOPE OF 2% FOR DRAINAGE IN ALL PLANTED AREAS.
7. THE FINISHED GRADE OF ALL PLANTERS SHALL BE 75mm BELOW THE TOP OF CURB OR ADJACENT HARDCAPE.
8. ALL PLANT MATERIAL SHALL MATCH SPECIES AS INDICATED ON THE PLANT LEGEND, PLANT MATERIAL QUALITY, TRANSPORT AND HANDLING SHALL COMPLY WITH CANADIAN STANDARDS FOR NURSERY STOCK.
9. THE CONTRACTOR SHALL SECURE PLANT MATERIAL AS SPECIFIED AT LEAST 2 WEEKS PRIOR TO ANTICIPATED PLANTING TIME. CONTACT THE LANDSCAPE ARCHITECT FOR APPROVAL OF ANY SUBSTITUTIONS. NO SUBSTITUTIONS WILL BE ACCEPTED WITHOUT PRIOR WRITTEN APPROVAL OF THE LANDSCAPE ARCHITECT.
10. TREE LOCATIONS SHALL BE FIELD STAKED AND LOCATIONS APPROVED BY THE LANDSCAPE ARCHITECT PRIOR TO PLANTING. TREE LOCATIONS MAY BE ADJUSTED IN THE FIELD TO SUIT THE SITE REQUIREMENTS AS DIRECTED BY THE LANDSCAPE ARCHITECT.
11. CHECK FOR LOCATIONS OF WATER LINES AND OTHER UNDERGROUND SERVICES PRIOR TO DIGGING PLANTINGS. EXCAVATED PLANT PITS SHALL HAVE POSITIVE DRAINAGE. PLANT PITS WHEN FULLY FLOODED WITH WATER SHALL DRAIN WITHIN ONE HOUR AFTER FILLING.
12. INSPECT ALL ASSEMBLED PLANT MATERIAL AT THE NURSERY PRIOR TO SHIPPING. PLANT MATERIAL SHALL BE INSPECTED BY THE LANDSCAPE ARCHITECT ON-SITE PRIOR TO PLANTING. NO PLANTS REQUIRING PRUNING OF MAJOR BRANCHES DUE TO DISEASE, DAMAGE OR POOR FORM WILL BE ACCEPTED.
13. REFER TO PLANT LEGEND, PROJECT SPECIFICATIONS AND DETAILS FOR ADDITIONAL INFORMATION.
14. THE LANDSCAPE ARCHITECT CANNOT PROVIDE ASSURANCES FOR WORK WITHOUT THE FOLLOWING FIELD REVIEW ATTENDANCE:
 - A. REVIEW OF SUBGRADE PRIOR TO GROWING MEDIA INSTALLATION.
 - B. REVIEW OF TREE LOCATIONS (STAKED).
 - C. REVIEW OF PLANT MATERIAL PRIOR TO INSTALLATION.
 - D. REVIEW OF SOIL SAMPLE ANALYSIS.
 - E. REVIEW OF INSTALLED PLANT MATERIAL.

15. PROPERTIES FOR GROWING MEDIUM SHALL MEET OR EXCEED SPECIFICATION SECTION 3291.1.3 SOIL PREPARATION FOR LEVEL 2 GROWNED AREAS:
 - (a) GROWING MEDIUM TYPES: 2P (PLANTING AREAS)
 - (b) SHURDLY: 40cm (16")
 - (c) BEACH GRASS & GROUNDCOVER: .300mm (1/8")
 - (d) TREES IN OPEN SPACE: .600mm (2/4") BELOW AND AROUND ROOTBALL
16. ON-SITE TOPSOIL MAY BE STRIPPED, STOCKPILED AND AMENDED TO MEET THE STANDARDS ABOVE.
 - (a) SUBMIT A (4) LITRE SAMPLE OF SCREENED TOPSOIL, PROPOSED FOR USE AS A BASIS FOR GROWING MEDIUM TO A SOIL LAB AS APPROVED BY THE LANDSCAPE ARCHITECT. SOIL TESTING SHALL BE AT THE CONTRACTORS EXPENSE.
17. INDICATE TO THE SOIL LAB THAT THE PURPOSE OF THE ANALYSIS AND AMENDMENT RECOMMENDATIONS IS FOR 2P - FL AREA.
18. AMENDMENT RECOMMENDATIONS BY THE SOIL ANALYSIS LAB SHALL BE THE BASIS FOR ACCEPTANCE OF THE GROWING ROOT RETENTION EVIDENCE OF ALL AMENDMENTS ADDED TO THE TOPSOIL.
19. MULCH SHALL BE COMPOST, REFER TO SPECIFICATIONS.
20. MULCH DEPTH SHALL BE 75mm MINIMUM.

A detailed diagram of a tree with its parts labeled with circled numbers 1 through 10. The labels point to the following parts: 1. Flower, 2. Fruit, 3. Branch, 4. Stem, 5. Root, 6. Bark, 7. Cambium, 8. Xylem, 9. Phloem, 10. Pith.

Section

Not to Scale

B

Not to Scale

Section

Not to Scale

Drawn:	CM

Project #: 22-0318 City: DP001269/ENG

DRAWING NUMBER: 14-E

3	17AUG2022	DP/BP Coordination
4	30AUG2022	Delivered for DP

4	18 AUG 2022	Released for DP
5	21 SEP 2022	Released for DP

6	06OCT2022	DP Coordination
---	-----------	-----------------

7	12OCT2022	Released for DP
---	-----------	-----------------

8	190C12022	Reissued for DP
9	200CT2022	Issued for BP

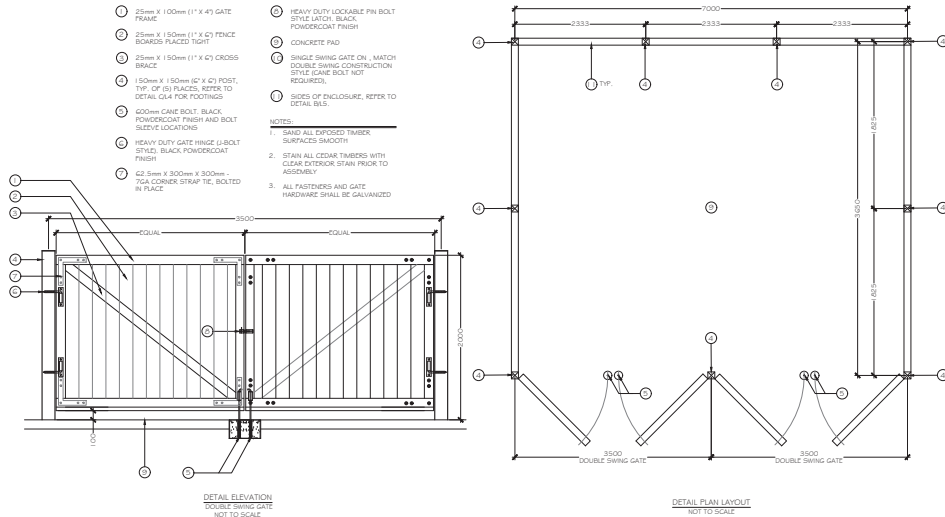

A Garbage Enclosure
Plan Elevation
Not to Scale

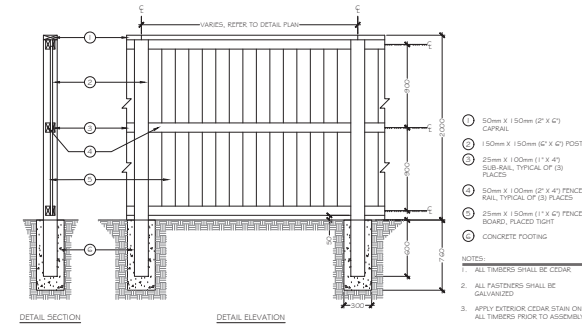

B 2.0m Trash Enclosure Surround
Detail Section
1:25 metric

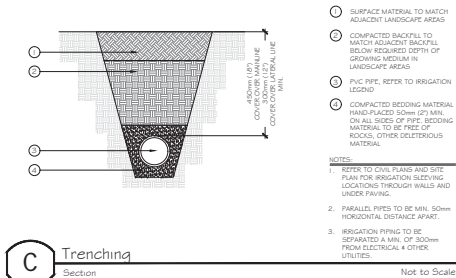

C Trenching
Section
Not to Scale

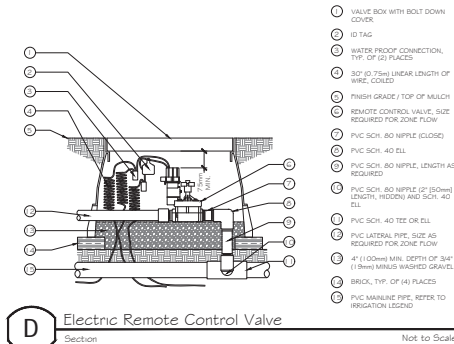

D Electric Remote Control Valve
Section
Not to Scale

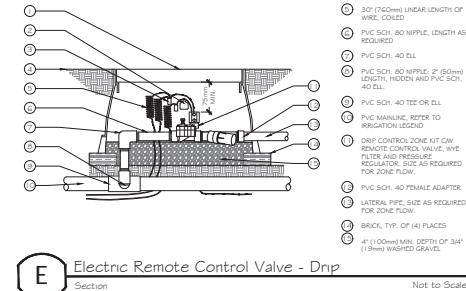

E Electric Remote Control Valve - Dnp
Section
Not to Scale

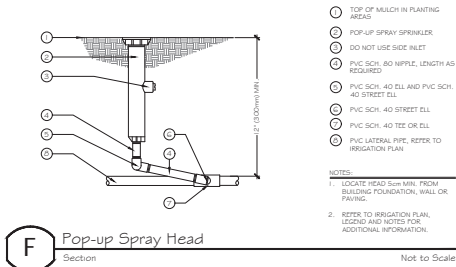

F Pop-up Spray Head
Section
Not to Scale



THIS DRAWING IS NOT FINAL AND SHALL NOT BE USED FOR CONSTRUCTION WORK UNLESS IT HAS BEEN STAMPED AND SIGNED BY THE LANDSCAPE ARCHITECT. THE COPYRIGHT TO ALL DESIGN AND DRAWINGS ARE THE PROPERTY OF MACDONALD GRAY. THESE RIGHTS ARE RESERVED FOR THE USE OF ANY FURTHER OTHER THAN THAT AUTHORIZED BY MACDONALD GRAY. (C) 2018 MACDONALD GRAY

1840 Stewart Avenue
Petroglyph Development Group
Nanaimo, BC

DETAILS	
Date:	December 21, 2022
Drawn:	CM
Checked:	CM
Scale:	AS NOTED
Project #:	22-0318, CITY: 19001249/ENG
DRAWING NUMBER:	L5 of 5

REVISION SCHEDULE	
#	NOTES
1	Date: 17MAY2022 DP/JP Coordination
2	17MAY2022 DP/JP Coordination
3	17MAY2022 DP/JP Coordination
4	17MAY2022 DP/JP Coordination
5	21SEP2022 DP/JP Coordination
6	06OCT2022 DP/JP Coordination
7	12OCT2022 DP/JP Coordination
8	12OCT2022 DP/JP Coordination
9	20OCT2022 DP/JP Coordination
10	21DEC2022 DP/JP Coordination

RECEIVED
DP1269
2023-JAN-16
Landscape Architecture