

ATTACHMENT C SITE AND PARKING PLAN

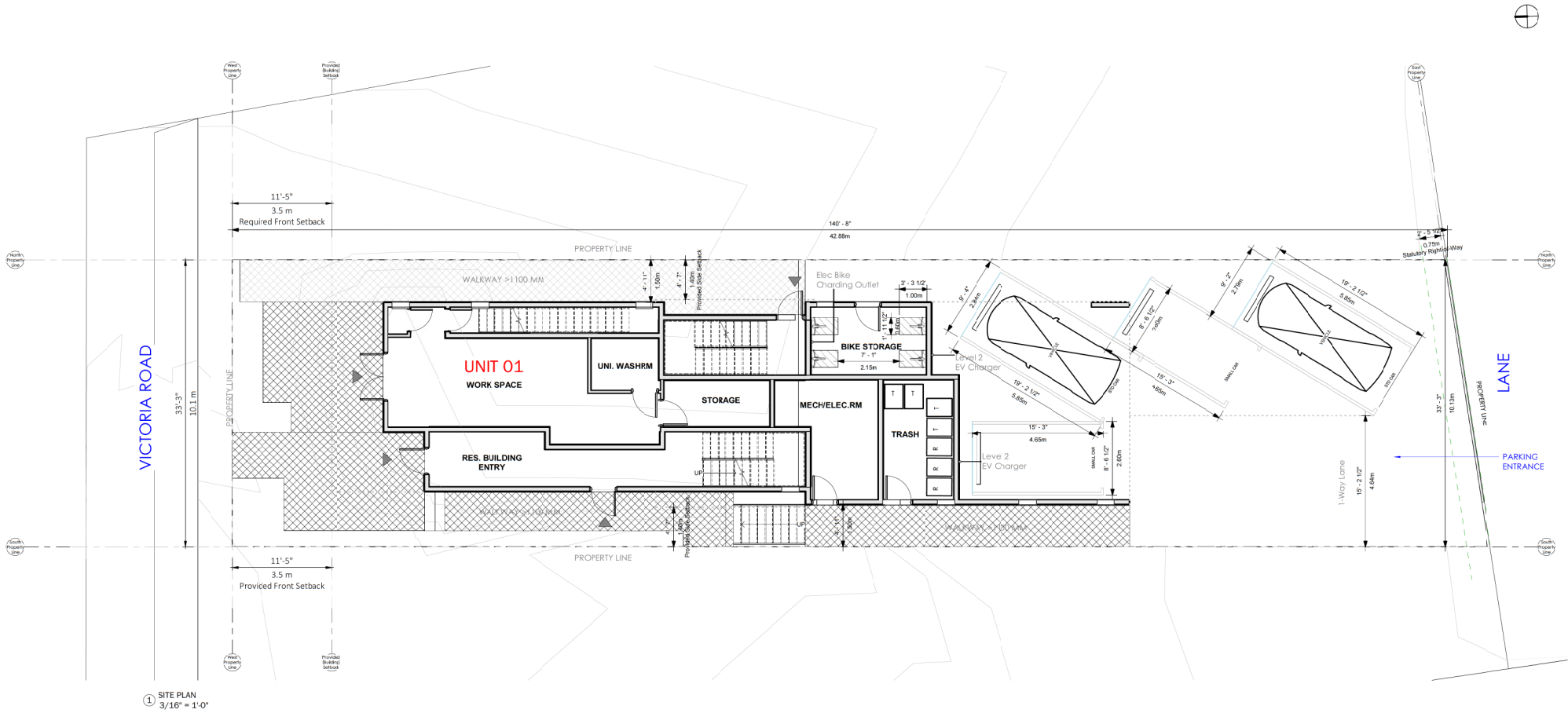

RECEIVED
DP1257
2022-DEC-12
CLIFFORD PARSONS

JOYCE REID TROOST ARCHITECTURE
2515 GLENAYR DRIVE
NANAIMO, BC V9S 3R9
joyce@jrtarchitecture.ca
250.714.8749
jrtarchitecture.com

THE DRAWINGS, DESIGN IDEAS AND
REMARKS OF CONSTRUCTION SPECIFIED
HEREIN ARE THE EXCLUSIVE PROPERTY OF
JOYCE REID TROOST ARCHITECTURE. ALL
CONTRACT-COPY AND PROPERTY RIGHTS
ARE RESERVED. REPRODUCING THESE AREAS
TO BE REPRODUCED. COPIES, REPRODUCED,
OR FOR ANY PURPOSES ARE
PROHIBITED. IT IS THE RESPONSIBILITY OF THE USER
TO OBTAIN NECESSARY PERMITS AND
CONSENTS FROM ALL APPLICABLE AGENCIES
BEFORE ANY CONSTRUCTION OF THESE PLANS BY A THIRD PARTY. THE
USER SHALL BE RESPONSIBLE FOR OBTAINING
NECESSARY PERMITS AND CONSENTS.
REID TROOST ARCHITECTURE RESPONSIBLE



VICTORIA FOURPLEX
223 VICTORIA ROAD
NANAIMO, BC

CLIENT: SUN PORCH HOMES LTD.

REV. DATE	NUMBER	DESCRIPTION
21-0-04	1	Coord Set 01
22-0-24	2	Revision 2
22-08-24	3	CL Updates

DATE	NOV 15, 2021	SITE PLAN	
SCALE	3/16" = 1'-0"		
DRAWN BY	DL	CHECKED BY	JRT

A100