

ATTACHMENT F PROPOSED LANDSCAPE PLANS

1 of 2

1213 Princess Royal Avenue

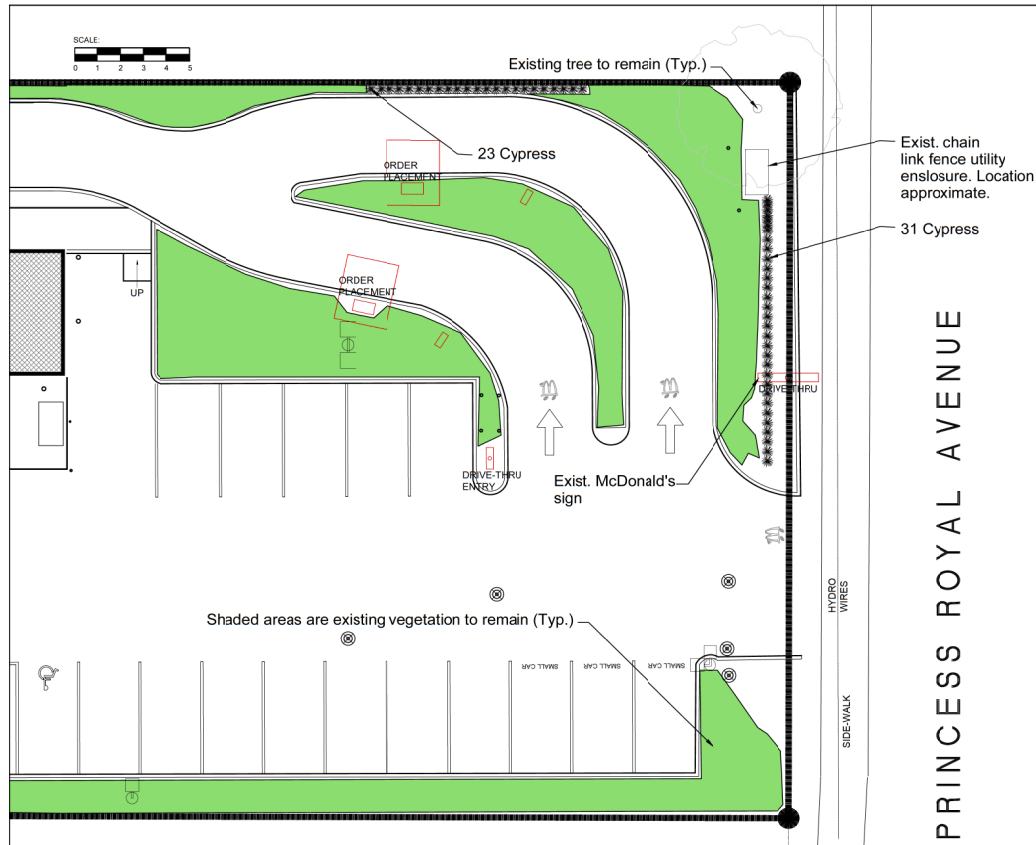

PLANTING NOTES

GENERAL PLANTING NOTES:

- ALL LANDSCAPE WORK TO BE PER THE CANADIAN LANDSCAPE STANDARD (CLS) LATEST EDITION.
- ENSURE AVAILABILITY AND SOURCE OF PLANT LIST MATERIALS AT LEAST 2 WEEKS PRIOR TO ANTICIPATED PLANTING TIME.
- ALL LANDSCAPE WORK MUST BE CARRIED OUT DURING FAVOURABLE WEATHER CONDITIONS AND MUST BE PURSUED TO COMPLETION AS QUICKLY AS POSSIBLE.
- CHECK FOR LOCATIONS OF WATER LINES AND ANY OTHER U/G SERVICES PRIOR TO DIGGING.
- NO PLANTS REQUIRING PRUNING OF MAJOR BRANCHES DUE TO DISEASE, DAMAGE OR POOR FORM WILL BE ACCEPTED.
- ALL CALIPER STOCK TREES SHALL BE B&B IN WIRE BASKETS OR IN CONTAINERS. BAG-GROWN TREES WILL NOT BE ACCEPTED.
- INSPECT ALL ASSEMBLED PLANT MATERIAL UPON ARRIVAL ON SITE, PRIOR TO INSTALLATION.
- GROWING MEDIUM IS TO BE AS FOLLOWS:
 - GROWING MEDIUM FOR PLANTING AREAS SHALL MEET CLS - "PLANTING AREA GROWING MEDIUM - LEVEL 1 WELL GROOMED".
- ALL PLANTING AREAS ARE TO RECEIVE 75mm HEM/FIR MULCH.
- OBTAIN WRITTEN APPROVAL FROM THE LANDSCAPE ARCHITECT PRIOR TO MAKING ANY SUBSTITUTIONS OR VARIATIONS FROM THE PLAN. UNAPPROVED SUBSTITUTIONS WILL BE REJECTED.
- LAY OUT THE PLANTS FOR APPROVAL BY THE LANDSCAPE ARCHITECT PRIOR TO INSTALLATION.

MULCH NOTES:

- HEM/FIR BARK MULCH DEPTH SHALL BE 75mm (3") AFTER SETTLING.
- TO BE NATURALLY DARK BROWN BARK MULCH AND FREE OF WOOD STICKS, STONES, ROOTS, WEEDS, WEED SEEDS, AND OTHER DELETERIOUS MATERIAL.

MAINTENANCE AND MISC. NOTES:

- MAINTAIN HEDGE HEIGHT TO BELOW THE BOTTOM OF THE EXISTING McDONALD'S SIGN.
- REINSTATE THE IRRIGATION SYSTEM.
- MAINTAIN AND WARRANTY ALL NEW PLANTS AND PLANTING AREAS FOR 1 YEAR FOLLOWING ACCEPTANCE.
- SOME EXISTING PLANTS MAY NEED TO BE REMOVED TO MAKE ROOM FOR THE PROPOSED PLANTS ON THIS PLAN.

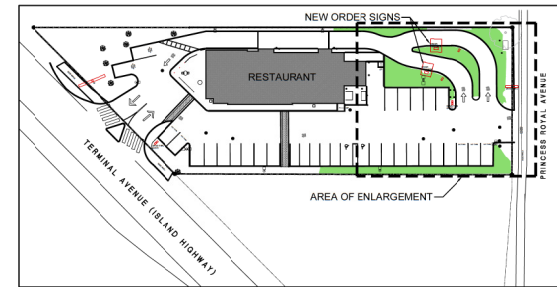

KEY PLAN (NTS)

PLANT LIST

PROPOSED TREES:

Qty	Botanical Name	Common Name	Size	Spacing
54	Cupressus x 'Leylandii'	Leyland Cypress	2m tall	Per Plan

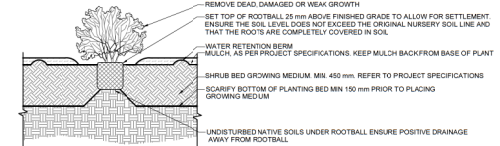

Planting Detail (NTS)

LANARC

NANAIMO
405 - 256 Wallace Street, Nanaimo, BC V9R 5B3
Tel (779) 752-4600
VANCOUVER
2820 W 33RD Ave., Vancouver, BC V6N 2G5
www.lanarcconsultants.ca

3. Shifted Hedge	BL	BL	21.09.20
2. Issued for Permit	BL	BL	21.09.12
1. Preliminary Review	BL	BL	21.07.19
Issued	By	Appt.	YY MM DD

Permit-Seal

**McDonald's -1334
1213 Princess Royal Ave.
Nanaimo**

Project

Landscape Upgrade Plan

Title

21-321 As Shown
Project No. Scale

L1.01
Drawing No. Permit No. Revision

1 of 1

**RECEIVED
DVP414
2022-OCT-20
CITY OF NANAIMO**



4725 Rutherford Road



Map data ©2022 Map data ©2022 10 m

The proposed sign face the north and they are partially hidden by the hill. The proposal would be to add some additional trees to help block the proposed signs

RECEIVED
DVP00438
2022-OCT-20
 Current Planning