

ATTACHMENT B SUBJECT PROPERTY MAPS

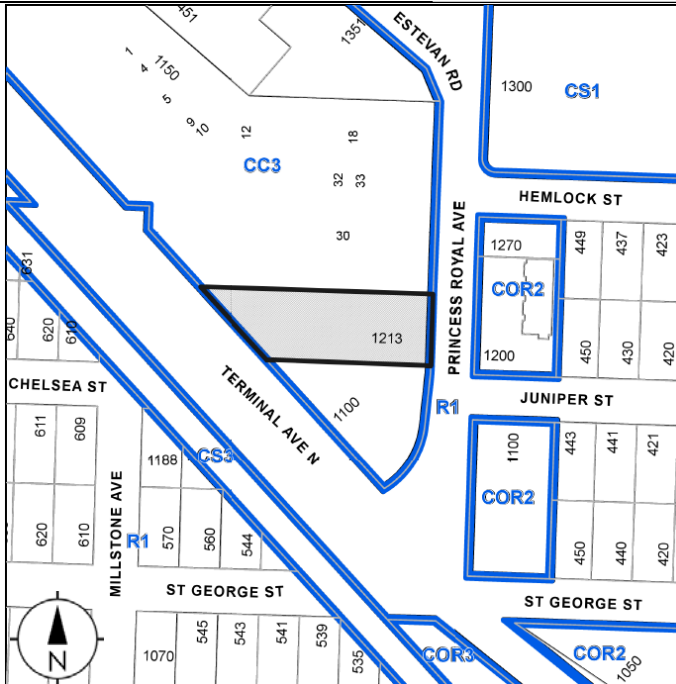

Development Variance Permit Application No. DVP00414
(1213 Princess Royal Avenue)

Legal Description:
Lot A, Section 1, Nanaimo District, Plan 22841

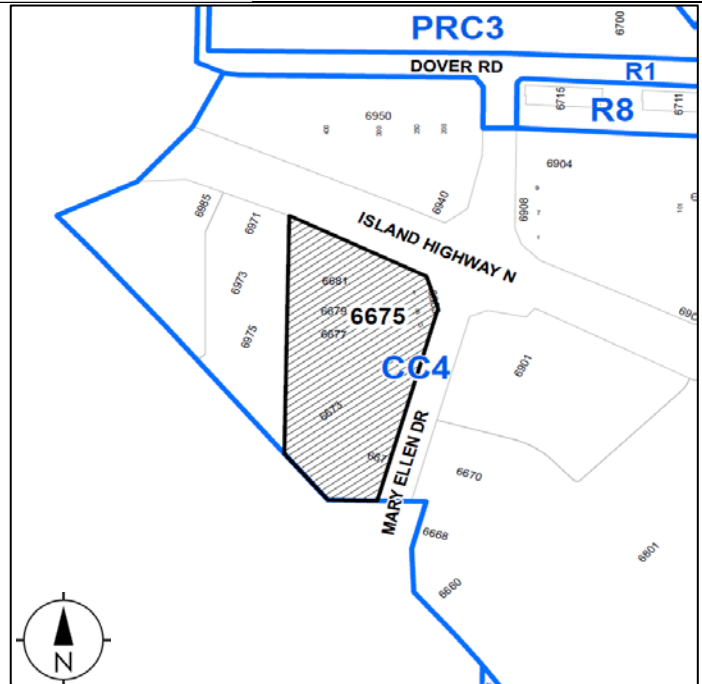

Development Variance Permit Application No. DVP00436
(6675 Mary Ellen Drive)

Legal Description:
Lot A, District Lot 26, Wellington District, Plan VI63639

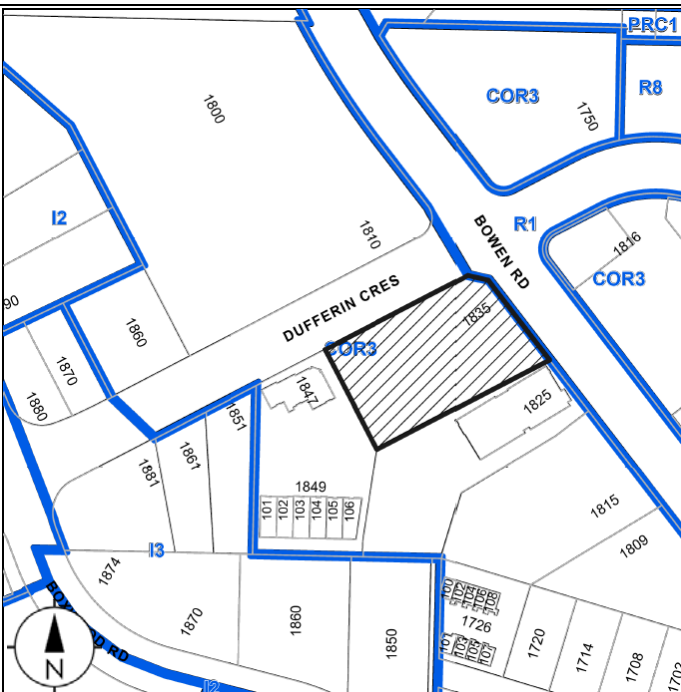

Development Variance Permit Application No. DVP00437
(1835 Bowen Road)

Legal Description:
Lot 1, Section 15, Range 8, Mountain District, Plan VIP61856

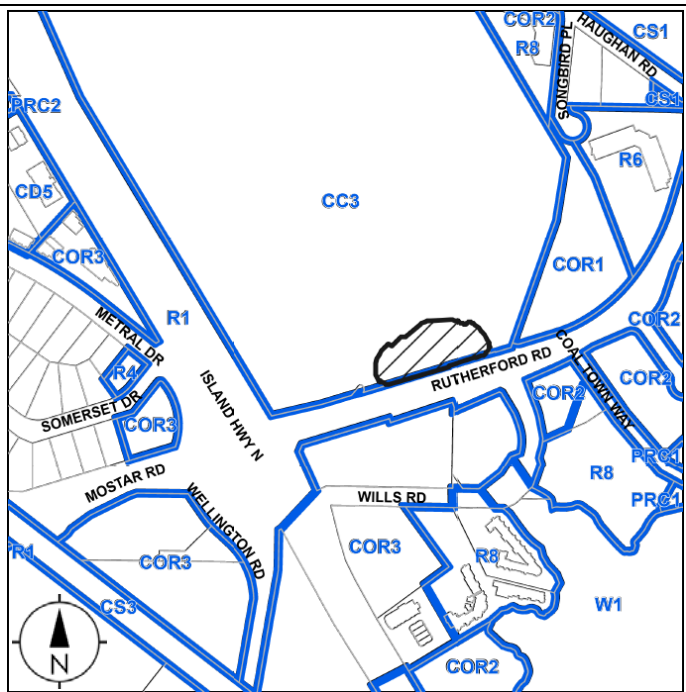

Development Variance Permit Application No. DVP00438
(4725 Rutherford Road)

Legal Description:
Lot B, District Lot 17 and Section 4, Range 4, Wellington District, Plan VIP66202

