

ATTACHMENT C SITE SURVEY

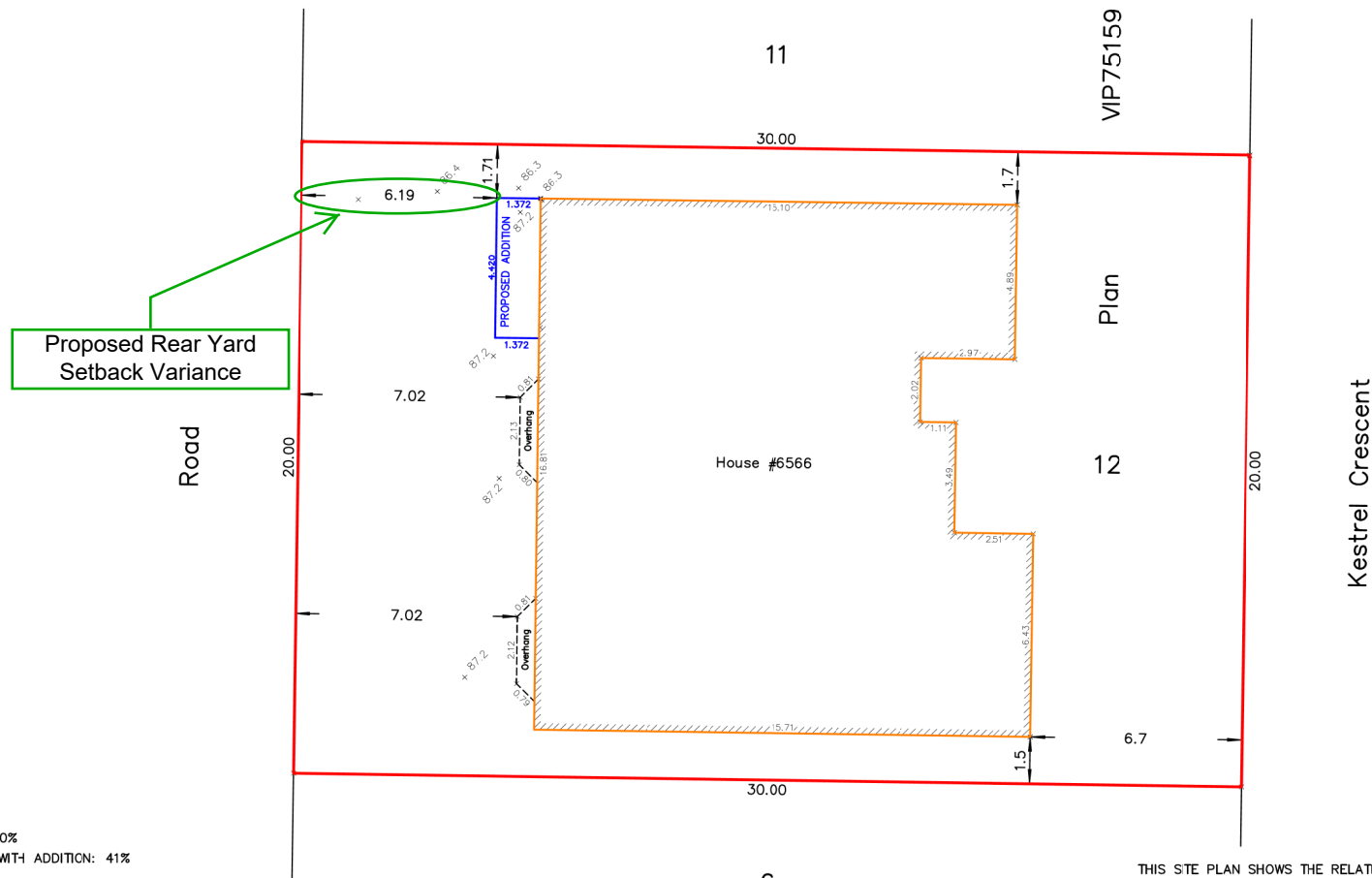

EXISTING LOT COVERAGE: 40%
PROPOSED LOT COVERAGE WITH ADDITION: 41%

NOTE:
THE REGISTERED TITLE OF THIS PROPERTY IS AFFECTED BY THE FOLLOWING LEGAL NOTATIONS AND REGISTERED CHARGES, LIENS AND INTERESTS:
M76300, EV50666, EV91164, EV94572.
THIS SITE PLAN DOES NOT VERIFY COMPLIANCE WITH THE ABOVE NOTED DOCUMENTS.

THIS SITE PLAN SHOWS THE RELATIVE LOCATION OF THE EXISTING AND PROPOSED STRUCTURES/IMPROVEMENTS WITH RESPECT TO THE BOUNDARIES OF THE DESCRIBED PARCEL ONLY.
THIS SITE PLAN SHALL NOT BE USED TO DEFINE PROPERTY LINES OR PROPERTY CORNERS.
THE SIGNATORY ACCEPTS NO RESPONSIBILITY FOR AND HEREBY DISCLAIM ALL OBLIGATIONS AND LIABILITIES FOR DAMAGES ARISING OUT OF OR IN CONNECTION WITH ANY DIRECT OR INDIRECT USE OR RELIANCE UPON THE SITE PLAN BEYOND ITS INTENDED USE.

SITE PLAN SHOWING PROPOSED ADDITION ON:
LOT 12, DISTRICT LOT 53,
WELLINGTON DISTRICT, PLAN VIP75159.

Client: ISLAND RED CEDAR CONSTRUCTION LTD. Civic Address: 6566 KESTREL CRESCENT, NANAIMO
File: 22-006 Scale: 1:150 Drawn by: DRW Property Zoning: R1

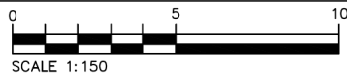

DISTANCES AND ELEVATIONS ARE IN METRES.
GEODETIC ELEVATIONS ARE DERIVED FROM
CONTROL MONUMENT 92H0732 (CVD28BC DATUM).

Certified correct this 14th day of October, 2022.

Ryan Turner
YNBxB2

Digitally signed by Ryan
Turner YNBXB2
Date: 2022.10.14 09:23:26
-07'00'

RECEIVED **Turner & Associates**
DVP439 **land surveying™**
2022-OCT-17 250.753.9778
Current Planning B.C.L.S. 435 Termini Avenue North
Nanaimo, BC V9S 4J8
www.turnersurveys.ca

(This document is not valid unless originally signed and sealed.)