

ATTACHMENT C LOCATION PLAN

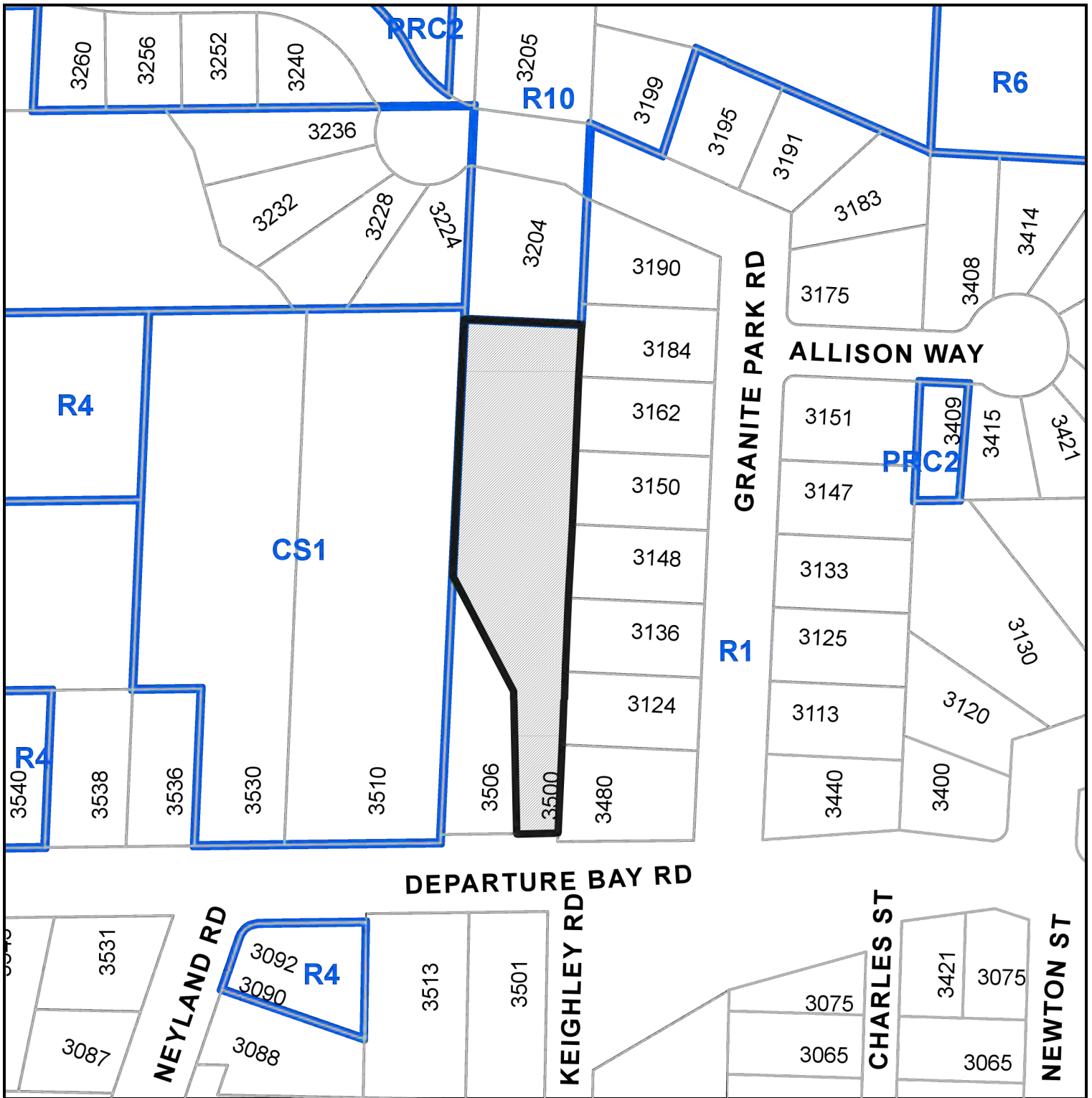

DEVELOPMENT PERMIT APPLICATION NO. DP001195 - 3500 DEPARTURE BAY ROAD



CIVIC: 3500 DEPARTURE BAY ROAD



Subject Property

LEGAL: LOT B, SECTION 5, WELLINGTON DISTRICT, PLAN VIP66170