

ATTACHMENT D SITE and PARKING PLANS

1 of 2

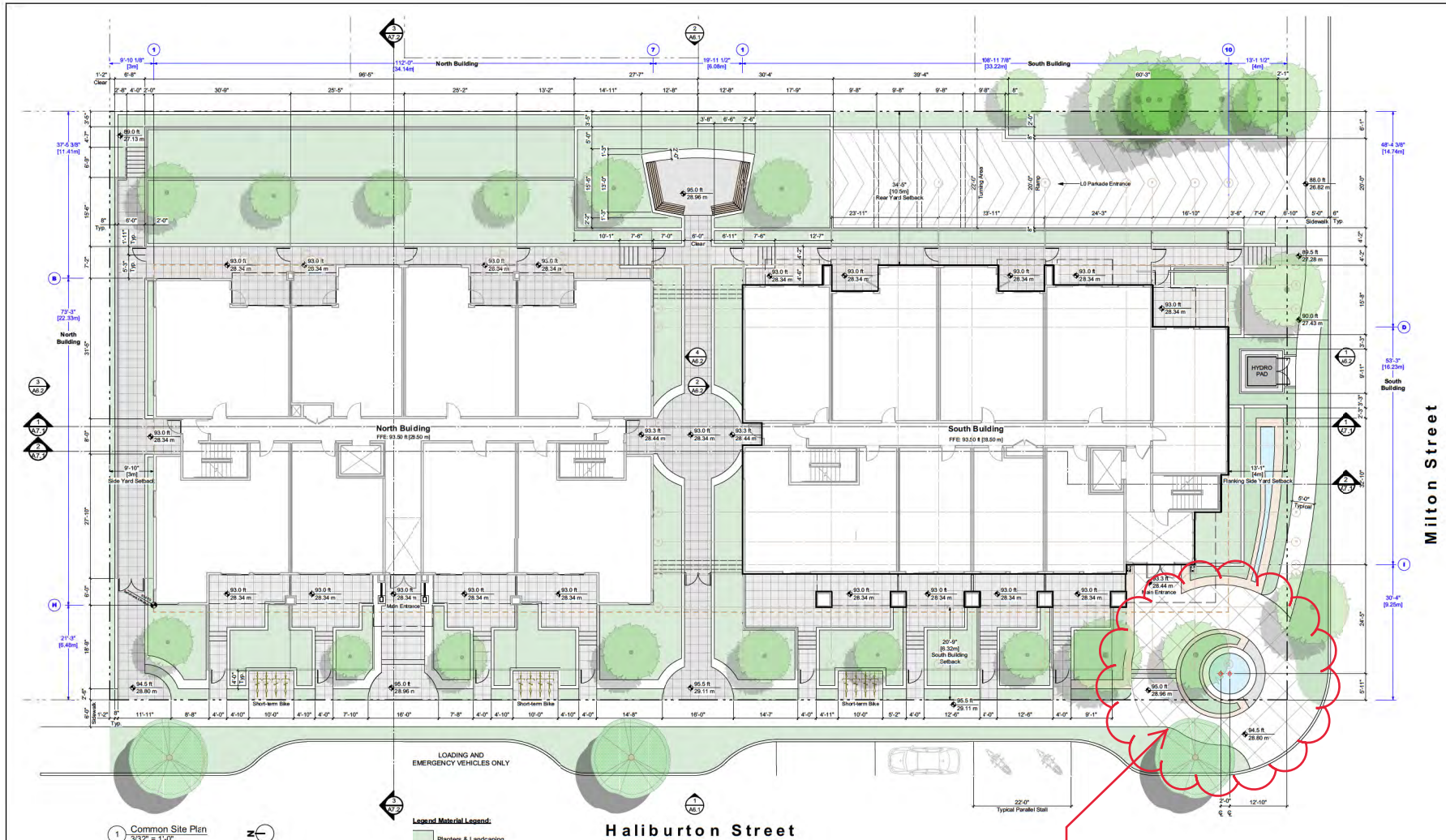

MATTHEW T. HANSEN
architect

1572 Kilmer Road
North Vancouver, B.C.
V7K 1S4
E: mhanse@mtharchitect.ca
T: 604-263-2723
C: 604-671-2383

Copyright reserved.
This drawing and design are and shall at all times remain the exclusive property of Matthew T. Hansen Architect and cannot be used or reproduced without written consent. Written dimensions shall have precedence over scaled dimensions. Contractor shall verify and shall be responsible for all dimensions and conditions on the job and the Architect shall be removed of any variations from the dimensions and conditions as shown on this drawing.

PROSPECT
AT HARBOURVIEW - NANAIMO
135, 139, 147, 151 Haliburton Street and 940 Milton Street, Nanaimo, B.C.
The Easiness 10 feet of Lot 1, The Westside 25 feet of the Easiness 45 feet of Lot 1, The Remainder of Lot 1, Lot 2, 3, and 4, Block 7, Section 8, Nanaimo District, Plan 594

No.	Date	Issue Notes
01	2019-10-07	DP Application
02	2019-10-10	DAP Meeting Revised DP Set
03	2020-03-25	DP Revision
04	2020-04-16	BP Application
05	2020-05-01	BP Application Revision 01
06	2020-05-28	BP Application Revision 02

No.	Date	Revision Notes
-----	------	----------------

Sheet Title:
Site Plan

Drawn: RH, KK
Job No.: 1905
Scale: As Noted
Date: Sep 15, 2020
CAD File: Prospect North (Plans) 33.vwx

Check: MTH
Sheet No.:
A1.0

RECEIVED
SEP 15 2020
CITY OF NANAIMO

1 Common Site Plan
3/32" = 1'-0"

Note:

- Blue dimensions are locating the building grid system to the site property lines.
-

Note:

Off-site frontage layout to be determined through detailed design review. One car share parking space to be provided on-street.

Legend/Material Legend:

- Planters & Landscaping
- Broom finish concrete
- Decorative Concrete (4ft - 5ft kerf cut diamond pattern)
- Interlock Pavers
- Water Feature

Public Plaza and Public Art Location

