

LOCATION PLAN - NTS

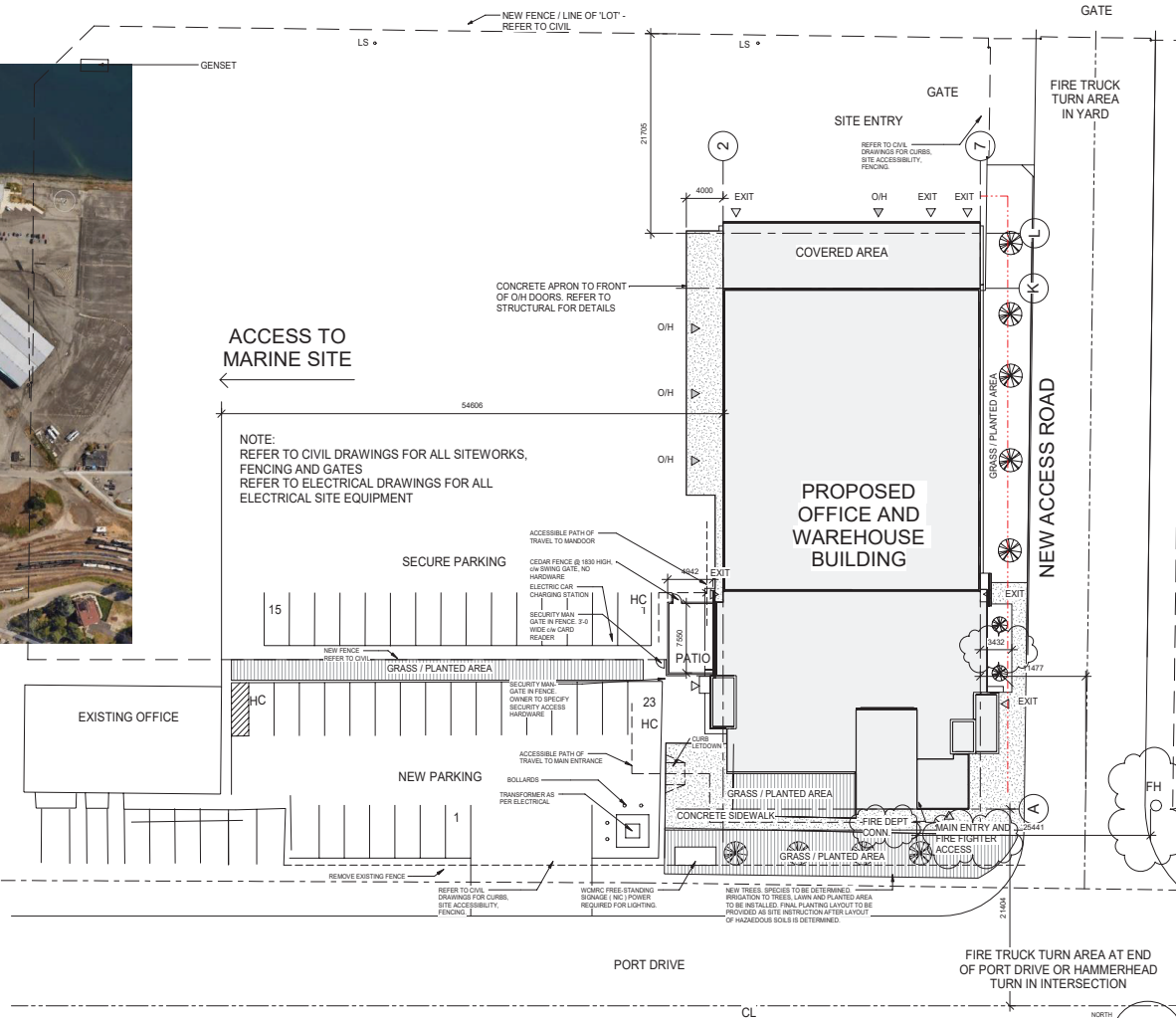

ISSUES		
NO.	DATE	ISSUED FOR
1	2017.10.13	FOR REVIEW
2	2017.10.13	CLIENT REVIEW
3	2018.12.21	CLIENT REVIEW
4	2020.01.20	RENDER
5	2020.03.04	FOR REVIEW
6	2020.03.23	CODE REVISIONS



WCMRC NPA RESPONSE FACILITY

NANAIMO ASSEMBLY WHARVES, NANAIMO, BC
NANAIMO PORT AUTHORITY

bjk
architecture inc.

2122 BRANDON RD. SHAWNIGAN LAKE BC
TEL: 250-894-1882



3701 Sheraton Rd. Nanaimo, BC V9T 2H1
T: 250 751 8558 F: 250 751 8559
E: mail@heroldengineering.com

© Copyright reserved. This drawing remains the exclusive property and may not be used or reproduced without written consent of Herold Engineering Limited.

SITE PLAN

DESIGNED	DATE
KAR/BJK	
DRAWN	DATE
JK/BJK	
DRAFTED	DATE
KAR	
DRAFTING REVIEW	DATE
JK	
PROJECT No.	CLIENT DRAWING No.
0386-063	
SCALE	PERMIT No.
1:250	
SHEET DRAWING No.	TOTAL
A101	15

RECEIVED
DP 1197
2020-MAY-21
CIVIL ENGINEERING

SE 57071 ALL DRAWINGS SHOWING PREVIOUS REVISION