

ATTACHMENT A



Staff Report for Decision

File Number: A4-1-2 / D1-4-9

DATE OF MEETING | MARCH 25, 2019

AUTHORED BY | RICHARD HARDING, DIRECTOR, PARKS AND RECREATION

SUBJECT | ROTARY CENTENNIAL GARDEN PROPOSAL FOR MAFFEO SUTTON PARK

OVERVIEW

Purpose of Report

To provide information regarding the Rotary Centennial Garden project in Maffeo Sutton Park.

Recommendation

That the Committee of the Whole recommend that Council:

1. approve the Rotary Centennial Garden for Maffeo Sutton Park as presented and that the garden be funded by the Rotarians;
2. amend the 2019 – 2023 Financial Plan to add the Centennial Garden project to 2019 for the \$200,000, fully funded by private contribution; and,
3. direct Staff to project manage the construction of Centennial Garden in coordination with the Rotarians for opening by 2020-MAY-01.

BACKGROUND

Nanaimo Rotarians have a long history of improving local parks and facilities. Since 1920, Nanaimo Rotarians have assisted in the building and funding of projects throughout Nanaimo including a number of large-scale projects as well as the development of Bowen Park, Rotary Bowl and track, gateways to Nanaimo, Rotary Fieldhouse on Third Street, and the Northfield Rest Stop and picnic areas (now the tourism visitor centre).

Nanaimo Rotarians contacted Staff in 2016 to brainstorm ideas for a new project on the Nanaimo waterfront that potentially could be implemented for the club's 100th anniversary in 2020. Staff suggested that projects in Maffeo Sutton Park may be a good fit as part of the ongoing improvement planning for this destination park. The Nanaimo Rotary Club hired external consultants to help articulate their ideas for a legacy project.

In November 2017, Nanaimo Rotary and the Child Development Centre made a presentation to Council supporting the Draft Maffeo Sutton Park Improvement Plan. Nanaimo Rotary was especially interested in creating a contemplation area to acknowledge their 100 years in Nanaimo.

The following motion was passed at the Committee of the Whole Meeting on 2017-NOV-27:

“It was moved and seconded that Council direct Staff to work with the Nanaimo Child Development Centre, Rotary Club of Nanaimo, and partners, to develop a plan for the Maffeo Sutton Park playground that is all-inclusive.”

Staff have continued to do this work and Phase 1 of the inclusive playground is expected to be constructed in the fall of 2019.

While the Nanaimo Rotary support the inclusive playground project in principal, their focus site for Rotary recognition and contemplation project has now moved to a proposed site adjacent to the playground (Attachment A).

This location at the northeast corner of Maffeo Sutton Park is currently an open green space and is under utilized by formal events or programming in the park.

The Maffeo Sutton Park Master Plan Update shows it remaining an informal open space that can be used for informal use and visual greenspace. This location is a key corner for vantage points of the harbour and increased access to the water’s edge. The Nanaimo Rotary Club’s plans are consistent with these principals.

As the project developed in 2018, it became clear that a collaborative project with the Nanaimo Rotary Club and the City of Nanaimo in this location would improve the park for everyone. It would also integrate well into the City’s goals of improving the perimeter paved Waterfront Walkway trail in this location which is in need of repaving and improvements to drainage.

The Rotarians would like to donate \$200,000 to the City of Nanaimo in order to implement their proposal of a contemplation and peace garden in Maffeo Sutton Park. The overall collaborative concept is estimated at \$200,000. If approved in concept and through budgeting processes, the project would then be managed by the City of Nanaimo in the 2020 Capital planning cycle. The projected opening date of this project is 2020-MAY-01.]

OPTIONS

Option 1

That the Committee of the Whole recommend that Council:

1. approve the Rotary Centennial Garden for Maffeo Sutton Park as presented and that the garden be funded by the Rotarians;
2. amend the 2019 – 2023 Financial Plan to add the Centennial Garden project to 2019 for the \$200,000, fully funded by private contribution; and,
3. direct Staff to project manage the construction of Centennial Garden in coordination with the Rotarians for opening by May 1, 2020.
 - **Budget Implication:** All funds are private contributions for this project and total \$200,000. The Rotary Club will be sending a letter to confirm the funds are in place.

- **Policy Implication:** Continued community partnerships with groups like the Nanaimo Rotary clubs are supported in numerous policy documents. The work is consistent with the Maffeo Sutton Park Master Plan Update. The City will be providing the land and will manage the project while development of the adjacent playground is underway.
- **Engagement Implication:** Public engagement regarding the overall park improvements has been carried out under the Maffeo Sutton Park Master Plan Update process. The details of this proposal are consistent with the overall plan goals and engagement work to date. The specifics of this proposal have been developed through the Nanaimo Rotary Clubs but have not been shared with the general public.

Option 2. That The Committee of the Whole recommend that Council not support the collaborative proposal between the Nanaimo Rotary Clubs and City of Nanaimo.

- **Budget Implication:** Budgets for 2020 will not change, however, Waterfront Walkway maintenance improvements of the perimeter walkway will still have to be completed in the near future.
- **Policy Implication:** Not supporting the project may affect future partnerships with community groups like the Nanaimo Rotary.

SUMMARY POINTS

- Rotary Clubs in Nanaimo have a long history of completing projects in parks.
- Rotary is celebrating their 100th anniversary in Nanaimo in 2020.
- Nanaimo Rotarians are interested in marking their 100th year anniversary through a legacy project in Maffeo Sutton Park. If accepted, this project would equate to a donation of \$200,000 of improvements to the northeast corner of Maffeo Sutton Park
- The City of Nanaimo is proposing a collaborative project with City funding and support to improve Maffeo Sutton Park for the community.

ATTACHMENTS

Attachment A – Location of Rotary Club Proposal

Attachment B - Landscape Plans for the Centennial Garden in Maffeo Sutton Park

Attachment C – Correspondence from the Rotary Club regarding funding.

Submitted by:

Kirsty MacDonald
Parks and Open Space Planner

Concurrence by:

Richard Harding
Director, Parks and Recreation

ATTACHMENT A

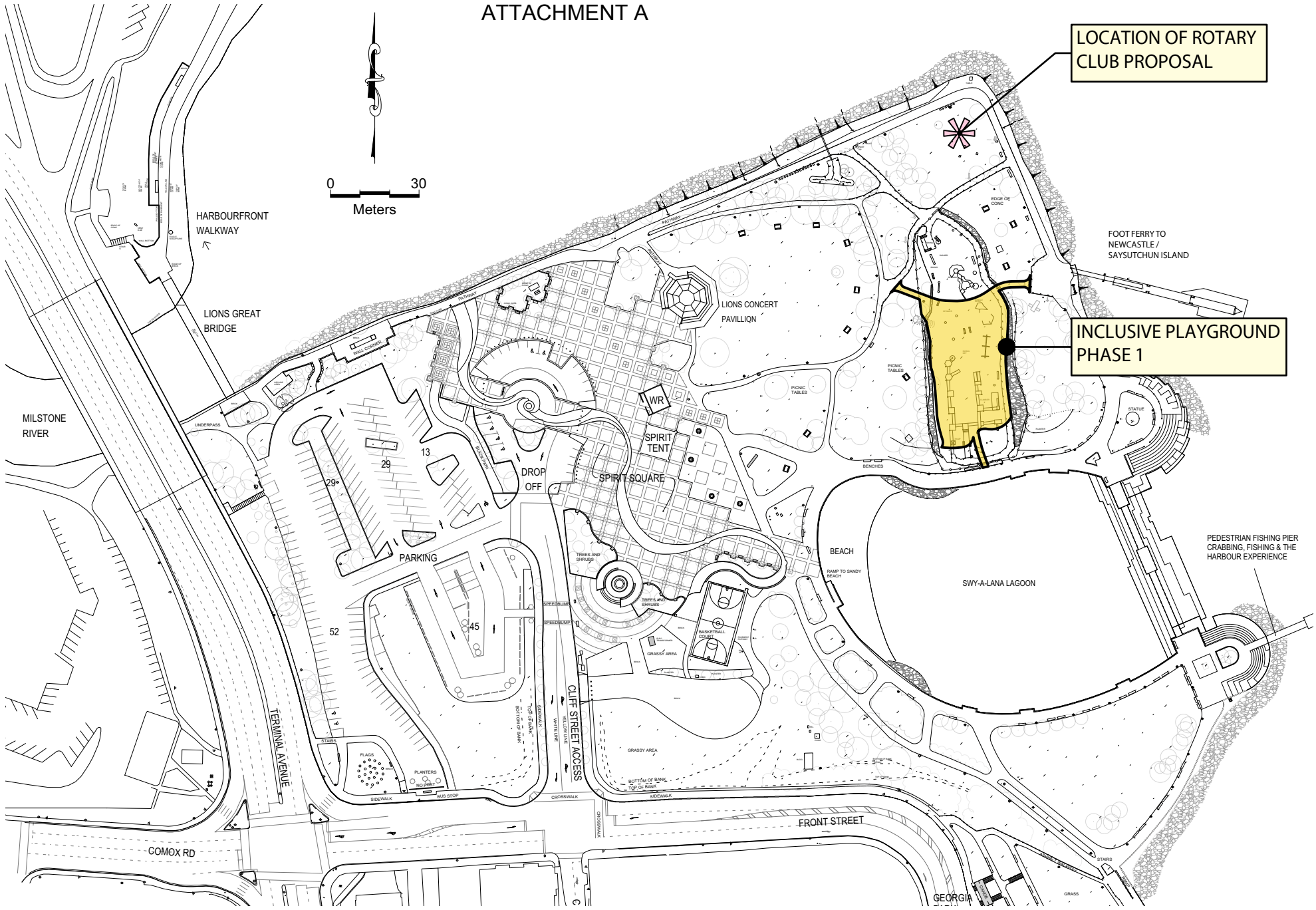

LOCATION OF ROTARY CLUB PROPOSAL

INCLUSIVE PLAYGROUND PHASE 1

LANDSCAPE LEGEND	
SYMBOL	DESCRIPTION
	BENCH (see sheet L3.2, detail 8 & 9)
	SIGNAGE (see sheet L3.04, detail 14)
	CONCRETE PAVER (see sheet L3.01, detail 4)
	CONCRETE
	GRASS (see sheet L2.01 Planting Plan)
	EXISTING DECIDUOUS TREE
	EXISTING EVERGREEN TREE

LANDSCAPE NOTES	
1.	It is the Contractor's responsibility to contact the Landscape Architect if the information in this drawing package requires further clarification.
2.	Contractor shall refer to the contract specifications for additional requirements.
3.	All landscape construction to meet the current edition of the Canadian Landscape Standards as a minimal acceptable standard.
4.	Contractor to confirm layout of landscape plan on site with Landscape Architect.
5.	Temporary tree protection fencing to be installed at drip line of existing trees to remain. Maintain fencing during construction. No storage of materials or equipment, or any other activities are allowed within the protection zone during construction until final landscape work is done in the vicinity. Remove protective fencing as directed.
7.	Irrigation to be designed & built by Contractor. As built drawings required.

Refer to **Sheet L2.01** for Plant List & Planting Notes

NOT FOR CONSTRUCTION

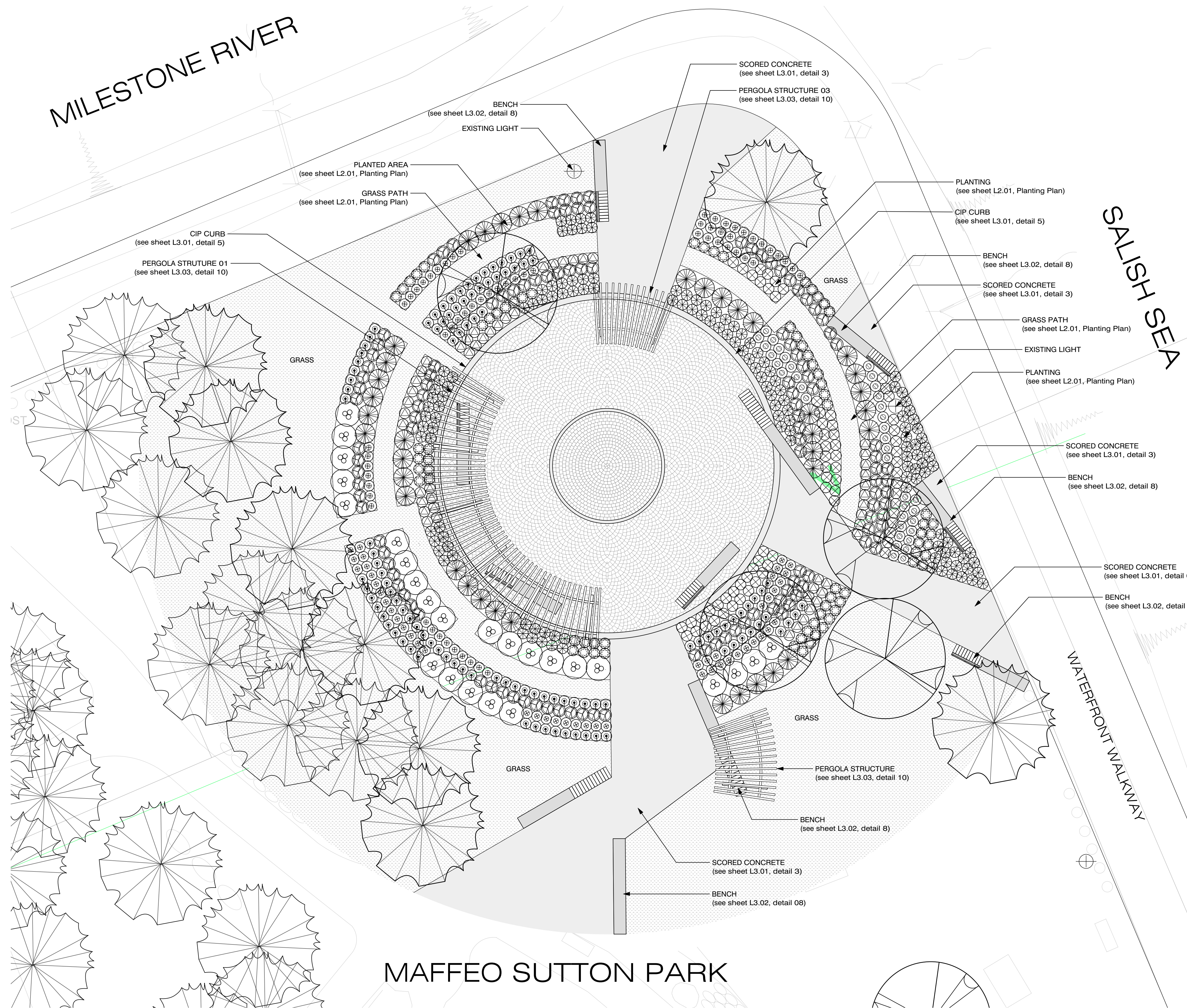

LANDSCAPE PLAN
SCALE 1:100

VICTORIA DRAKEFORD
LANDSCAPE ARCHITECT

236 Pine Street Nanaimo BC V9S 2K2
250-754-4335
victoria@island.net

KATE STEFIUK STUDIO

1070 Nelson Street Nanaimo BC V9S 2K2
250-753-8093
kate.stefiuk@gmail.com

CLIENT

NO. | DATE | ISSUE

1 | 01-10-19 | ISSUED FOR 90% REVIEW

NO. | DATE | REVISION

PROJECT

ROTARY CENTENNIAL GARDEN

100 Comox Road
Nanaimo, B.C.

LANDSCAPE PLAN

All drawings and specifications are the copyright property of the Landscape Architect. Use or reproduction of documents in whole or in part is subject to the Landscape Architect's specific consent.

PROJECT 17007
DB KS **CB** VD

SCALE 1:100
DATE January 10, 2019

L1.01

MILESTONE RIVER

SALISH SEA

WATERFRONT WALKWAY

MAFFEO SUTTON PARK

NOT FOR CONSTRUCTION

- PLANTING NOTES**
1. Contractor is responsible for verifying all plant quantities & confirm plant layout.
 2. Contractor shall refer to the contract specifications for additional requirements.
 3. Seeding to be in accordance with Section 32.92.19.

PLANT LIST

Key	Qty	Symbol	Botanical Name	Common Name	Pot Size
Evergreen Shrubs/Groundcovers/Ferns					
Gs	107	⊙	Gaultheria shallon	Salal	#1
Pm	109	⊕	Polystichum munitum	Sword Fern	#1
Vo	114	⊗	Vaccinium ovatum	Evergreen Huckleberry	#1
Deciduous Shrubs					
Rs	25	⊗	Ribes sanguineum	Red Flowering Currant	#1
Grasses					
Dc	50	⊙	Deschampsia cespitosa	Tufted Hairgrass	#1
Em	41	⊕	Elymus mollis	Beach Grass	#1
M	39	⊗	Miscanthus yaku jima	Dwarf Maiden Grass	#1
Perennials					
As	51	⊕	Artemisia suksdorfii	Coastal Mugwort	10 cm
Gi	40	⊗	Grindelia stricta	Hairy Gumweed	#1
Lj	40	⊗	Lathyrus japonicus	Beach Pea	10 cm
Sl	37	⊙	Solidago lepida	Canada Goldenrod	10 cm
Ss	69	⊗	Symphotrichum subspicatum	Douglas Aster	10 cm

PLANTING PLAN
SCALE 1:100

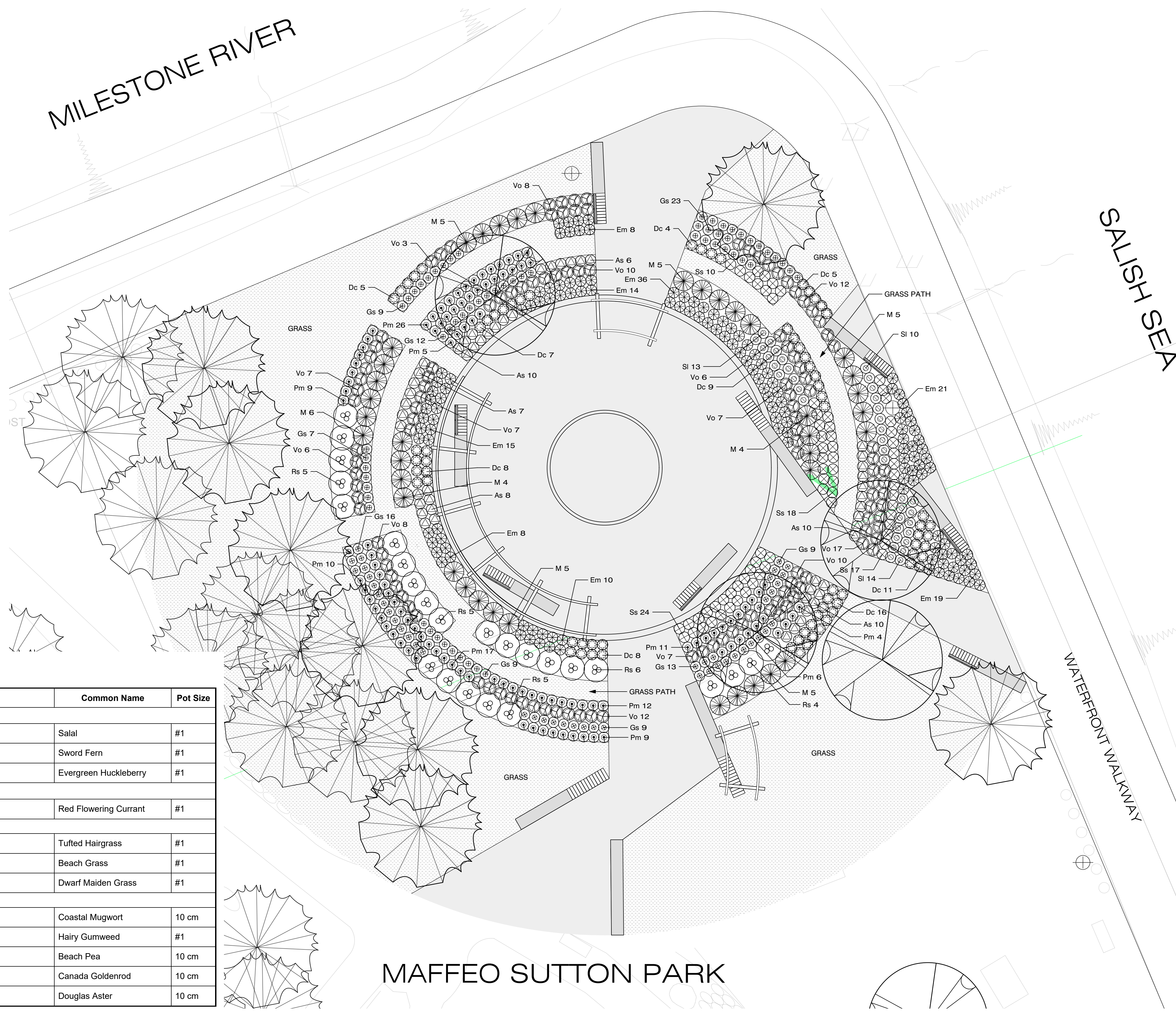

VICTORIA DRAKEFORD
LANDSCAPE ARCHITECT
236 Pine Street Nanaimo BC V9S 2K2
250-754-4335
victoria@island.net

KATE STEFIUK STUDIO
1070 Nelson Street Nanaimo BC V9S 2K2
250-753-8093
kate.stefiuk@gmail.com

CLIENT

NO.	DATE	ISSUE
1	07-17-18	ISSUED FOR BP
2	08-17-18	ISSUED FOR TENDER

NO. | DATE | REVISION

PROJECT
ROTARY CENTENNIAL GARDEN
100 Comox Road
Nanaimo, B.C.

PLANTING PLAN

All drawings and specifications are the copyright property of the Landscape Architect. Use or reproduction of documents in whole or in part is subject to the Landscape Architect's specific consent.

PROJECT 17007
DB KS **CB** VD

SCALE 1:100
DATE January 10, 2019

L2.01

NOT FOR CONSTRUCTION

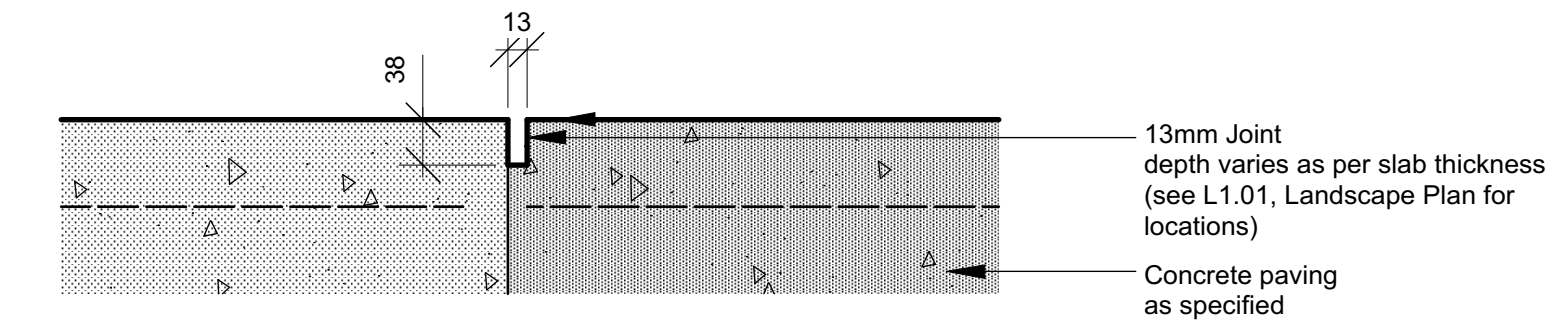

1 Joint @ Pour Break
L3.01 Scale: 1:5 Section

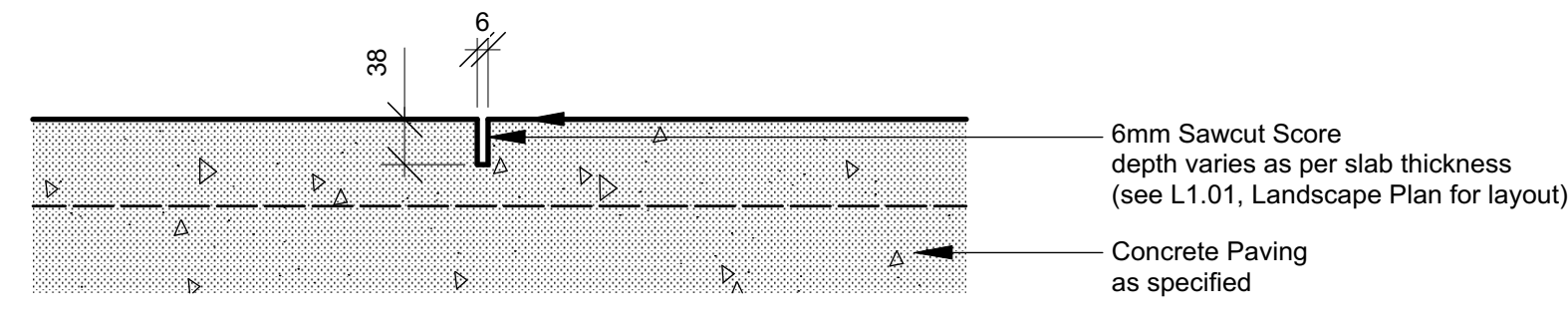

2 Control Joint
L3.01 Scale: 1:5 Section

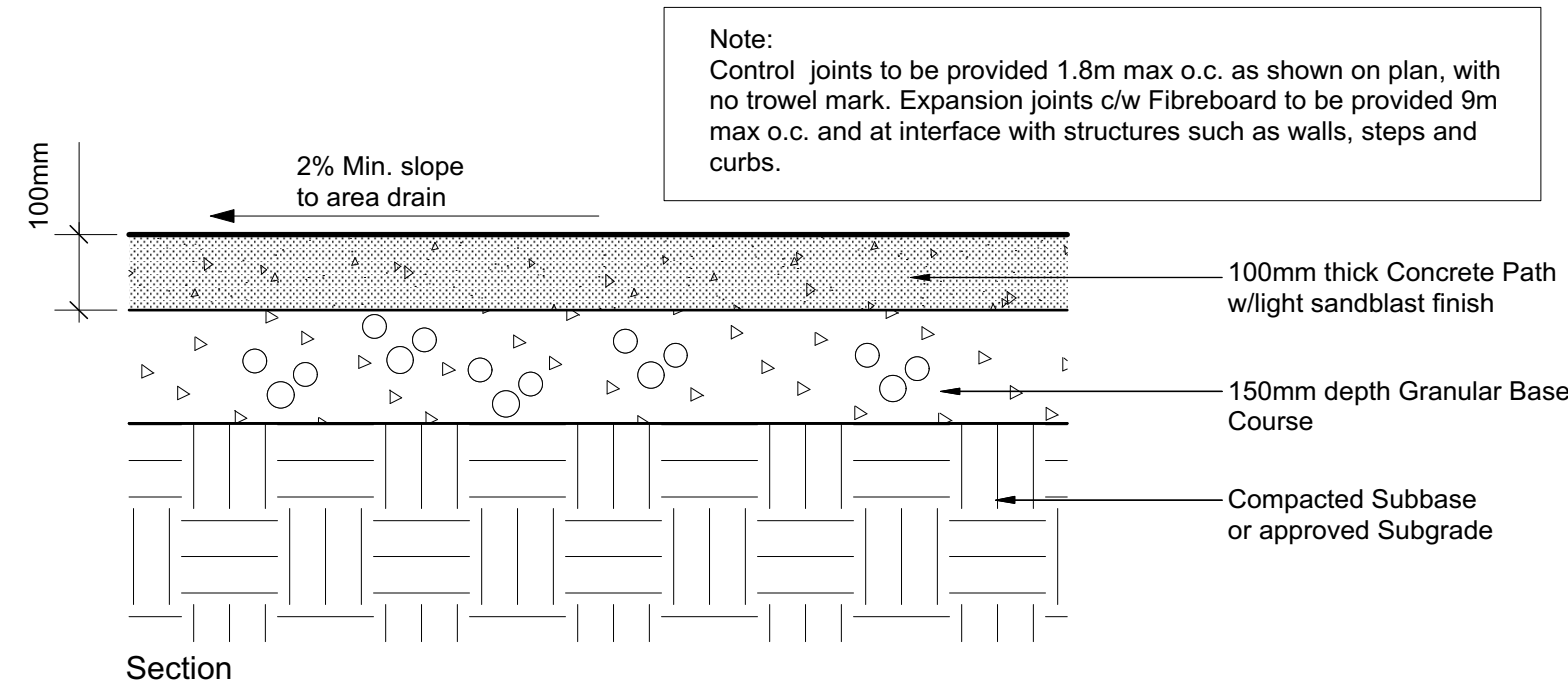

3 Concrete Paving
L3.01 Scale: 1:10 Section

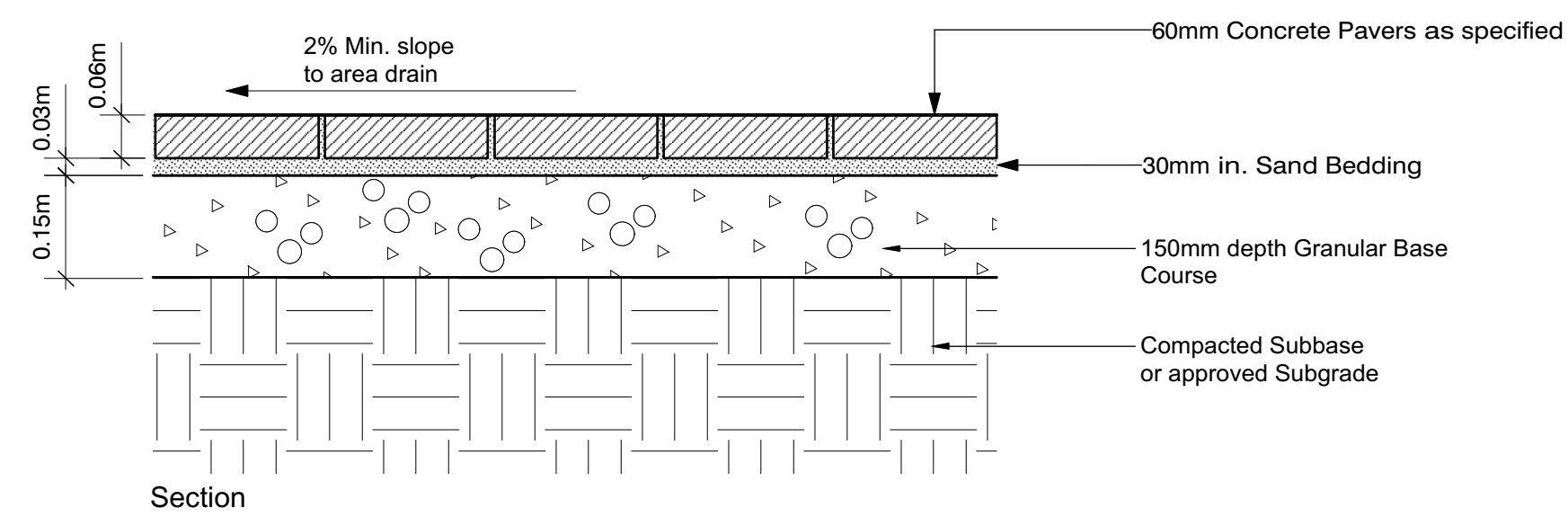

4 Concrete Pavers
L3.01 Scale: 1:10 Section

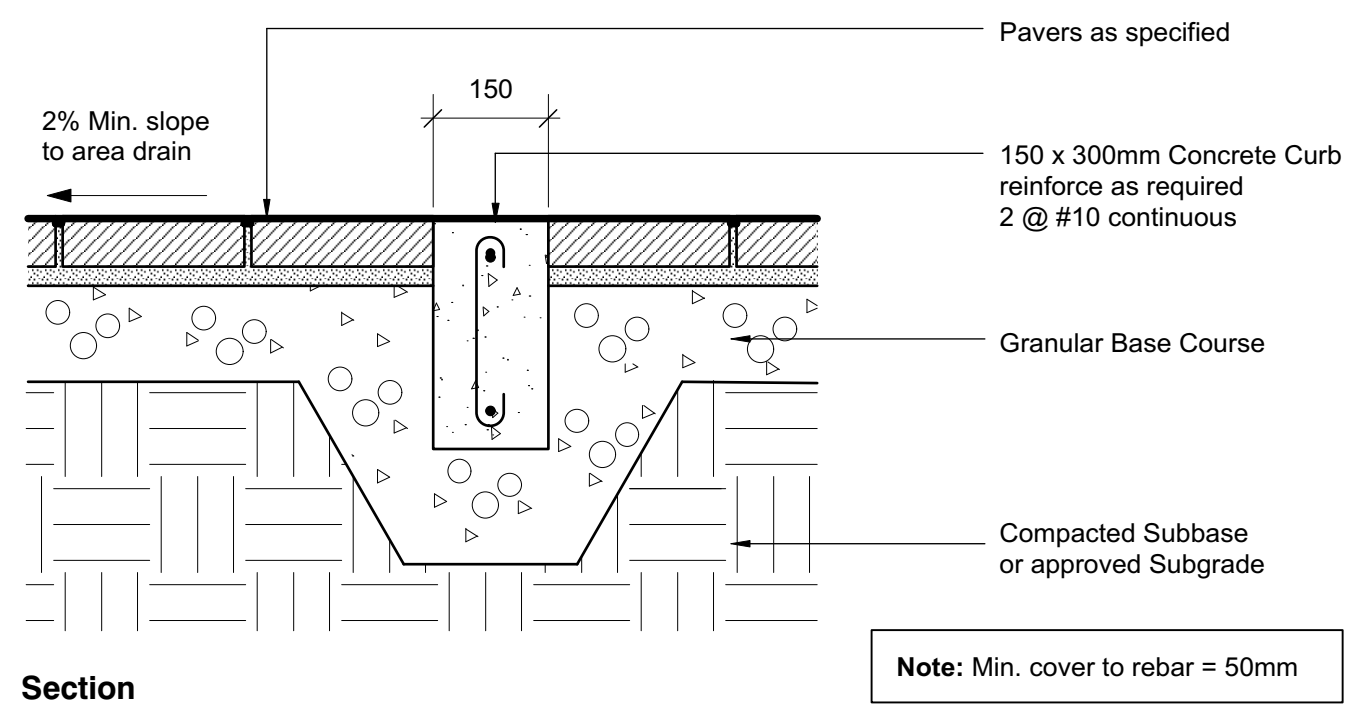

5 CIP Curb
L3.01 Scale: 1:10 Section

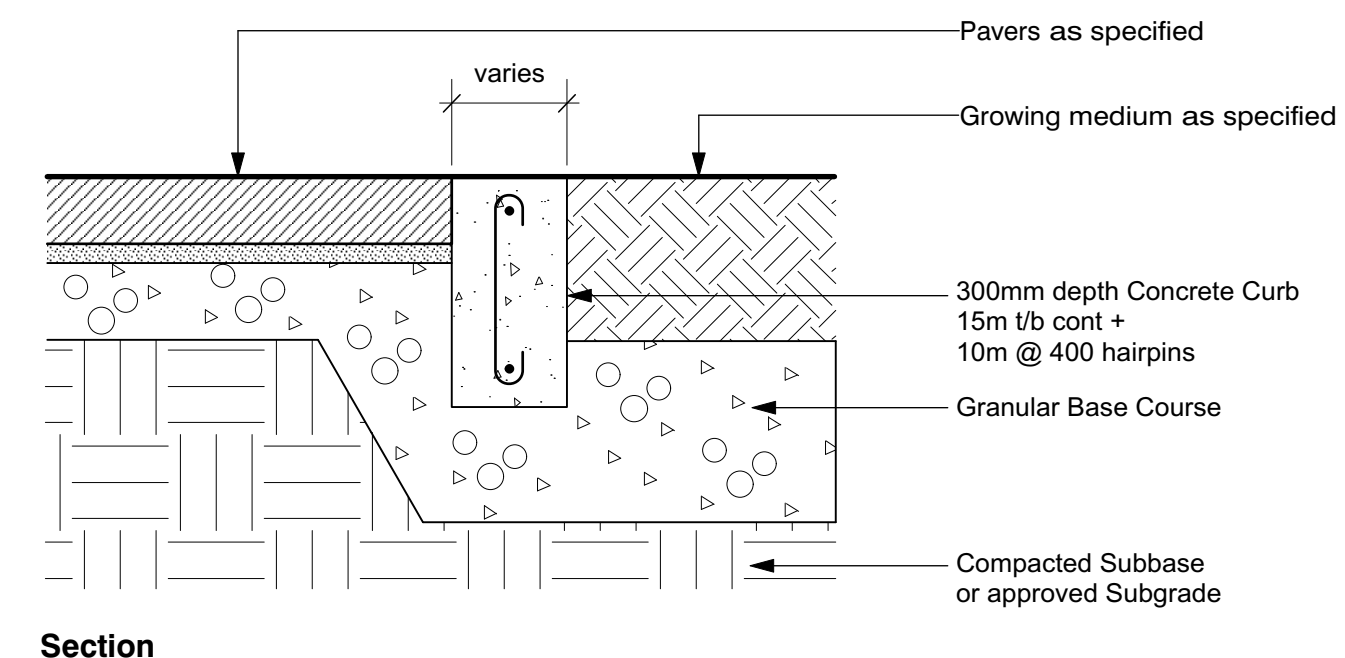

6 Text Inlay
L3.01 Scale: 1:10 Section

How to get a professional look.

1. Compact and level the sub-base.
2. Backfill with 4" to 10" (50-250mm) of 3/4" minus road mulch or equivalent compacted granular fill.
3. Spread 1" (25mm) of concrete sand over fill. Avoid walking on the prepared base as this may cause the finished surface to be uneven.
4. Place Villa Stone pavers in the desired pattern close together. The spacing should be consistent to help maintain a uniform pattern. Pavers can be cut to fit with a paver cutter or masonry saw.
5. Tamp down pavers with a mechanical vibrator until level and firmly in place.
6. Fill joints completely by sweeping Abbotsford Concrete's joint sand across the surface, then compacting until joints are completely filled. The area is now ready for immediate use.

Specifications:

ABBOTSFORD CONCRETE PRODUCTS
Pavers are manufactured by SUE P. CO. and CSA A231.2-14 specifications.

Concrete strength: 8000 PSI (55 MPa)
Absorption: shall not exceed 5%
Weight: 2-1/2" (60mm): approx. 28lb/sq' (140kg/sq')
3-1/2" (90mm): approx. 37lb/sq' (180kg/sq')

Visit our website at www.pavingstones.com for our complete product guide, color selection, design details and photo gallery, or call toll free 1-800-663-4091.

The Villa Stone paver series allows you to make a real design statement using sweeping curves, dramatic fans, full and half circles as well as a random cobble pattern. This paver will accent any landscape.

- Type 1**
160mm x 240mm
6-5/16" x 9-7/16"
- Type 2**
160mm x 160mm
6-5/16" x 6-5/16"
- Type 3**
120mm x 160mm
4-3/4" x 6-5/16"

Circle Package

- Three Quarter Stone**
118mm x 158mm
4-5/8" x 6-1/4"
- Half Stone**
78mm x 158mm
3" x 6-1/4"
- Small Circle Stone**
68mm x 158mm x 182mm
2-11/16" x 6-1/4" x 7-1/8"
- Large Circle Stone**
98mm x 132mm x 158mm
3-7/8" x 5-13/16" x 6-1/4"
- Center Stone**
78mm x 158mm
3" x 6-1/4"



Our Villa Stone is made with the unique PermaFinish two layer process. In this process, the wearing surface of the paver is composed of uniformly graded hard, sharp granite aggregate, high cement content and a correspondingly high pigment content. This results in a dense high strength surface, more intense color stability and greater abrasion resistance than traditional paving stones. The balance of the paver is composed of high strength compressed concrete.



While the colors shown here are represented as accurately as possible, they should only be used as a guide. Actual samples should be viewed before making a final color selection.

*For best results, pavers should be installed from several pallets to ensure color consistency, especially with multi-color blends.

**Sealed* pavers in this brochure have received an acrylic sealer, which is recommended to help with maintenance and to protect them against staining. Sealing is done post installation.



13-11-18

Paving Pattern 01
Centre Circle
(see sheet L1.01, Landscape Plan)

Circle Diameter: 6m

Field:
Villa Stone Paver Series
Circle Package
Abbotsford Concrete Products

Colour:
Granite Blend

Refer to manufacturers specifications for installation (see specification sheet attached)

Paving Pattern 02
Fan Pattern
(repeat pattern to fill in space around circle, see sheet L1.01, Landscape Plan)

Field:
Villa Stone Paver Series
Circle Package
Abbotsford Concrete Products

Colour:
Granite Blend

Refer to manufacturers specifications for installation (see specification sheet attached)

PROJECT
ROTARY CENTENNIAL GARDEN

100 Comox Road
Nanaimo, B.C.

LANDSCAPE DETAILS

All drawings and specifications are the copyright property of the Landscape Architect. Use or reproduction of documents in whole or in part is subject to the Landscape Architect's specific consent.

PROJECT 17007
DB KS **CB** VD

SCALE NTS
DATE January 10, 2019



L3.01

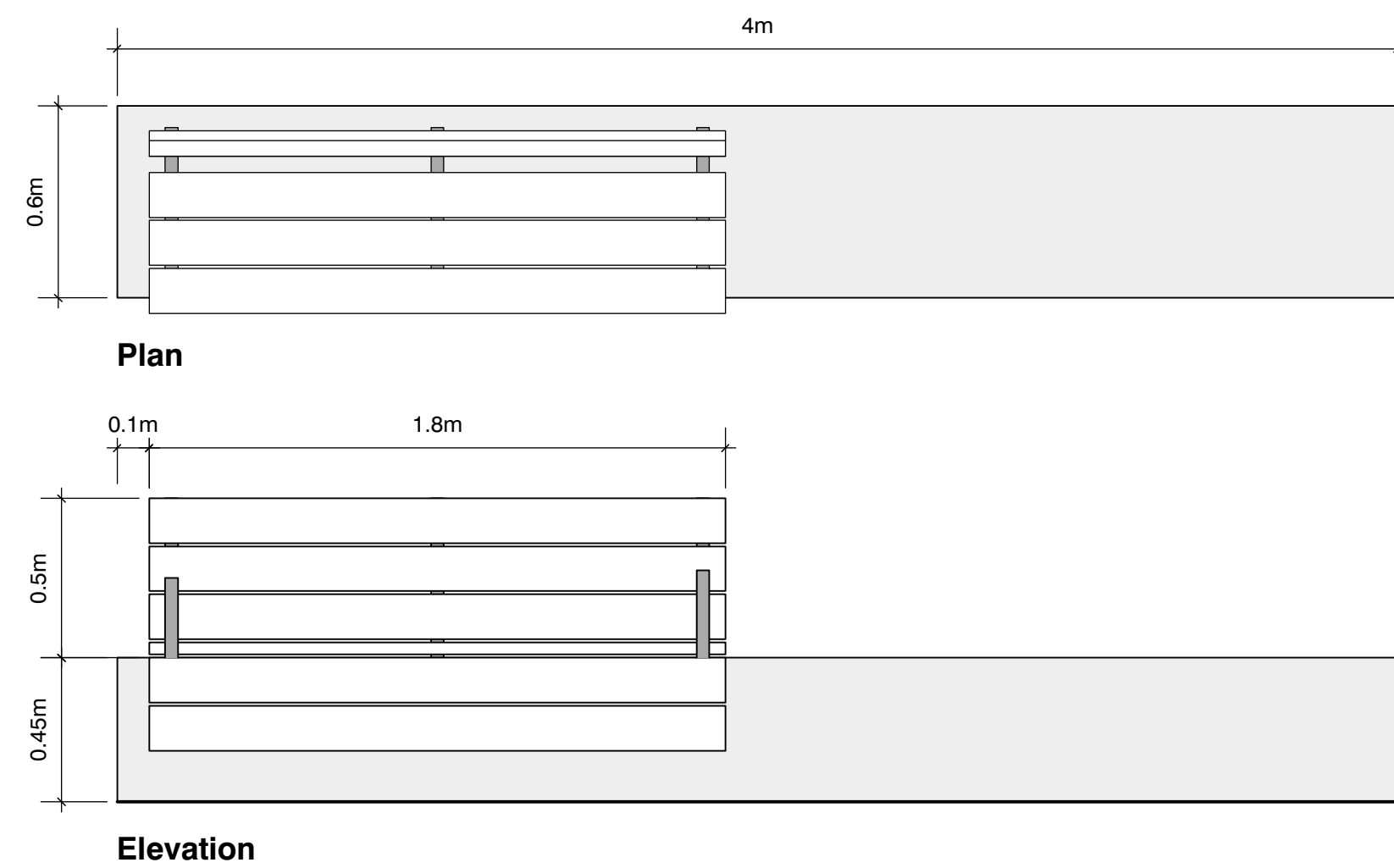
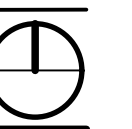

Notes:
Universe System 71" Backed Bench supplied by Landscape Form or equivalent.
Bench anchored to concrete with screws as per manufacturers specifications.

Note:
Min cover to rebar = 50mm

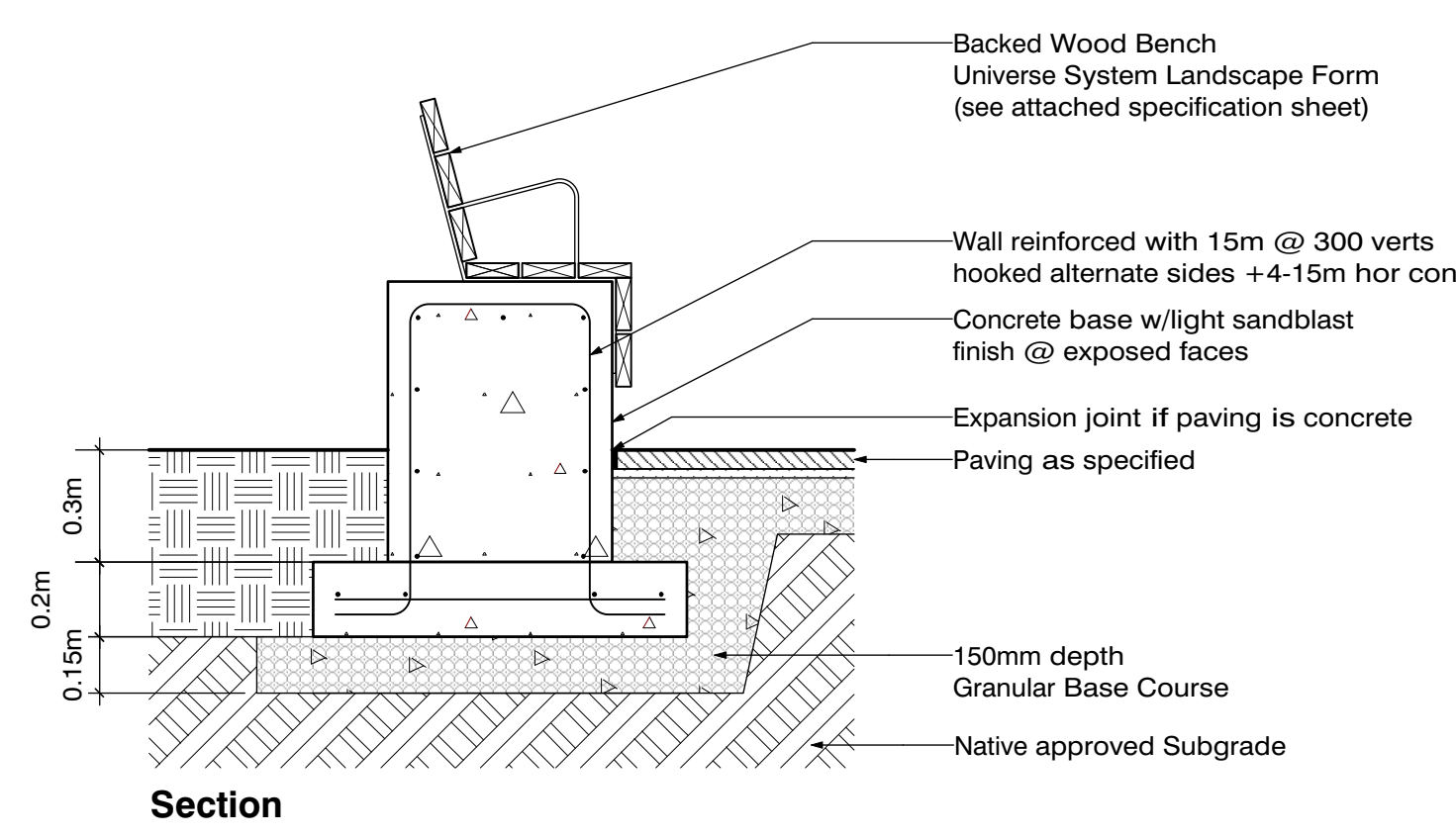

Plan / Elevation / Section

8
Bench Type 01
Scale: 1:20

landscapeforms
UNIVERSE SYSTEM
Product Data Sheet



The Universe System is a set of simple, comfortable and universal accessories, suitable for any element that requires a seat. It was designed as a complement to Escofet's concrete backless bench collection. The system includes lightweight steel and wood benches and chairs with armrests and a backless bench and backless seat. All rest on standard backless benches or on "in situ" masonry walls. The seats are made from FSC-certified tropic wood boards with steel supports and arms and are anchored to a wall or concrete bench with stainless steel screws and metal expansion plugs.

- Bench**
- The Universe System is a top of wall mounted bench made of lightweight steel and wood.
 - Available backed or backless, in lengths of 71" (180cm) or 25" (62cm).
 - Bench comes standard with Tropical Wood FSC.
 - Wood is treated with a pigmented, translucent oil.
 - Backed benches comes standard with arm rests.
 - Straps and arm rests are zinc-plated steel and finished with silver powdercoat.

	STYLE	DEPTH	LENGTH	HEIGHT	PRODUCT WEIGHT
	backed 71"	25"	71"	25"	84 lb
	backless 71"	22"	71"	8"	62 lb
	backed 25"	25"	25"	25"	44 lb
	backless 25"	22"	25"	8"	35 lb

- Mounting**
- The Universe System is anchored to wall with screws.
 - Benches can be mounted on masonry walls or some of Escofet's cast stone backless benches.

- Product Warranty**
- ESCOFET warrants the durability of its product to Landscape Forms for a period of five (5) years from the date of invoice.
 - The warranty covers the repair or replacement of the product or components at no charge.
 - Notwithstanding, this warranty does not cover damages to ESCOFET products resulting from unloading, handling, installation, abuse, exposure to paint, liquids or corrosives, or any other damage not attributable to ESCOFET.
 - The warranty shall also be void if ESCOFET products are tampered with, handled, removed or modified by persons not authorized by ESCOFET, or if the product has not been properly maintained by the customer.

- To Specify**
- To order, specify Universe System, select 71" or 25", and backed or backless.
 - Bench is anchored to wall or concrete bench with screws.
 - See materials/color sheet for standard Escofet color options.

Designed by Escofet 1886

Visit landscapeforms.com for more information. Specifications are subject to change without notice. Landscape Forms supports the Landscape Architecture Foundation at the Second Century level. ©2018 Landscape Forms, Inc. Printed in U.S.A. Landscape Forms, Inc. | 800.521.2546 | F 269.381.3455 | 7800 E. Michigan Ave., Kalamazoo, MI 49048

rev. 2/2018

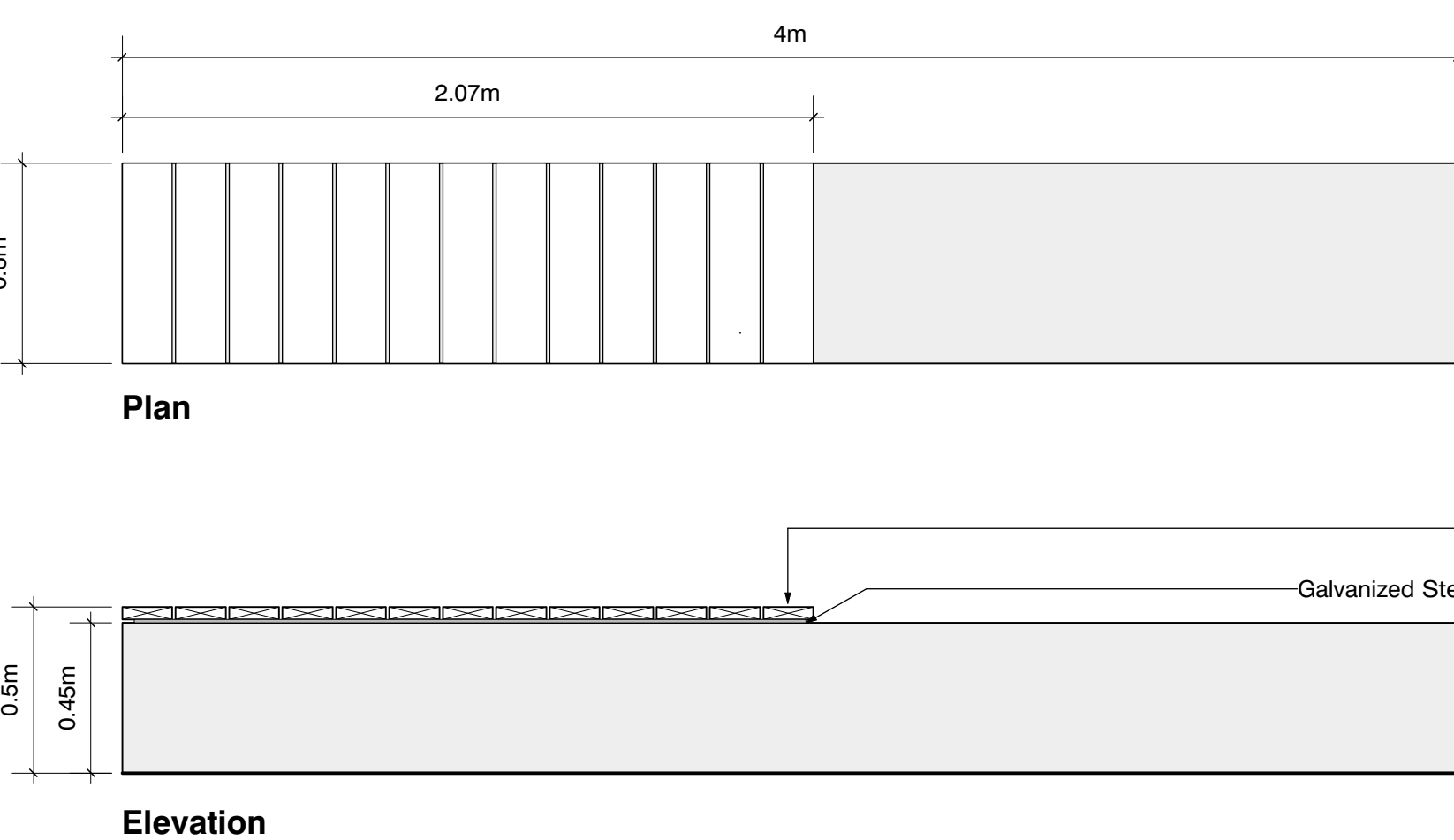

Notes:
All metal to be hot dip galvanized after fabrication. Shop drawings required for design including all finishes, connections, and hardware, submit to Landscape Architect for approval.

All wood to be selected tight knot cedar. All cut ends to be properly sealed.
Cedar to be finished with clear sealer as per manufacturer's specifications. Contractor to confirm finish with Landscape Architect.

Note:
Min cover to rebar = 50mm

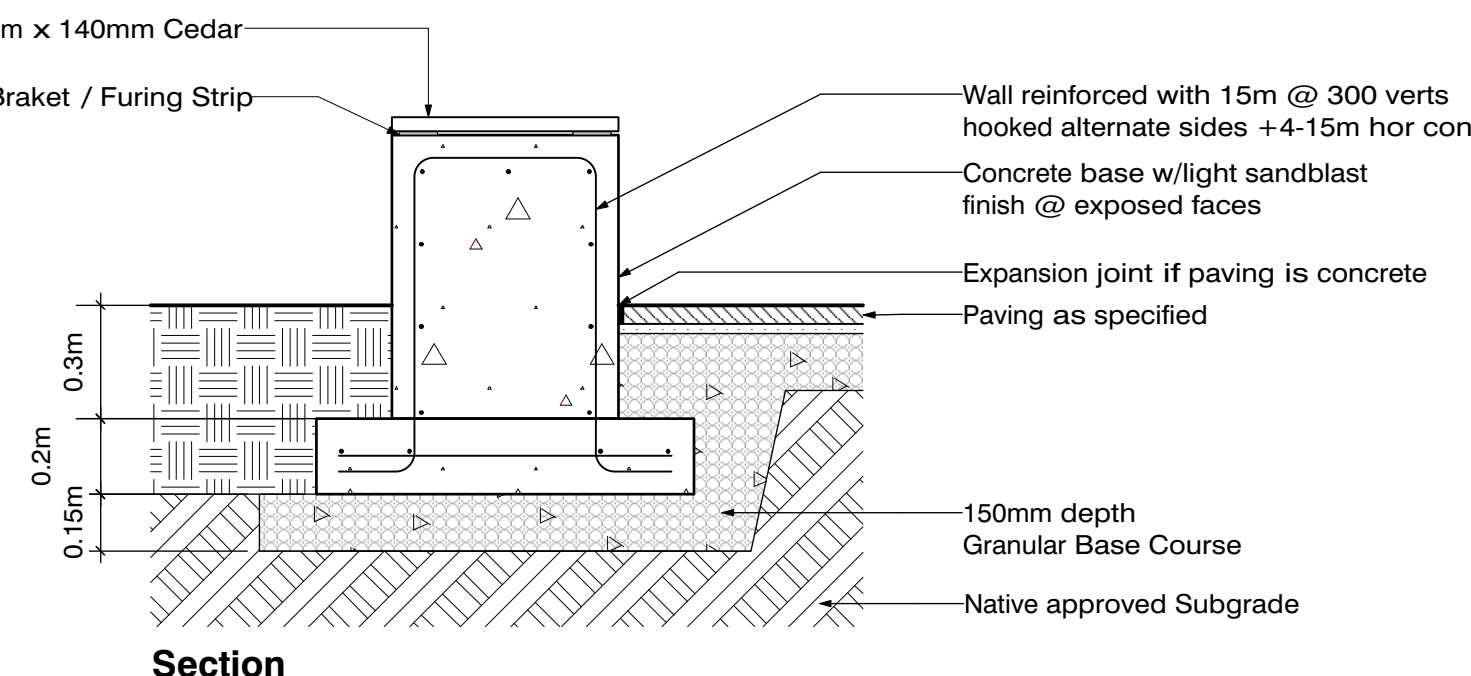

Plan / Elevation / Section

9
Bench Type 02
Scale: 1:20

NOT FOR CONSTRUCTION

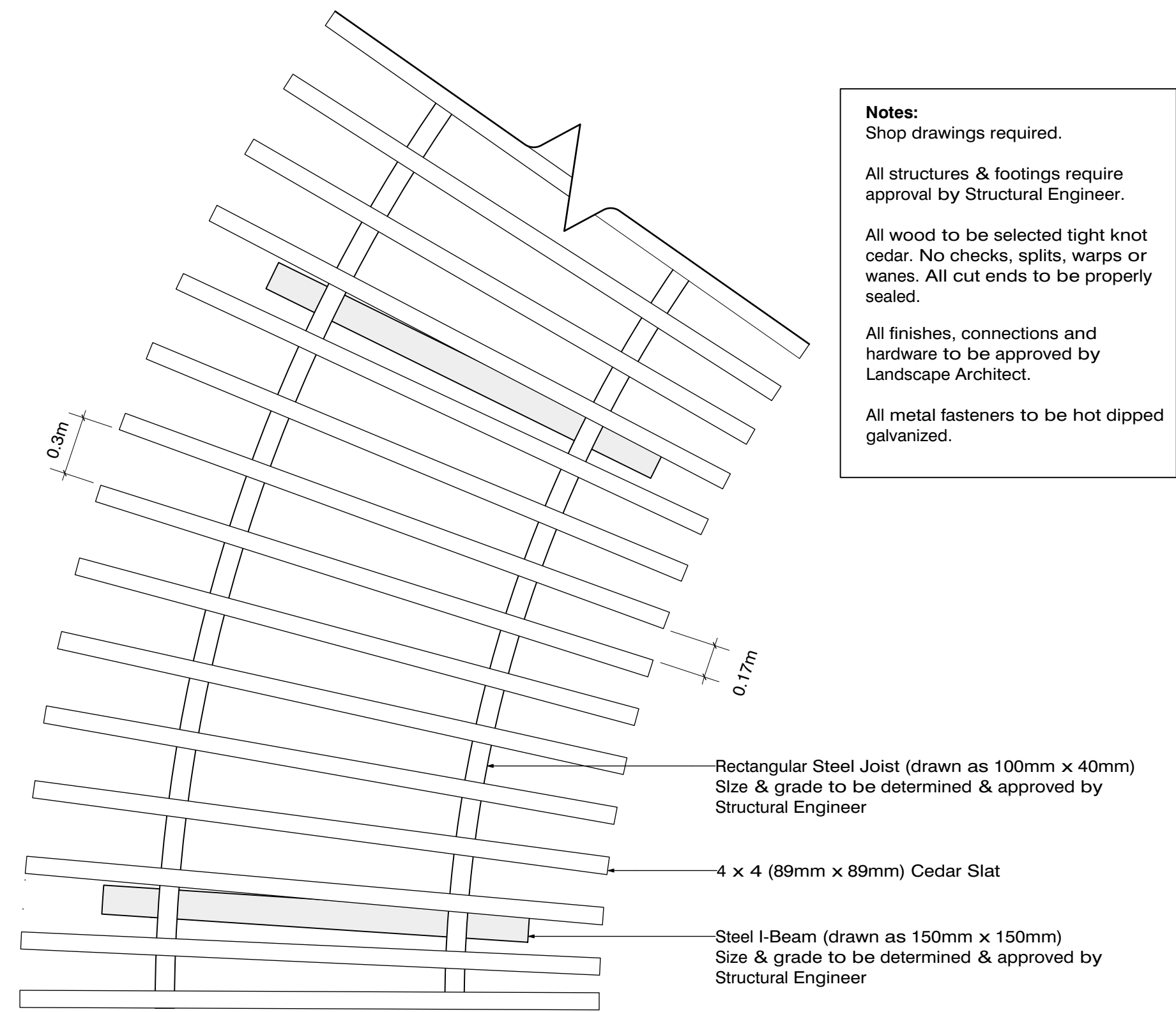

Plan

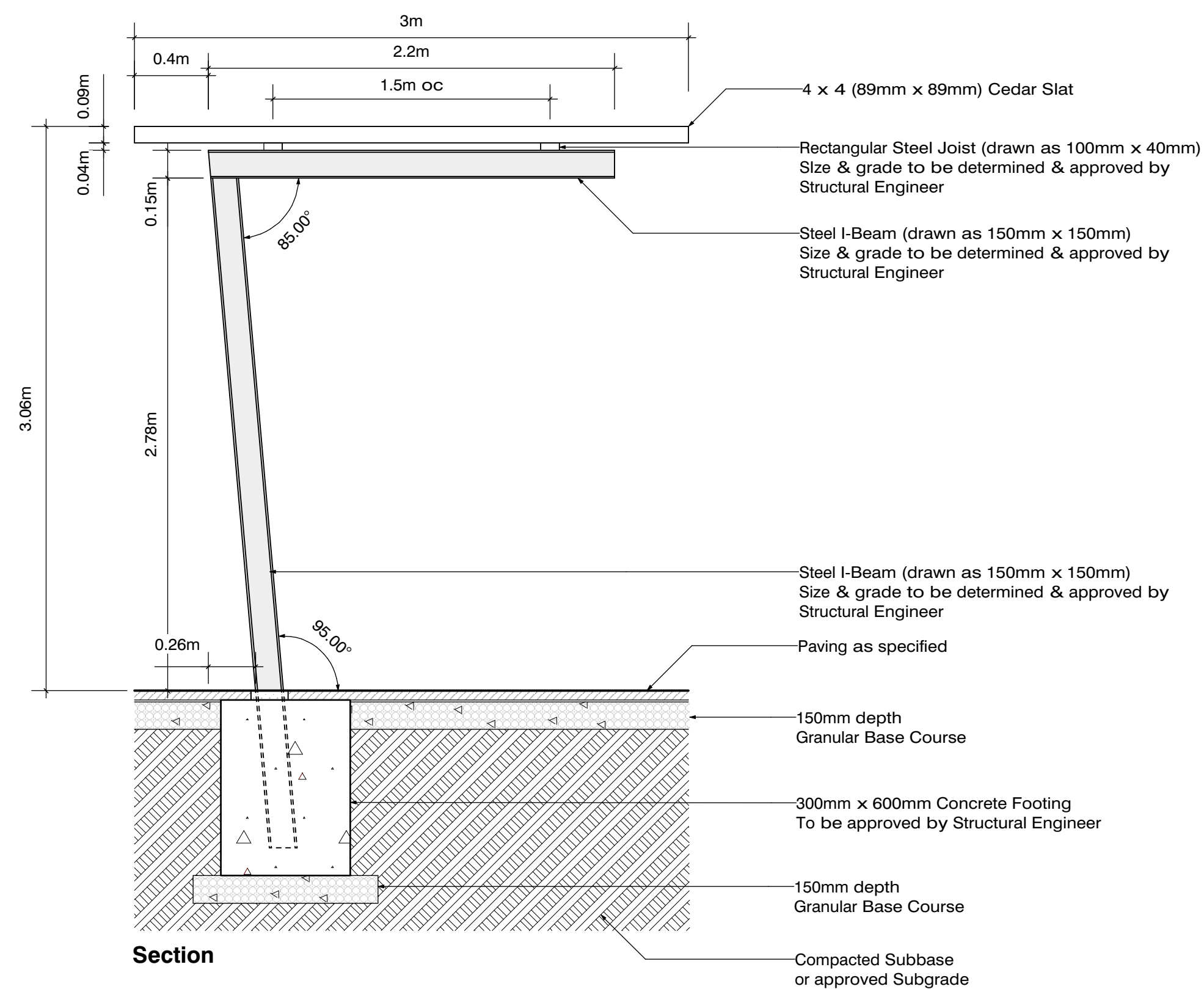

Section

10 Pergola Structure (Post 01)
 Scale: 1:25 Section / Plan

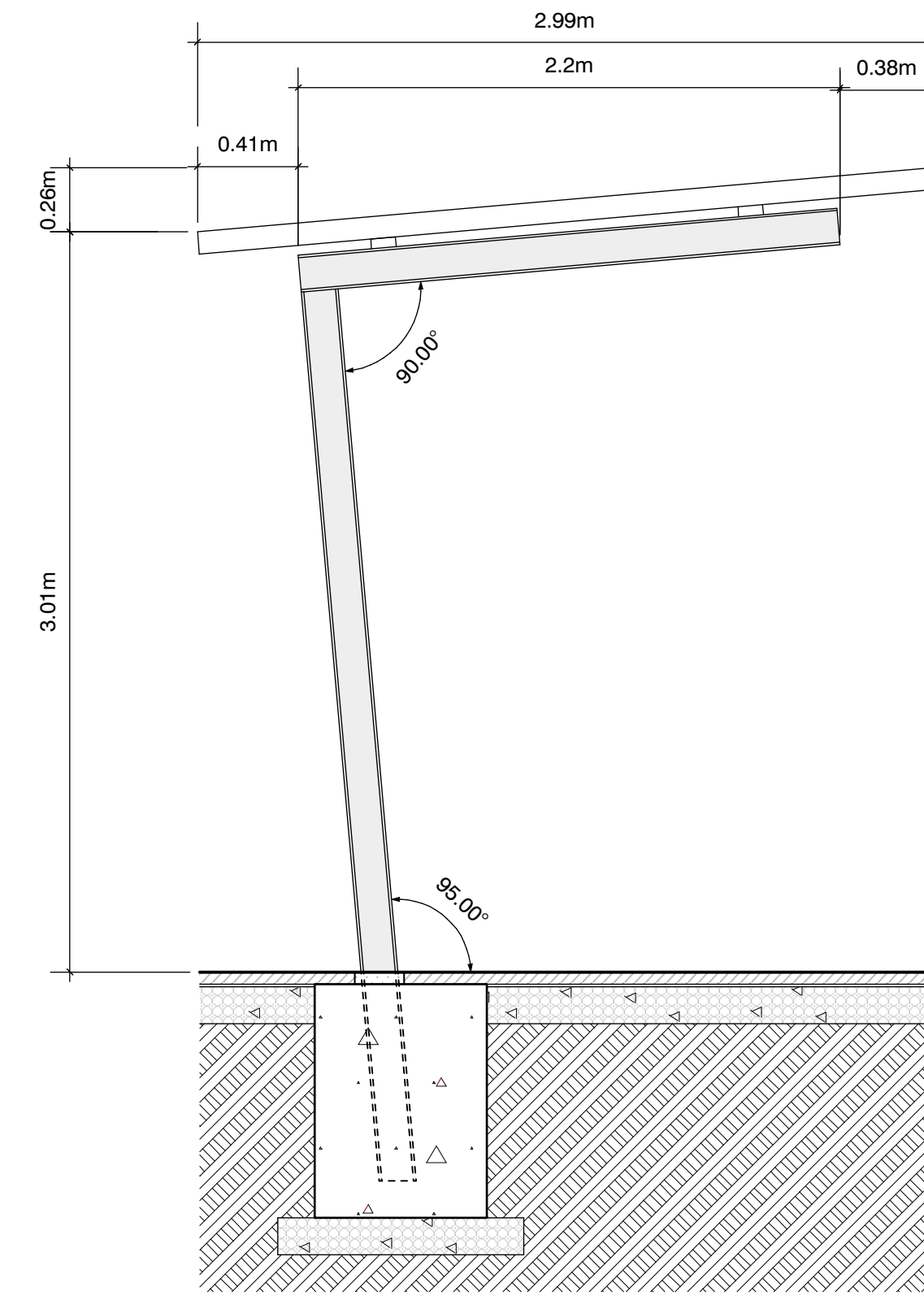

11 Pergola Structure (Post 02)
 Scale: 1:25 Section

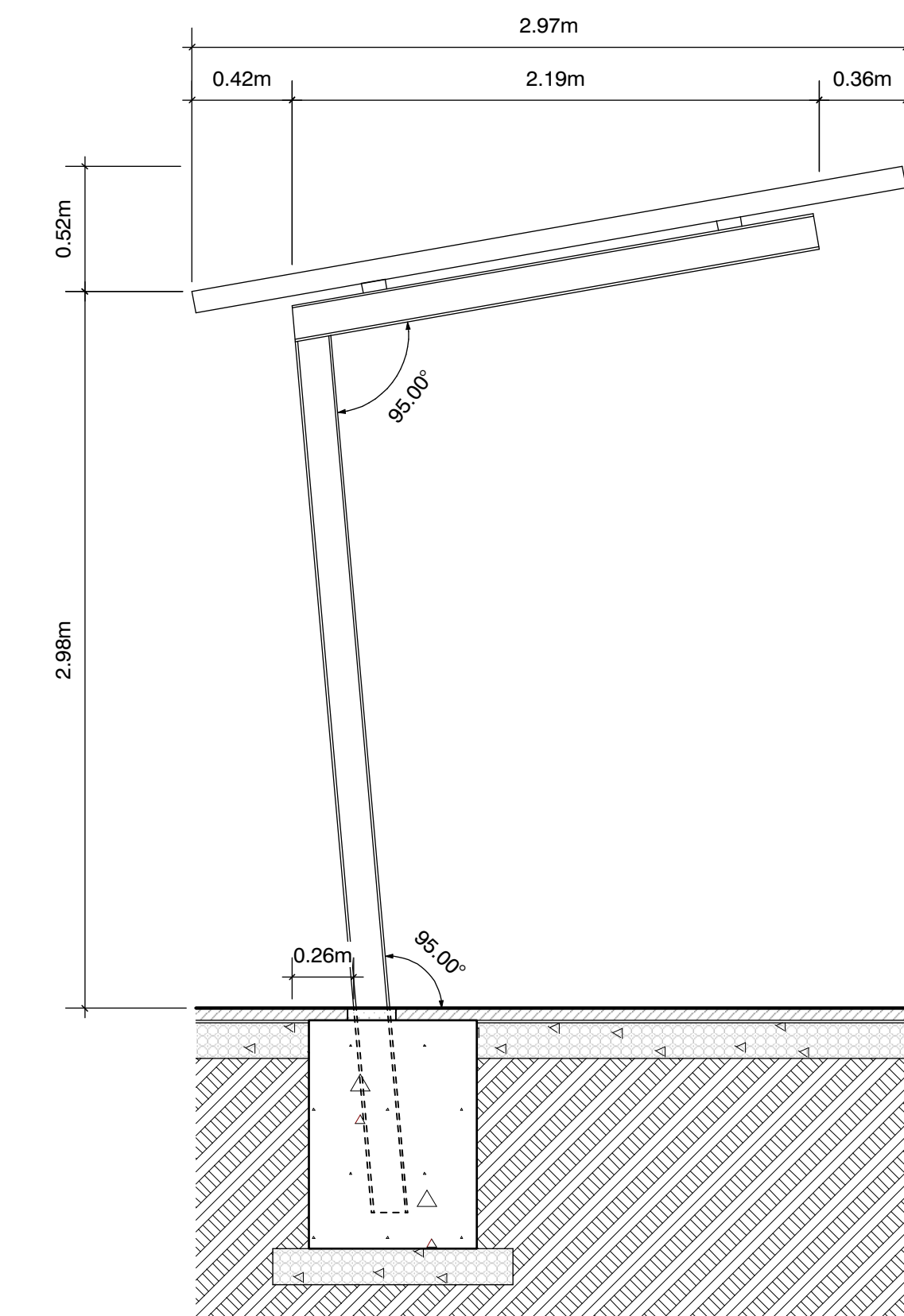

12 Pergola Structure (Post 03)
 Scale: 1:25 Section

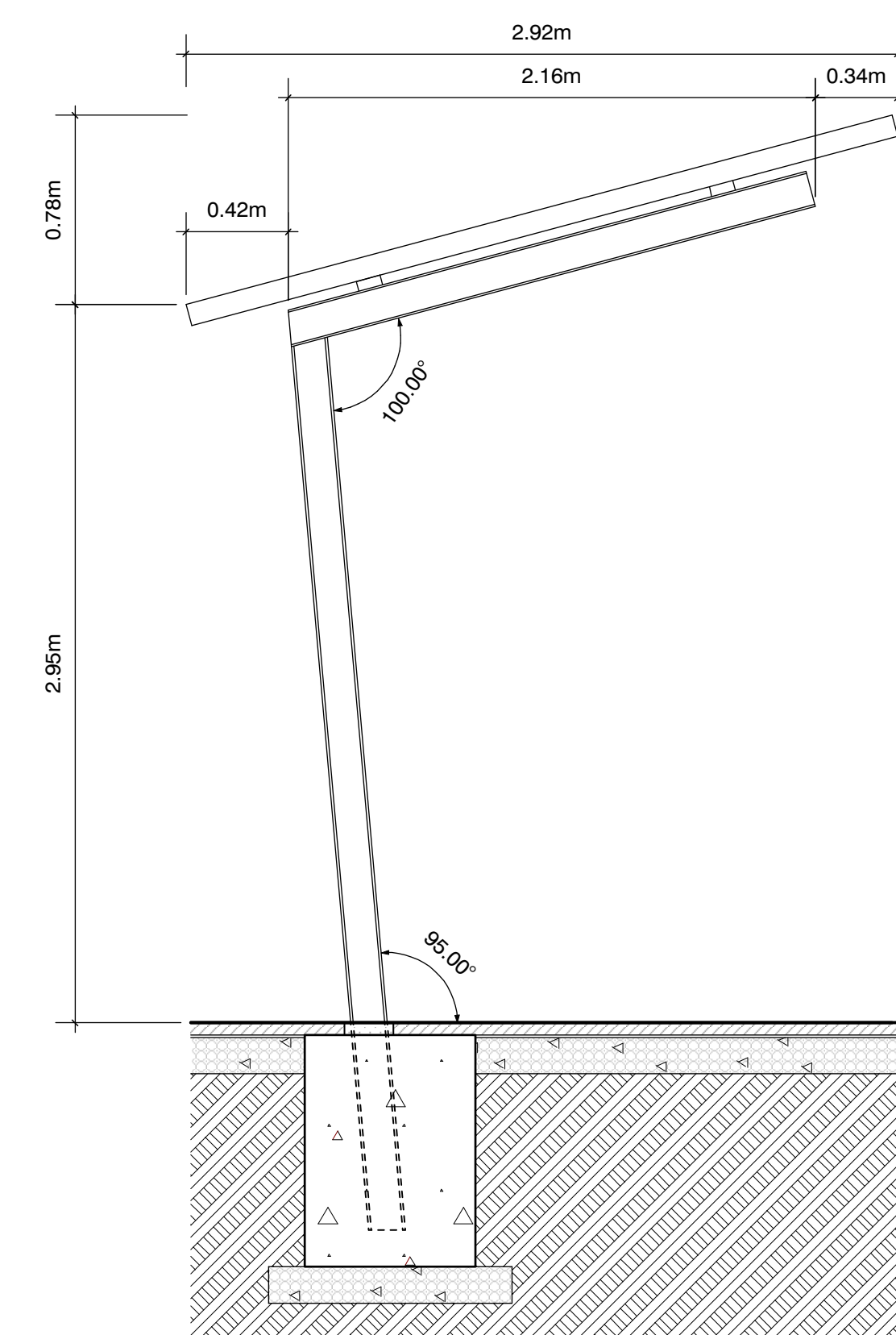

13 Pergola Structure (Post 4)
 Scale: 1:25 Section

NOT FOR CONSTRUCTION

