

ATTACHMENT C SITE PLAN

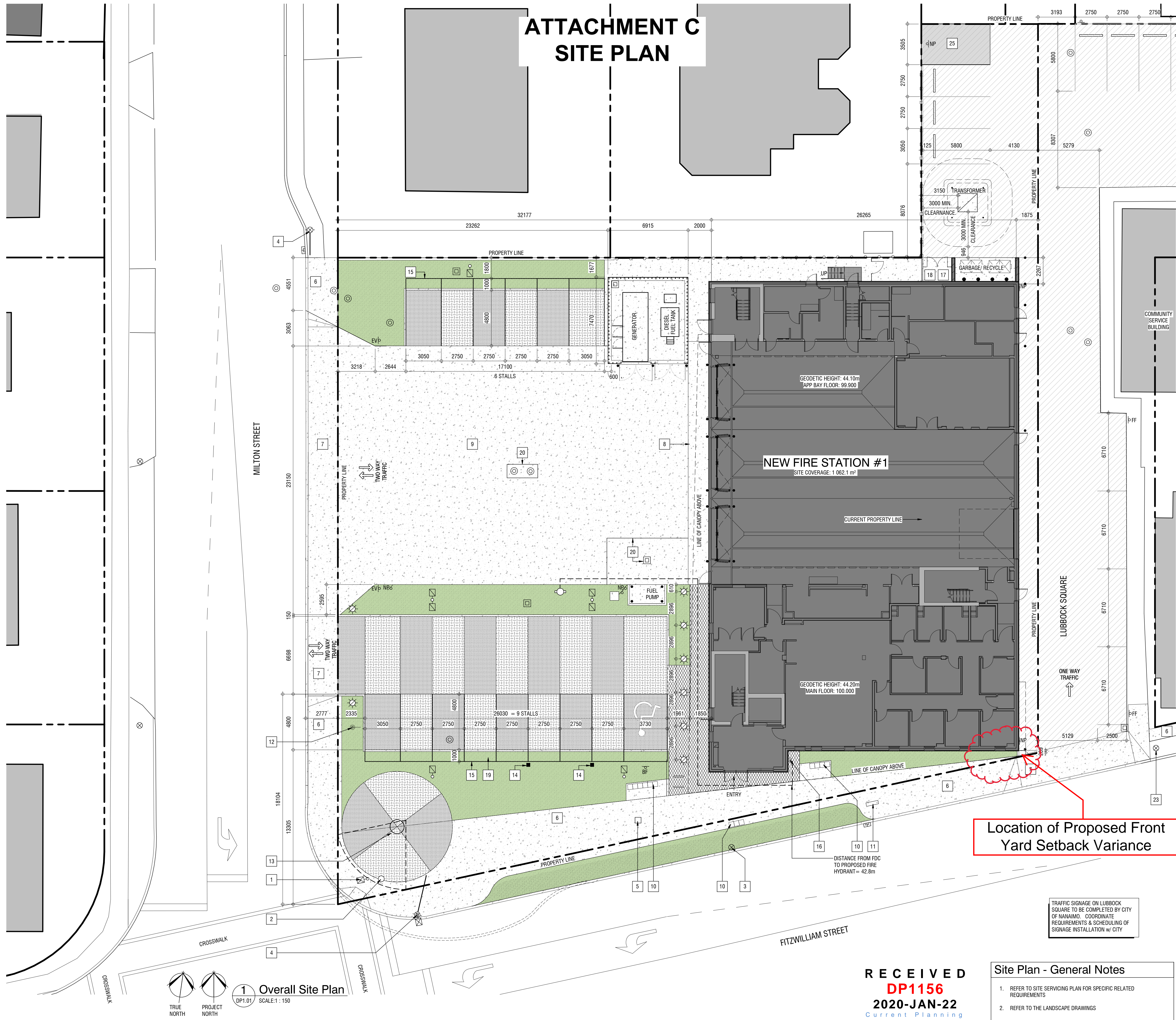

Site Plan - Symbol Legend

- INDICATES EXTENT AND LOCATION OF PROPOSED BUILDING
- INDICATES EXTENT AND LOCATION OF EXISTING BUILDINGS
- INDICATES EXTENT AND LOCATION OF CONCRETE SIDEWALK / TARMAC, REFER TO CIVIL DWGS
- INDICATES EXTENT AND LOCATION OF ASPHALT PAVING SURFACE, REFER TO CIVIL DWGS
- INDICATES EXTENT AND LOCATION OF SOFT LANDSCAPING, REFER TO LANDSCAPE DWGS
- INDICATES EXTENT AND LOCATION OF PAVERS (STYLE 1), REFER TO LANDSCAPE DWGS
- INDICATES EXTENT AND LOCATION OF PAVERS (STYLE 2), REFER TO LANDSCAPE DWGS
- INDICATES EXTENT AND LOCATION OF PAVERS (STYLE 3), REFER TO LANDSCAPE DWGS
- INDICATES EXTENT AND LOCATION OF GRAVEL, REFER TO LANDSCAPE DWGS
- INDICATES PROPERTY LINE (SCALED DOWN FOR CLARITY)
- INDICATES LINE OF CHAIN LINK FENCE
- INDICATES LOCATION OF PROPOSED CATCH BASIN
- INDICATES LOCATION OF EXISTING CATCH BASIN
- INDICATES LOCATION OF PROPOSED MANHOLE
- INDICATES LOCATION OF EXISTING MANHOLE
- INDICATES LOCATION OF PROPOSED FIRE HYDRANT
- INDICATES LOCATION OF BUILDING SIAMESE CONNECTION (FDC)
- INDICATES LOCATION OF PROPOSED TRANSFORMER / PEDESTAL
- INDICATES LOCATION OF PROPOSED LIGHT STANDARD
- INDICATES LOCATION OF EXISTING LIGHT STANDARD
- INDICATES LOCATION OF EXISTING POWER POLE
- INDICATES LOCATION OF EXISTING POWER POLE ANCHOR
- INDICATES LOCATION OF PROPOSED LIGHT BOLLARD
- INDICATES LOCATION OF PROPOSED CAR PLUG POST
- INDICATES LOCATION OF PROPOSED CONCRETE WHEEL STOP
- INDICATES HANDICAP PARKING SYMBOL PAINTED ON ASPHALT SURFACE
- INDICATES PARKING LINE PAINTED ON ASPHALT / CONCRETE
- INDICATES LOCATION OF PROPOSED GUARD BOLLARD
- INDICATES LOCATION OF BIKE RACK
- INDICATES LOCATION OF PROPOSED FLAG POLE
- INDICATES "EMERGENCY VEHICLE NO PARKING" POST MOUNTED SIGNAGE
- INDICATES "BARRIER-FREE PARKING SYMBOL" c/w POLE MOUNTED SIGNAGE
- INDICATES "NO PARKING" POST MOUNTED SIGNAGE
- INDICATES "STOP" POST MOUNTED SIGNAGE
- INDICATES "NO ENTRY" POST MOUNTED SIGNAGE
- INDICATES "NO PARKING FIRE FIGHTERS ONLY" POST MOUNTED SIGNAGE

Site Plan - Code Legend

- 1 EXISTING TRAFFIC LIGHT w/ STREET LIGHT
- 2 EXISTING JUNCTION BOX
- 3 EXISTING UTILITY POLE
- 4 EXISTING UTILITY POLE w/ ANCHOR
- 5 EXISTING UTILITY BOX
- 6 CONCRETE WALKWAY
- 7 CONCRETE WALKWAY LETDOWN
- 8 CONCRETE APRON
- 9 CONCRETE TARMAC
- 10 BENCH TYP.
- 11 BUS STOP BENCH
- 12 FLAG POLE
- 13 PUBLIC ART DISPLAY
- 14 ELECTRIC VEHICLE CHARGER RECEPTACLE
- 15 INDICATES EXTENT OF CAR OVERHANG INTO LANDSCAPED AREA
- 16 FIRE DEPARTMENT CONNECTION (FDC)
- 17 PROPOSED GAS METER LOCATION, c/w SECURE FENCING
- 18 PROPOSED SEISMIC GAS VALVE, c/w SECURE FENCING
- 19 LOW SOFT LANDSCAPING IN VEHICLE BUMPER OVERHANG AREA. REFER TO LANDSCAPE DRAWINGS
- 20 SUMP AREA FOR SPILLED FUEL, CATCHBASIN & SLOPED CONCRETE
- 21 GAS METER CHAINLINK ENCLOSURE
- 22 EXTERIOR STAIR c/w GUARD & HANDRAILS. PAINTED DARK GREY
- 23 RELOCATED POLE. REFER TO CIVIL DRAWINGS
- 24 PAINTED LINES TO DENOTE NO PARKING AREA, AS PER CITY OF NANAIMO STANDARDS

Location of Proposed Front Yard Setback Variance

TRAFFIC SIGNAGE ON LUBBOCK SQUARE TO BE COMPLETED BY CITY OF NANAIMO. COORDINATE REQUIREMENTS & SCHEDULING OF SIGNAGE INSTALLATION w/ CITY

Site Plan - General Notes

1. REFER TO SITE SERVICING PLAN FOR SPECIFIC RELATED REQUIREMENTS
2. REFER TO THE LANDSCAPE DRAWINGS

Overall Site Plan
SCALE: 1:150
DP1.01

RECEIVED
DP1156
2020-JAN-22
Current Planning

2nd Floor, 10805 - 124 Street NW
Edmonton, AB, Canada T5M 0H4
780.784.7100
www.s2architecture.com

SITE PLAN

Nanaimo Fire Station #1 Replacement

618 & 666 FITZWILLIAM STREET, NANAIMO, BRITISH COLUMBIA
City of Nanaimo

2/18/16

NOT FOR CONSTRUCTION

This drawing supercedes previous issues. Do not scale these drawings.

Verify all dimensions, elevations and datums, and report any discrepancies to the Architect prior to construction. Dimensions are taken to face of exterior sheathing, face of concrete block, face of stud for interior partitions, and centreline of demising walls, unless noted otherwise on the drawing.

All drawings remain the property of the Architect. These drawings are Copyright 2020, S2 Architecture. These drawings may not be reproduced without the permission of the Architect.

REVISION	DATE
1 DEVELOPMENT PERMIT	16.08.2019
2 D.P. REVISION	14.01.2020

SCALE: As Indicated
DATE: 1/22/2020 12:39:27 PM
DRAWN BY: NH, MT
CHECKED BY: GJO

DRAWING NO. **DP1.01**

C:\Revit\Projects\218166_A-Base_CD_N\Hardfield.rvt