

**ATTACHMENT B  
PROPOSED PLAN OF SUBDIVISION**

**SKETCH PLAN FOR  
PROPOSED  
SUBDIVISION**

**W. KLIPPERT**

LOT 2, SECTION 19, RANGE 6,  
MOUNTAIN DISTRICT,  
PLAN VIP23911

ADDRESS : 2397 BARCLAY ROAD,  
NANAIMO, V9T 3J8

PROJECT SURVEYOR : D.G. WALLACE

DRAWN BY : D.R.      DATE : OCT. 03/18

OUR FILE : 89226      REVISION : 1



**J.E. ANDERSON  
& ASSOCIATES**  
SURVEYORS - ENGINEERS

1A - 3411 SHENTON ROAD, NANAIMO, B.C. V9T 2H1  
TEL: 250 - 758 - 4631 FAX: 250 - 758 - 4660  
E-MAIL : nanaimo@jeanderson.com  
NANAIMO - VICTORIA - PARKSVILLE - CAMPBELL RIVER

**LEGEND**

ALL DIMENSIONS ARE IN METRES

SUBJECT TO CHARGES SHOWN  
ON TITLE NO. CA6614277  
(P.I.D. 002-926-792)

DIMENSIONS ARE DERIVED FROM  
LAND TITLE OFFICE RECORDS

THIS PLAN HAS BEEN PREPARED IN  
ACCORDANCE WITH THE PROFESSIONAL  
REFERENCE MANUAL

EXISTING BUILDING TO BE REMOVED



The intended plot size of this plan is 432mm in width by 280mm in height, B size, when plotted at a scale of 1:300.

PLAN VIP39458  
B

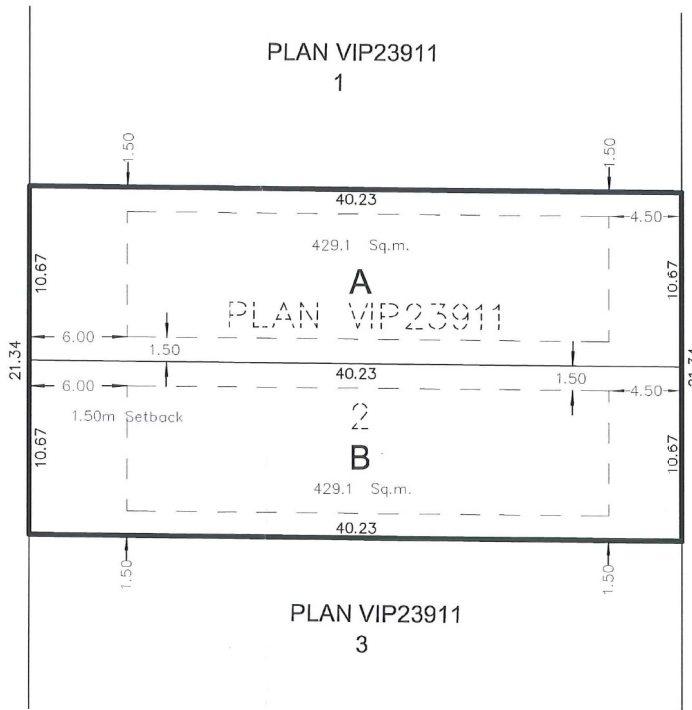

BARCLAY ROAD

