

ATTACHMENT A
LOCATION PLAN

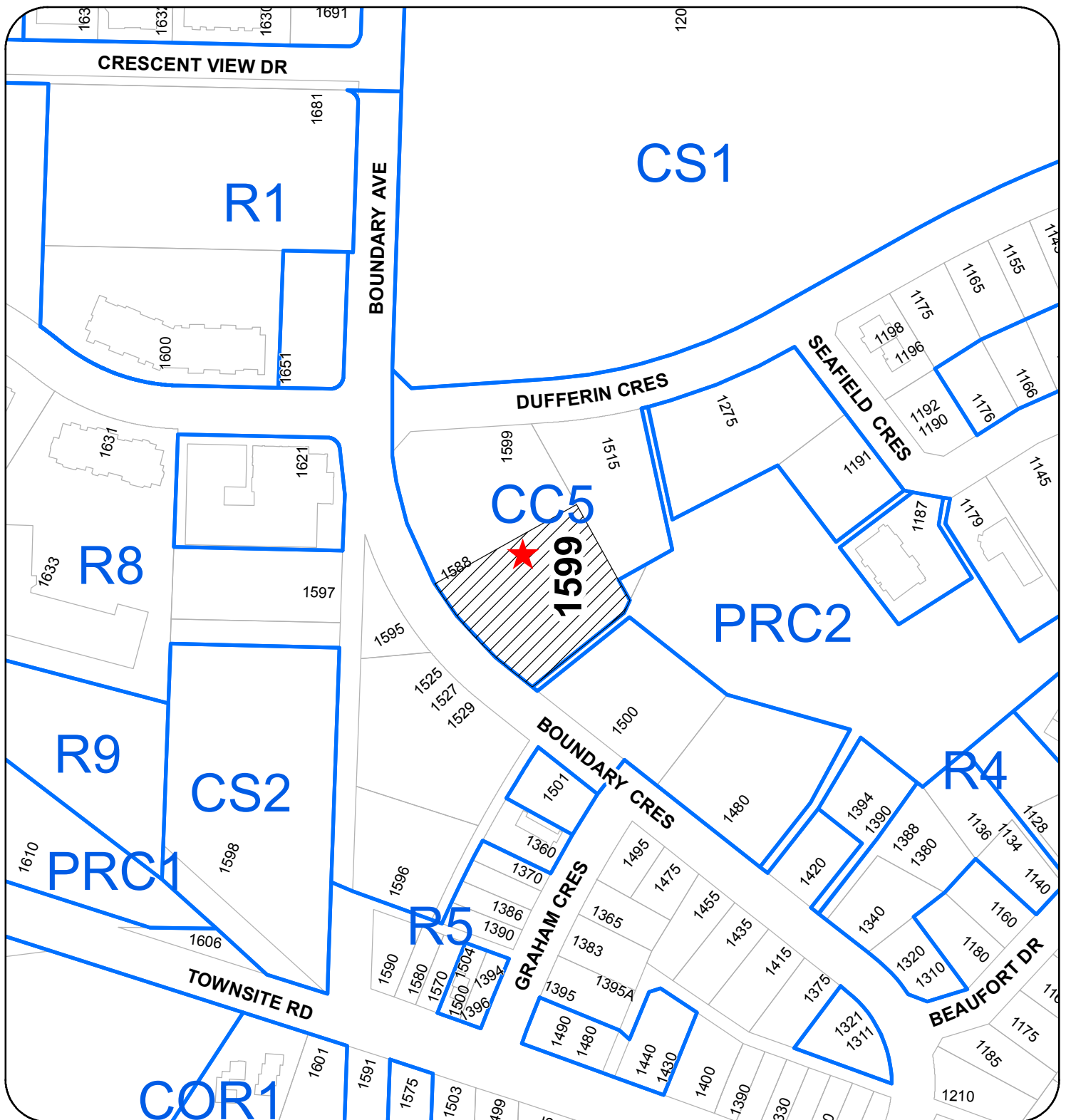

REZONING APPLICATION NO. RA000410
LOCATION PLAN



Subject Property



Proposed CRS Location

Civic: 1599 DUFFERIN CRESCENT
Legal: LOT 1, DISTRICT LOT 97G,
NEWCASTLE RESERVE, SECTION 1,
NANAIMO DISTRICT, PLAN 27521