

ATTACHMENT A PERMIT TERMS AND CONDITIONS

TERMS OF PERMIT

The City of Nanaimo "ZONING BYLAW 2011 NO. 4500" is varied as follows:

1. *Section 6.5.2 Projections into Yards* – to allow a heat pump to be located to the front of the principal single family dwelling.

CONDITIONS OF PERMIT

1. The heat pump shall be located in substantial compliance with the Site Plan received 2018-SEP-25, as shown on Attachment C.

ATTACHMENT B
LOCATION PLAN

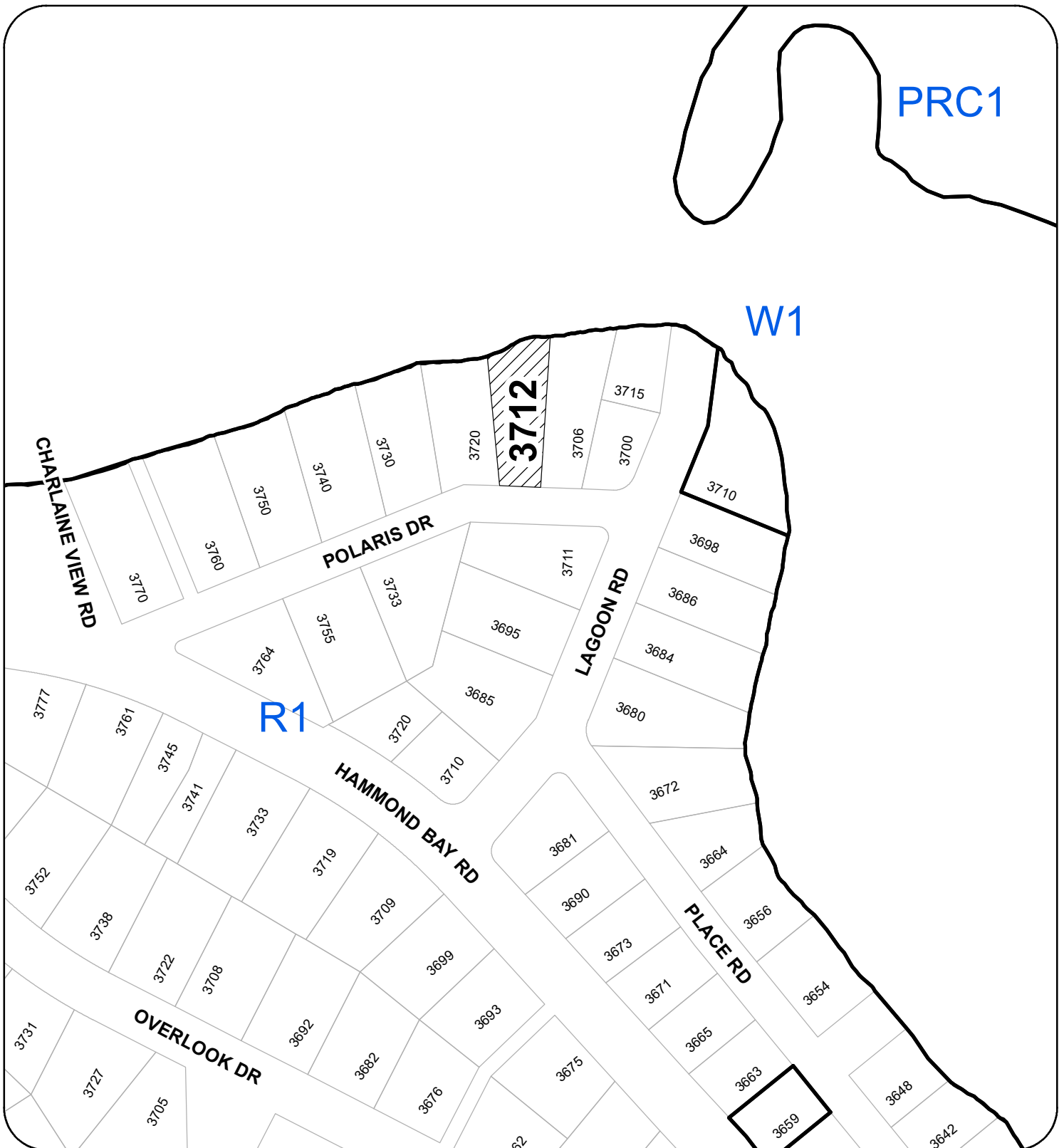

N



DEVELOPMENT VARIANCE PERMIT NO. DVP00366

LOCATION PLAN



Subject Property

Civic: 3712 POLARIS DRIVE
Legal Description: LOT 1, DISTRICT LOT 39
WELLINGTON DISTRICT, PLAN 32002

ATTACHMENT C SITE PLAN

Site Plan showing:
Lot 1, District Lot 39,
Wellington District, Plan 32002.

Client: Harris

Civic Address: 3712 Polaris Drive, Nanaimo

File: 17-023

Scale: 1:250

Date: June 29th, 2018

Drawn by: DRW

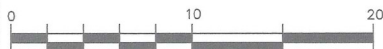
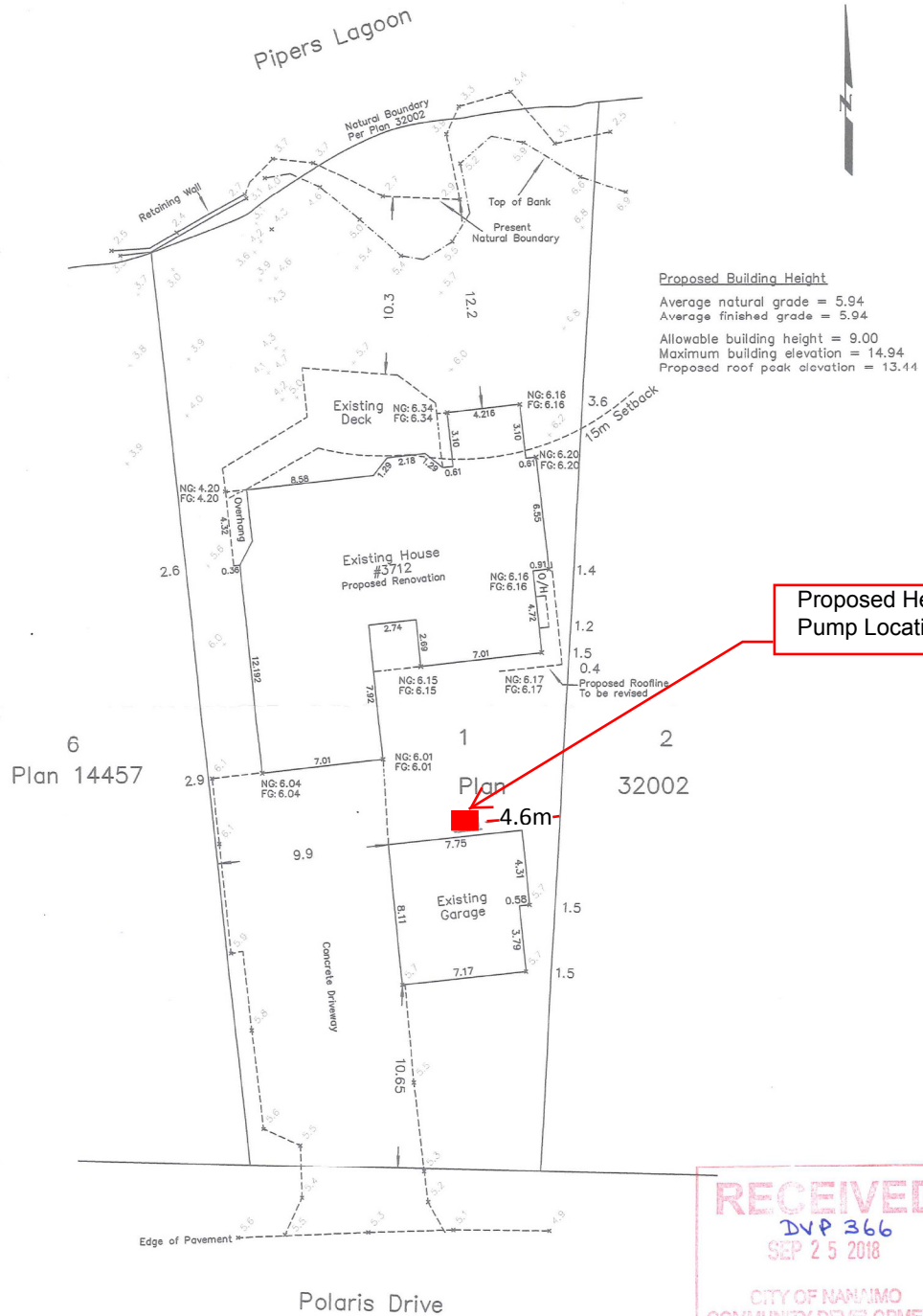

Scale 1:250
 Distances and elevations are in metres.
 Geodetic elevations are derived from control monument 90H6361.

Polaris Drive

Note:
 This property is affected by
 the following registered documents:
 M76300.

Turner & land surveying™

250.753.9778
 605 Comox Road
 Nanaimo, BC V9R 3J4

Certified correct this 29th day of June, 2018.

B.C.L.S.

(This document is not valid unless originally signed and sealed.)

ATTACHMENT D
AERIAL PHOTO



DEVELOPMENT VARIANCE PERMIT NO. DVP00366