

Project Rationale



Single Lane Wooden
Trestle Currently the
only access to the
Port Lands



Project Scope

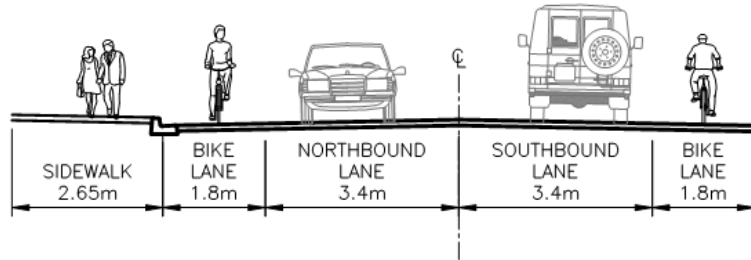

Front Street Connection

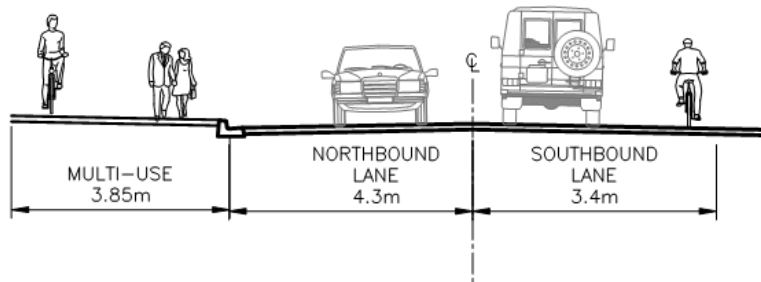

Port Way Upgrade



Project Budget

Design & Project Management - \$213,652 (2018)

Front Street Connection - \$900,000 (2018)

Port Way Upgrades - \$900,000 (2018)

Storm Sewer Upgrades - \$600,000 (2019)

Interim Walkway - \$1,000,000 (2018- Grant)

Total - \$3,613,652



Preliminary Design Renderings

South Downtown Waterfront

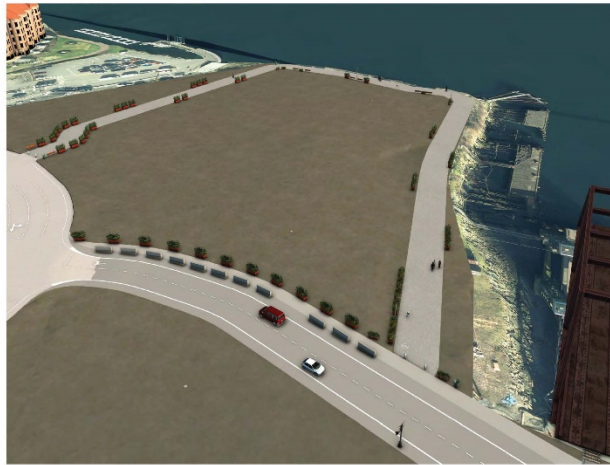
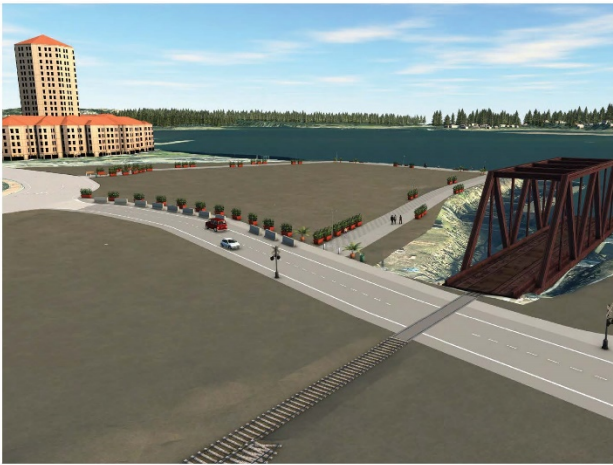

SECTION 5

South Downtown Waterfront BC Ferries Terminal to Nanaimo Port Authority



Issues

Nanaimo Port Authority to connect walkway to NPA land and cruise ship terminal / Helijet
Coordinate walkway with Front Street extension

Coordinate with BC Ferries to develop safe walkway crossing through Gabriola Ferry Terminal as part of future terminal upgrades

Design of a safe walkway across tracks at rail loading ramp required and to be coordinated with Front Street extension and Rail Authority

Considerations

Nanaimo Waterfront Walkway alignment to be coordinated with Secondary Access Study and Front Street Extension

Future – Secondary Access at Farquhar



CONCEPT RENDERINGS AND DETAILS

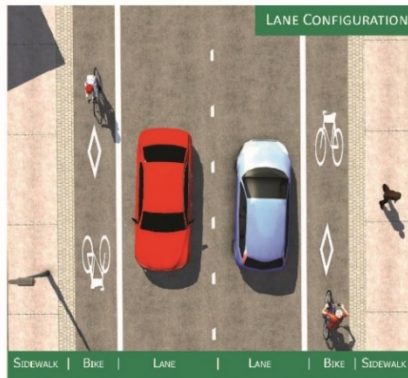

BENEFITS

- PROVIDES MAXIMUM BENEFIT FOR REDEVELOPMENT OF LANDS OWNED BY SFN, NPA AND CP RAIL
- LEAST EXPENSIVE OPTION WITH NO OVERPASS REQUIRED
- FARQUHAR STREET IS LARGELY INDUSTRIAL LAND BASE AT PRESENT

CONSIDERATIONS

- REQUIRES NEW SIGNALIZED INTERSECTION AND TURN LANES AT NICOL STREET AND FARQUHAR STREET
- FARQUHAR STREET NEEDS TO BE REDESIGNED
- LIMITED IMPACT ON RAIL OPERATIONS



Future Plans



Port Drive Waterfront Master Plan
Adopted by Council June 18, 2018



SECTION C-C
PORT DRIVE

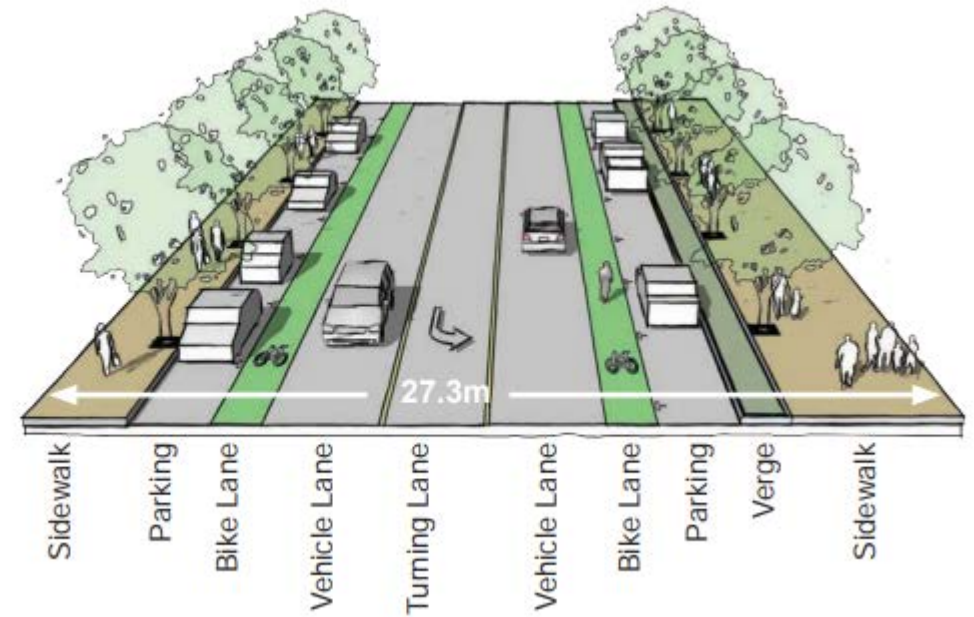

Future Road Cross Section