

**AGENDA FOR THE REGULAR MEETING OF THE  
PARKS, RECREATION AND CULTURE COMMISSION  
TO BE HELD IN THE BOWEN PARK COMPLEX CONFERENCE ROOM  
WEDNESDAY, 2009-JUN-24, COMMENCING AT 7:00 P.M.**

---

1. **CALL THE REGULAR MEETING OF THE PARKS, RECREATION AND CULTURE COMMISSION TO ORDER:**
2. **INTRODUCTION OF LATE ITEMS:**
3. **ADOPTION OF AGENDA:**
4. **ADOPTION OF MINUTES:**

- (a) Minutes of the Regular Parks, Recreation and Culture Commission Meeting held Wednesday, 2009-MAY-27, at 7:00 p.m. in the Bowen Park Complex Conference Room.

*Pg. 450-457*

*Motion to adopt minutes of 2009-MAY-27.*

5. **PRESENTATIONS:**
6. **DELEGATIONS: (10 MINUTES)**

*Motion to receive the following delegations:*

- (a) Mr. Bill Merilees, Chair, Buttertubs Marsh Liaison Committee, 3205 Granite Park, Nanaimo, B.C., V9T 3C8, requesting that the Parks, Recreation and Culture Commission and the City of Nanaimo:

*Pg. 458*

- (i) actively assist the Buttertubs Marsh Liaison Committee with the acquisition of the BC Transportation and Finance Authority property at 1996 Jingle Pot Road, Nanaimo, B.C.; and,
    - (ii) enact the appropriate legislation enabling the enforcement of the Buttertubs Management Plan (notably, "No Dogs" and "No Bicycles") on the trail at Buttertubs West nature park at 1780 Jingle Pot Road, Nanaimo, B.C.

- (b) Mr. Ian Niamath and Mr. Paul Fudge on behalf of the Nanaimo Art Gallery, 150 Commercial Street, Nanaimo, B.C., V9R 5G6, updating the Parks, Recreation and Culture Commission on the Nanaimo Art Gallery's vision and plans for a new Civic/Municipal Art Gallery for Nanaimo.

*Pg. 459-466*

- (c) Mr. Don Rinald, 6 Maki Road, Nanaimo, B.C. V9R 6N7, on behalf of the Nanaimo Rowing Club / Canoe & Kayak Club, requesting that the Parks, Recreation and Culture Commission hold a public consultation process to discuss the location and design proposed for the boathouse at Loudon Park.

*Pg. 467*

- (d) Mr. Jim Harris, 173 Colvilleton Trail, Nanaimo, B.C., V9R 6R1 representing the Douglas Island Garden Society seeking permission from the Parks, Recreation and Culture Commission to build and manage nine (9) allotment beds as part of their community garden project. Pg. 468-473
- (e) Mr. David Essig, 7 Captain Kidds Terrace, Nanaimo, B.C., V9R 6R1 speaking in support of the application by the Douglas Island Garden Society for permission from the Parks, Recreation and Culture Commission to construct and operate an allotment garden on a portion of the parkland on Protection Island now designated and operated as a community garden. Pg. 474-476
- (f) Mr. Jim Irvine, 196 Captain Morgan's Boulevard, Nanaimo, B.C., V9R 6R1, speaking in favour of the allotment beds and providing a powerpoint presentation to the Parks, Recreation and Culture Commission which will review perceived, potential, and/or real problems associated with the proposal to have allotment beds as a component of the Community Garden on Protection Island. Pg. 477-485
- (g) Mrs. Linda Irvine, 196 Captain Morgan's Boulevard, Nanaimo, B.C., V9R 6R1, speaking in favour of the allotment beds providing a summary of comments on the allotment beds to the Parks, Recreation and Culture Commission. Pg. 486

*Staff's Recommendation: That the Parks, Recreation and Culture Commission approve the request by the Douglas Island Garden Society to add nine allotment beds within the existing Community Garden area on Protection Island.*

**LATE DELEGATIONS: (5 MINUTES)**

**7. CHAIRMAN'S REPORT:**

- (a) Neck Point Park Addition

**8. REPORTS OF ADVISORY BODIES:**

- (a) **Parks Committee.** No meeting held.
- (b) **Recreation Committee.** No meeting held.
- (c) **Cultural Committee.** No meeting held.
- (d) **Grants Advisory Committee.** No meeting held.
- (e) **Plan Nanaimo Advisory Committee.** Commissioner Lance - Monthly report for MAY, 2009.

- (f) **Social Planning Advisory Committee.** Commissioner Johnstone - Monthly report for MAY, 2009. Pg.487-489
- (g) **Port Theatre.** Monthly report for May, 2009. Pg. 490
- (h) **Nanaimo Art Gallery.** Monthly report for May, 2009. Pg. 491-493
- (i) **Nanaimo District Museum.** Monthly report for May, 2009.

*Motion to receive all Advisory Body reports.*

9. **STAFF REPORTS:**

- (a) **EJ Hughes Copyright Agreement** Pg. 494  
*Staff's Recommendation: That the Parks, Recreation and Culture Commission receives the Report.*
- (b) **Draft Beban Park Facility Redevelopment Concept Plan** Pg. 495-507  
*Staff's Recommendation: That the Parks, Recreation and Culture Commission hold an open house and forward the DRAFT Beban Park Facility Redevelopment plan for public review and comment.*
- (c) **Community Gardens Policy** Pg. 508-511  
*Staff's Recommendation: That the Parks, Recreation and Culture Commission adopt the Community Gardens Policy.*

10. **INFORMATION ONLY ITEMS (Staff reports):**

- (a) Cultural Capital – Final Report (DVD & Verbal presentation) – Bob Kuhn and Camela Tang.
- (b) Monthly Report – Senior Manager of Parks. Pg. 512-515
- (c) Monthly Report – Senior Manager of Recreation and Culture Services. Pg. 516-520

*Motion to receive all Information Items.*

11. **CORRESPONDENCE: (Action Required) - None**

**CORRESPONDENCE: (Information)**

- (a) Minutes of the Nanaimo Harbour City Seniors, Board of Directors, Meeting held 2009-JUN-12. Pg. 521-523

*Motion to receive all Correspondence.*

12. **NOTICE OF MOTION:**

13. **CONSIDERATION OF OTHER BUSINESS:**

- (a) "Gardens for Good" Opening – Commissioner Fred Pattje
- (b) B.C.R.P.A. Symposium – Commissioner Dawn Burnett
- (c) PRCC Capital Budget Review Seminar – R. Harding

14. **BUSINESS ARISING FROM DELEGATIONS:**

- (a) **Mr. Bill Merilees - Chair, Buttertubs Marsh Liaison Committee.**
- (b) **Mr. Ian Niamath and Mr. Paul Fudge - Nanaimo Art Gallery.**
- (c) **Mr. Don Rinald - Nanaimo Rowing Club / Canoe & Kayak Club.**
- (d) **Mr. Jim Harris – Protection Island Community Gardens.**
- (e) **Mr. David Essig - Protection Island Community Gardens.**
- (f) **Mr. Jim Irvine - Protection Island Community Gardens.**
- (g) **Mrs. Linda Irvine - Protection Island Community Gardens.**

*Staff's Recommendation: That the Parks, Recreation and Culture Commission approve the request by the Douglas Island Garden Society to add nine allotment beds within the existing Community Garden area on Protection Island as per the Community Gardens Policy.*

15. **UNFINISHED BUSINESS:**

- (a) Beban Park Complex Feasibility Study Report – staff report.
- (b) E.J. Hughes Mural – Copyright & Image Production used on promotional material, and sold by the City of Nanaimo, with proceeds going to Art in Public Places.
- (c) Mosaic Mural Proposal – verbal update - R. Harding.
- (d) Bowen Park Zoning - Staff Report.

*Motion to remove Item 15.(a), 15.(b), and 15.(c) from "Unfinished Business".*

16. **QUESTION PERIOD:**

17. **ADJOURNMENT:**

*Motion to adjourn with next meetings as follows:*

COMMISSION	Wednesday, 2009-JUL-22; 7:00 p.m. Bowen Park Complex Conference Room
Cultural Committee	Wednesday, 2009-JUL-08; 4:15 p.m. Bowen Park Complex Conference Room
Recreation Committee	Wednesday, 2009-SEP-09; 4:00 p.m. – if required Bowen Park Complex Conference Room
Parks Committee	Thursday, 2009-JUL-09; 5:00 p.m. – if required Bowen Park Complex Conference Room

**MINUTES OF THE REGULAR MEETING OF THE  
PARKS, RECREATION AND CULTURE COMMISSION  
HELD IN THE BOWEN PARK COMPLEX CONFERENCE ROOM  
ON WEDNESDAY, 2009-MAY-27, COMMENCING AT 7:00 P.M.**

---

PRESENT: Commissioner L. McNabb, Chair

Members: Commissioner F. Pattje  
Commissioner S. Lance  
Commissioner G. Rudischer  
Commissioner J. Cowling  
Commissioner B. Sparkes

Regrets: Commissioner D. Johnstone  
Commissioner L. Avis  
Commissioner D. Burnett  
Commissioner M. Young  
Commissioner B. Dempsey  
Commissioner B. Meunier

Staff: R. Harding J. Ritchie  
R. Tweed, recording

Regrets: S. Samborski

1. CALL THE OPEN MEETING TO ORDER:

The Regular Meeting was called to order at 7:00 p.m.

2. INTRODUCTION OF LATE ITEMS:

- Correction to Agenda – Item 8.(d) – Grants Advisory Committee (Note: due to absence, Commissioner Burnett has submitted a written report with a synopsis of the Grants Advisory Committee meeting held 2009-MAY-13.)
- Delete Item 6.(a) – Delegations – Mr. Bill Merilees regarding 1996 Jingle Pot Road, Nanaimo, and 1780 Jingle Pot Road, Nanaimo. (Note: Mr. Merilees is unable to attend the 2009-MAY-27 meeting as scheduled and has requested that this item be added to the 2009-JUN-24 agenda.)
- Add Item 11.(e) – Correspondence (Information) - Minutes of the Nanaimo Harbour City Seniors, Annual General Meeting held 2009-MAY-20.
- Note – Item 17. – Adjournment – next meeting of the Cultural Committee to be held 2009-JUL-08 (note: meeting scheduled for 2009-JUN-03 cancelled.)

3. ADOPTION OF AGENDA:

It was moved and seconded that the Agenda, as amended, be adopted. The motion carried unanimously.

4. ADOPTION OF MINUTES:

- (a) Minutes of the Regular Parks, Recreation and Culture Commission Meeting held Wednesday, 2009-APR-22, at 7:00 p.m. in the Bowen Park Complex Conference Room.

It was moved and seconded that the Minutes be adopted as circulated. The motion carried unanimously.

5. PRESENTATIONS:

6. DELEGATIONS:

It was moved and seconded that the Delegation be permitted to address the Commission. The motion carried unanimously.

- (a) Mr. Ryan Hudson, 3777 Long Lake Terrace, Nanaimo, B.C., V9T 2V2, requesting that the Parks, Recreation and Culture Commission allocate funds to upgrade the Bowen Park Disc Golf Course in order to meet the criteria for the 2009 British Columbia Disc Golf Championship (to be held September 2009).

Mr. Hudson provided an overview of the current course and their request for funds to provide basic maintenance and to improve the course.

It was moved and seconded that the Parks, Recreation and Culture Commission allocate up to \$10,000 from the 2009 V.I.P capital budget to build 36 new tee pads and a new disc golf course map kiosk. The motion carried unanimously.

It was moved and seconded that the Parks, Recreation and Culture Commission direct staff to work with the Nanaimo Disc Golf Association on the proposed project. The motion carried unanimously.

7. CHAIRMAN'S REPORT:

- (a) Council Update.

Council referred the question of zoning for Bowen Park to the Parks, Recreation and Culture Commission (PRCC).

Staff Recommendation: That the Parks, Recreation and Culture Commission refer the matter of the question of zoning for Bowen Park to Staff for review and reporting back to the Commission at their next regular meeting to be held on Wednesday, 2009-JUN-24.

Staff provided an overview of the Parks Zoning issues that have been before Council and have now passed third reading.

It was moved and seconded that the recommendation be adopted. The motion carried unanimously.

8. REPORTS OF ADVISORY BODIES:

- (a) Parks Committee. Commissioner Sparkes reported on the meeting held 2009-MAY-14.

Potential Dog Off-Leash Parks In Nanaimo

*Parks Committee's Recommendation: That the Parks, Recreation and Culture Commission proceed with a public review and input process to consider dog off-leash sites at various locations, including Beach Estates, Departure Bay.*

It was moved and seconded that the recommendation of the Parks Committee be adopted. The motion carried unanimously.

- (b) Cultural Committee. Commissioner Pattle reported on the meeting held 2009-MAY-06, on behalf of the Chair, Eveline O'Rourke.

Musical & Dance Heritage of Vancouver Island & Heroes and Heroines Mosaic Murals - Mosaic Mural Proposal in the Gusola Block

*Cultural Committee's Recommendation: That the Parks, Recreation and Culture Commission recommend that Council support a single mosaic from the "Musical & Dance Heritage of Vancouver Island & Heroes and Heroines Mosaic Murals" in principal, with support by way of ongoing maintenance and provision of installation location, with location to be determined at a later date dependant on the subject matter, in lieu of cash funding being provided by the City of Nanaimo.*

It was moved and seconded that the recommendation of the Cultural Committee be adopted. The motion carried unanimously.

- (c) Recreation Committee. Commissioner Lance reported on the meeting held 2009-MAY-20, in the absence of the Chair, Commissioner Diana Johnstone.

Commissioner Diana Johnstone was nominated and appointed as Chair of the Recreation Committee.



2009 Tournament and Festival Fund Grants

*Recreation Committee's Recommendation: That the Parks, Recreation and Culture Commission recommend that Council approve the following 2009 Tournament and Festival Grant requests:*

ORGANIZATION	2008 Approved	2009 Requested	2009 Recommended
Canadian Body Painting Festival Society	\$1,800	\$6,250	\$500
Coaltown Festival Society *	n/a	\$2,500	\$2,000
Nanaimo Blues Society	\$1,500	\$1,500	\$750
Nanaimo Canada Day Committee	n/a	\$2,000	\$1,500
Nanaimo Disc Golf *	n/a	\$2,000	\$2,000
Nanaimo Riptides Swim Team	\$1,200	\$1,500	\$1,500
Nanaimo Senior Men's Baseball Club *	n/a	\$1,893.75	\$1,000
Nanaimo Skating Club	n/a	\$2,500	\$1,500
Nanaimo White Rapids Swim Club (Invitational Meet)	\$1,500	\$1,500	\$750
Nanaimo White Rapids Swim Club (Regional Meet) *	n/a	\$1,500	\$1,000
Rockin' Rollers Power Soccer Club *	n/a	\$1,600	\$630
Vancouver Island Exhibition Association – Teen Skateboard Competition *	n/a	\$5,050	\$1,500
Vancouver Island Red Raiders Football Society	n/a	Not noted.	Denied.
Vancouver Island Region Swimming Association	n/a	\$3,500	Denied.
WPVL – Nanaimo Breakers *	\$900	\$3,000	\$1,500
Nanaimo Art Gallery Society – Festival of Banners	\$1,700	\$7,500	\$750
Nanaimo Child Development Centre Society	n/a	\$1,500	\$1,000
Nanaimo African Heritage Society	n/a	Not received.	Denied.
* new event			
<b>TOTALS:</b>		<b>\$45,293.75</b>	<b>17,880.00</b>

It was moved and seconded that the recommendation of the Recreation Committee be adopted. The motion carried unanimously.

Further discussion of the 2009 Tournament and Festival Grants involved a reconsideration of the request from the Vancouver Island Region Swimming Association.

It was moved and seconded that the Parks, Recreation and Culture Commission recommend that Council approve, in addition to the previously listed 2009 Tournament and Festival Grant requests, an allocation in the amount of \$1,500 to the Vancouver Island Region Swimming Association.

Commissioner Lance raised the issue of overlapping criteria for grants between the various committees and further discussion resulted in the following motion:

It was moved and seconded that Staff return to the Commission with a report regarding the funding criteria utilized by the various Committees in order to reduce or eliminate overlap.

- (d) Grants Advisory Committee. Commissioner Burnett absent; however, provided a brief, written report on the meeting held 2009-MAY-13.
- (e) Plan Nanaimo Advisory Committee. Commissioner Lance provided the monthly report for April, 2009.
- (f) Social Planning Advisory Committee. Commissioner Cowling reported on the meeting held 2009-MAY-05. Items of interest were: the chair of the committee is now Councillor Jim Kipp - the committee is unable to change the chair without an amendment to SPAC's terms of reference; he was absent and Zeni Maartman was the acting chair; the emerging issue of storage for fresh and frozen foods for distribution, i.e. a warehouse or facility, was discussed; and, the Committee supports the draft Municipal Support Policy for affordable housing.
- (g) Port Theatre. Monthly report for April, 2009.
- (h) Nanaimo Art Gallery. Monthly report for April, 2009.
- (i) Nanaimo District Museum. Monthly report for April, 2009.

It was moved and seconded that the Advisory Body reports be received. The motion carried unanimously.

9. STAFF REPORTS

- (a) **Travel Assistance Application From the Nanaimo Minor Hockey Association – Bantam Clippers**

*Staff's Recommendation:* That the Parks, Recreation and Culture Commission recommend that Council not approve the application for a Travel Assistance Grant for the Nanaimo Minor Hockey Association (N.M.H.A.) – Bantam Clippers in the amount of \$1,000.00.

It was moved and seconded that the recommendation be adopted. The motion carried unanimously.

(b) **Travel Assistance Application From the Wellington Secondary Band**

Staff's Recommendation: That the Parks, Recreation and Culture Commission recommend that Council approve the application for a Travel Assistance Grant for the Wellington Secondary Band in the amount of \$2,000.00.

It was moved and seconded that the recommendation be adopted. The motion carried unanimously.

(c) **Bowen Park Disc Golf Course Improvements**

Staff's Recommendation: That the Parks, Recreation and Culture Commission:

- 1) allocate up to \$10,000 from the 2009 V.I.P capital budget to build 36 new tee pads and a new disc golf course map kiosk; and,
- 2) direct staff to work with the Nanaimo Disc Golf Association on the proposed project.

Note: motions on this matter were made under Section 6.(a).

10. **INFORMATION ONLY ITEMS (staff reports):**

- (a) Senior Manager of Parks. Monthly report for April, 2009. By 2009-JUN-04 Marfeo Sutton Park should be 75% open, and by 2009-JUN-19 will be fully open. Canada Day, 2009-JUL-01 will be the official opening. Totems in Bowen Park are now testing. Raines Cabin has been dismantled and has been moved to the Raines family site. Approximately \$2,000 in funding was provided by the City for this relocation. Deverill Water Park will be open 2009-JUN-15.

- (b) Senior Manager of Recreation and Culture Services. Monthly report for April, 2009.

It was moved and seconded that the Information Only Items be received. The motion carried unanimously.

11. **CORRESPONDENCE: (Action Required.)**

**CORRESPONDENCE: (Information)**

- (a) Card of thanks received 2009-APR-27 from Ms. Nancy O'Toole, President, Synchro BC on behalf of Synchro BC and the Nanaimo Diamonds for the Parks, Recreation and Culture Commission's support with regard to the Western Canadian Synchro Championships, Nanaimo, BC 2009.

- (b) Minutes of the Nanaimo Harbour City Seniors, Board of Directors, meeting held 2009-MAY-01.
- (c) Letter dated 2009-MAY-01 from Ms. Lesley Coultish, Secretary, on behalf of the Nanaimo and District Equestrian Association offering their congratulations and support in the City of Nanaimo hosting the 2014 BC Summer Games.
- (d) E-mail dated 2009-MAY-14 received from the Vancouver Island Exhibition Association advising of the RCMP Musical Ride to be presented by the VIEX on Wednesday, 2009-AUG-12.
- (e) Minutes of the Nanaimo Harbour City Seniors, Annual General Meeting held 2009-MAY-20.

It was moved and seconded that the Correspondence be received. The motion carried unanimously.

12. NOTICE OF MOTION:

13. CONSIDERATION OF OTHER BUSINESS:

14. BUSINESS ARISING FROM DELEGATIONS:

15. UNFINISHED BUSINESS:

- (a) Beban Park Complex Feasibility Study Report – staff report.
- (b) E.J. Hughes Mural – Copyright & Image Production used on promotional material, and sold by the City of Nanaimo, with proceeds going to Art in Public Places – Update from Staff - for next PRCC meeting with have the Agreement and letter from the estate for information and review.

16. QUESTION PERIOD:

- (a) "Robin's Garden", 1450 Milton Street, has a stand of trees that need to be addressed. On 2009-MAY-25, Council moved that a Development Variance Permit be issued. The recent development plans and approved development permit by Council has an excellent tree retention plan that preserves the most significant trees and vegetation on the property.

17. ADJOURNMENT:

It was moved and seconded at 7:30 p.m. that the meeting adjourn, with the next Meeting of the Parks, Recreation and Culture Commission to be held Wednesday, 2009-JUN-24, commencing at 7:00 p.m. in the Bowen Park Complex Conference Room; and,

With the next meeting of the Cultural Committee to be held Wednesday, 2009-JUL-08, commencing at 4:15 p.m. in the Bowen Park Complex Conference Room; and,

With the next meeting of the Recreation Committee to be held, if required, Wednesday, 2009-JUN-10, commencing at 4:00 p.m. in the Bowen Park Complex Conference Room; and,

With the next meeting of the Parks Committee to be held, if required, Thursday, 2009-JUN-11, commencing at 5:00 p.m. in the Bowen Park Complex Conference Room.

The motion carried unanimously.

\_\_\_\_\_  
L. McNabb, Chair  
Parks, Recreation and Culture Commission

CERTIFIED CORRECT:

\_\_\_\_\_  
R. Harding, Director  
Parks, Recreation and Culture

2009-JUN-16  
File: A2-4  
G:\Admin\PRCC\Minutes\PRCC090527M.doc

## REQUEST TO APPEAR AS A DELEGATION

ON - 2009 - ~~May~~ JUNE - ~~27th~~ 24  
year month day

NAME OF PERSON MAKING PRESENTATION: Bill Merilees – Chair – Buttertubs Marsh Liaison Committee

ADDRESS: 3205 Granite Park ,		Nanaimo,	B.C.	V9T 3C8
street address		City	Province	Postal Code
PHONE: 250 758-1801		n/a	Fax n/a	
home		business		

NAME OF APPLICANT IF OTHER THAN ABOVE: \_\_\_\_\_

### DETAILS OF PRESENTATION:

Two Issues:

1. We wish to ask the PRCC & the City of Nanaimo, to actively assist us with the acquisition of the BC Transportation and Finance Authority property at 1996 Jingle Pot Road. \$\$\$ are not required at this time but preliminary groundwork is required to explore this option and to determine what the costs might be should we wish to proceed.

2. With the recent proposed designation of Buttertubs West as a Nature Park, status **PRC-1**, we wish to ask the PRCC and the City of Nanaimo to enact the appropriate legislation enabling the enforcement of the Buttertubs Management Plan (notable No Dogs & No Bicycles) on the trail at this location. The street address for Buttertubs West is 1780 Jingle Pot Road.

### PLEASE NOTE

- **Electronic presentations** must be provided on a CD or by e-mail no later than 9:00 a.m. the day of the Meeting.
- Please submit a written copy of your presentation to the Recording Secretary either at, or prior to, the Meeting.
- **Multiple speakers** on a single issue or topic shall be given 5 minutes each to make their presentations as per Section 18.6 of the Council Procedure Bylaw.

Parks, Recreation and Culture Commission  
500 Bowen Road, Nanaimo BC V9R 1Z7

**RECEIVED**

MAY 19 2009

DEPARTMENT OF  
PARKS RECREATION AND CULTURE

Phone: (250) 755-7511  
Fax: (250) 753-7277  
parks@nanaimo.ca

458



REQUEST TO APPEAR AS A DELEGATION

ON 2009 - JUNE - 24  
year month day

NAME OF PERSON MAKING PRESENTATION:

NANAIMO ART GALLERY  
IAN NIAMATH, PAUL FUDGE  
Print

ADDRESS:

150 COMMERCIAL ST NANAIMO BC  
street address City Province Postal Code

PHONE:

home

250 754 1750

business

FAX:

NAME OF APPLICANT IF OTHER THAN ABOVE:

ED POLI

DETAILS OF PRESENTATION:

To update the Commission on the Nanaimo  
Art Gallery's vision and plans for a  
new Civic/Municipal Art Gallery  
for Nanaimo.

RECEIVED

JUN 16 2009

DEPARTMENT OF  
PARKS RECREATION AND CULTURE

PLEASE NOTE

- Electronic presentations must be provided on a CD or by e-mail no later than 9:00 a.m. the day of the Meeting.
- Please submit a written copy of your presentation to the Recording Secretary either at, or prior to, the Meeting.
- Multiple speakers on a single issue or topic shall be given 5 minutes each to make their presentations as per Section 18.6 of the Council Procedure Bylaw.

## **THE RATIONALE FOR A NEW PUBLIC ART GALLERY IN NANAIMO**

### **Why is it important to have a public art gallery in Nanaimo?**

Perhaps the first question is why do we need artists and the work they produce?

It has long been argued that art is the truest reflection of society and its values at any given time in history\*.

By its very nature a gallery provides a window on the world as seen by the creative mind, past and present. But the role of the artist is also to push the limits of our imagination, and to challenge us to look at the world in new and different ways.

If we can sell the "mantra" that a gallery is a place of enlightenment; a place where we can discover new ideas and be stimulated to look at the world in a new way, then it should easily follow that people will see the gallery as a place of education, important to children and adults, and the community as a whole.

An attempt at a single concise statement might read:

"The art gallery is a place of enlightenment, enjoyment and education and is a focal point for the visual arts community. Its purpose is to exhibit, collect, preserve and interpret original works of art for the enrichment of the quality of life of the people of Nanaimo and the region, and for visitors to our city. Its existence helps to establish an artistic and cultural heritage for the city, the region, the province and the country!"

\* The great English critic, essayist and reformer, John Ruskin, said:

"Great nations write their autobiographies in three manuscripts, the book of their deeds, the book of their words and the book of their art. Not one of these books can be understood unless we read the two others, but of the three the only trustworthy one is the last."



## **NANAIMO ART GALLERY**

Briefing Note for the City of Nanaimo Parks, Recreation and Culture Commission meeting on Wednesday, June 24<sup>th</sup>, 2009

### **A. INTRODUCTION**

The Nanaimo Art Gallery Board created a VISION STRATEGY COMMITTEE on January 19<sup>th</sup>, 2009. The members of the committee are: Paul Fudge (Chair); Ian Niamath; Steve Lane; Suzanne Samborski; Bob Kuhn; Diane Brennan; Debbie Trueman; Ed Poli.

The committee has focused its work in the following areas:

- developing the rationale for a new public art gallery in Nanaimo (attached)
- finalizing the VISION for a new Nanaimo Art Gallery (attached)
- researching galleries in similar sized cities
- getting advice on developing the strategy for moving the project forward
- identifying sources of potential funding for moving the project forward
- collecting appropriate resource materials

### **B. THE RATIONALE**

The first task of the committee was to develop the rationale for a new public gallery. This piece was approved by the board in February, and is included with this briefing note.

### **C. THE VISION**

In order to develop the VISION the committee felt that it was important to have input from a broad range of people in the arts community, especially people who support the concept of a new gallery. To this end a series of focus group discussions were organized, with invitations being extended to people in four categories:

- artists
- arts administrators and city staff
- arts patrons, volunteers and clients
- art educators and curators

The focus group sessions took place on March 23<sup>rd</sup>, April 2<sup>nd</sup> (two sessions), April 7<sup>th</sup> and May 21<sup>st</sup>. They were generally well attended and resulted in good discussion and input. At each session the participants were asked to respond to five questions that had been provided to them ahead of time:

1. What do you see as the role or purpose of a public art gallery?
2. What kind of exhibitions would you want to see at a new gallery?
3. What kind of programming would you want a new gallery to provide?
4. What other services would you like to see at a new gallery?
5. Where in the city would you like to see a new gallery situated?

The suggestions from each focus group were recorded and then used to develop the Vision statement. This document was then circulated to all the focus group participants who were invited to a follow-up meeting on May 6<sup>th</sup> at the downtown gallery. New ideas emerging at that session have been incorporated into the Vision statement.

The finalized VISION is included with this briefing note.

#### D. RESEARCH

The research undertaken by the committee has been focused on four art galleries situated in communities approximately the same size as Nanaimo. These are: Prince George (the Two Rivers Gallery); the Kelowna Art Gallery; the Kamloops Art Gallery; and the Reach in Abbotsford.

Our research includes the capital costs of the building when it was built, the funding model used to build the gallery, the amount and kind of spaces incorporated in the gallery, and the operating budget of the institution. The most recent of these is the Reach in Abbotsford, which was opened in September 2008, providing a useful yardstick for present-day capital costs. While we have collected important data, the research has not been fully completed. It is also the plan of the committee for two or three members to visit the three galleries that are within a reasonable distance (Abbotsford, Kelowna and Kamloops) over the next couple of months.

#### E. STRATEGY FOR MOVING THE PROJECT FORWARD

The committee has received help and advice from a number of individuals who have experience in developing new cultural facilities, including Debbie Trueman, General Manager of the Nanaimo Museum, who agreed to join the committee and share her knowledge and experience in getting the new museum in place.

In May a meeting was held with Signy Madden and John Kaye from Clayton Consulting, a company that provides resource and organizational development for a wide variety of clients, including the Art Gallery of Greater Victoria. They provided important advice regarding the need to recruit key people in the community to become involved; the need to search for potential benefactors; the importance of planning in communications and fundraising; and the need for a project manager to be identified as early as possible.

In considering the information acquired, and the advice received, we believe that the next important step is to conduct a feasibility study into the building of a new gallery.

#### F. POTENTIAL FUNDING FOR MOVING THE PROJECT FORWARD

The federal Department of Canadian Heritage – Cultural Spaces Program provides funding for improving existing facilities, or creating new facilities, for cultural activities. New funding (\$60 million over two years) was made available for the program in the most recent federal budget. We believe this is a prime source for the gallery to approach for financing the feasibility study and other costs relating to the initial stages of the project.

#### G. RESOURCE MATERIALS

The committee has started to compile resource material on the development of cultural facilities from a variety of sources. Bob Kuhn (City of Nanaimo) has been especially helpful in identifying potential resource materials.



## **A Vision for the new Nanaimo Art Gallery**

### **A. INTRODUCTION**

The Nanaimo Art Gallery has embarked on the process of creating a vision for a new gallery in the city. We have been consulting with artists, art educators and curators, arts administrators, patrons, volunteers and gallery clients, and city staff.

The picture that emerges is a state of the art institution, designated as a CATEGORY A PUBLIC ART GALLERY. Situated in the arts district, it provides the people of this region with the highest quality exhibitions, programs and services that a top grade art gallery can give to citizens of all ages. It was built and continues to operate as a result of key partnerships with both public and private supporters who are committed to ensuring the sustainability of the institution and its programs.

### **B. THE GALLERY**

1. The new gallery is situated in the downtown arts district, close to other cultural institutions like the Museum and the Port Theatre:
2. The gallery is easily accessible from the waterfront.
3. It is sited in an area that is spacious and attractive.
4. It is a BEAUTIFUL BUILDING. Designed by an architect, it is A WORK OF ART ITSELF and an icon in the community. It is a DESTINATION POINT for visitors and tourists.
5. The building and its operations are designed to be sustainable and conform to LEED standards.
6. The gallery is seen as A PLACE OF ENLIGHTENMENT and visitors feel comfortable when they enter. The foyer is warm and welcoming, with detailed information about the exhibitions and programs.
7. The gallery has flexible hours of operation that respond to community needs and provide maximum accessibility.
8. While there is a visitors' parking area, the gallery works with the transit system to ensure that the building is easily reached by public transit. There is a drop off area in front of the building.
9. In the core of the building there is an open green space, with benches, that acts as both a resting place and a sculpture garden.
10. The gallery is equipped with state-of-the art technology and makes full use of all web-based technology options to communicate with and engage its members and the community at large.
11. The LOCAL POPULATION IS SUPPORTIVE – in its attendance at exhibitions and special events, and in its financial commitment through memberships and donations.
12. The gallery is a KEY TOURIST ATTRACTION and receives many visitors from outside the region each year.

13. The new gallery is constantly raising the profile of art and artists in the community and across the region. It is attractive to young people and is viewed as a place of adventure!
14. It is a gathering place; a focal point for artists and the public!
15. The gallery's influence and services stretch over an expanding area of Vancouver Island (especially north of the Malahat).
16. The gallery's operating model is partnership based (this could be a model similar to other cultural institutions in Nanaimo where the City owns the building and leases it to the Nanaimo Art Gallery Society or a new model created during the development phase).

### **C. THE COLLECTION**

The gallery's PERMANENT COLLECTION continues to grow under its collection policy. New work is added through purchases (whenever possible) and through donations.

### **D. EXHIBITIONS**

1. There are several EXHIBITION AREAS that provide enough space for:
  - a) major traveling shows;
  - b) local and regional artists;
  - c) the permanent collection shown on a rotating basis;
  - d) contemporary art embracing new directions;
  - e) a gallery for students and emerging artists.
  - f) micro spaces available for small exhibits – suitable for school work or community projects.
2. There is GREAT VARIETY in the exhibitions offered, including shows of national and international recognition.
3. The gallery works hard to encourage emerging artists.
4. The gallery creates exhibits here that are then circulated to other galleries across both the province and the country.
5. The visitor sees works of art that inspire, inform and involve; and new work that is provocative and attracts attention and dialogue. Emphasis is placed on including First Nations' art, especially First Nations' art that is linked to Vancouver Island. The gallery's exhibition program reflects the society in which we live, and the way the world is moving.
6. In conjunction with exhibitions, the gallery publishes catalogues that are available for purchase. It also provides curators' statements, and information cards as part of the exhibitions.
7. In addition to docent conducted tours, the gallery provides audio (electronic) tour guides when appropriate.

## **E. EDUCATION**

1. The gallery has a **STRONG COMMITMENT TO EDUCATION**. There is a **LEARNING CENTRE**, with a large, well-equipped work area for classes and workshops and a well-equipped **RESOURCE CENTRE** housing catalogues, books, and other materials available for research.
2. Classes and workshops take place throughout the year and involve people of all ages. The education activities provided by the gallery are seen to be accessible, creative and fun!
3. There are education resource materials available for each exhibition.
4. There is a team of trained volunteer docents to conduct tours for school classes and for visitors to the gallery.
5. There is a **VIDEO ROOM** for a wide range of supplementary materials. This can also be used for live interactive links to artists' studios, providing an insight into how the artist works.
6. • The gallery has expanded its **ARTISTS IN THE SCHOOLS PROGRAM**, serving more students in the region.
7. The gallery has a coordinated education program with Vancouver Island University (Visual Arts Department) in such areas as conservation practices and curatorial training.
8. The gallery has initiated an **EXTENSION PROGRAM**, taking small exhibitions of original art work to communities in the region as a way of encouraging people to look at art; and to promote visits to the gallery when people are in the city.
9. The gallery is constantly in direct communication with art educators, both in the school system and at Vancouver Island University. It also coordinates school visit by artists and University art teachers that are outside the Artists in the Schools Program.

## **F. PROGRAMMING**

1. Working closely with other galleries and First Nations the gallery develops programs that are designed to increase the awareness, understanding and appreciation of art. Together with the exhibitions, the programs provide a window on the world of art for people of all ages. The programs are accessible to people regardless of their ability to pay.
2. The programs may include such things as:
  - a) Artists' talks in conjunction with exhibitions (live when possible, or on video)
  - b) Art appreciation classes
  - c) Studio tours
  - d) A training program for volunteer docents
  - e) Workshops on how to collect art
  - f) Special needs programs for the mentally and physically challenged.
  - g) Art classes and workshops in a variety of media
  - h) Life drawing classes
  - i) Professional development workshops for artists

- j) A lecture series on art and artists
  - k) A film series about art and artists
  - l) Cultural/gallery tours to other cities
  - m) Advice on getting works of art appraised
3. Working in partnership with other cultural organizations the gallery is also home to a variety of performances, including musical events, poetry readings and book launches.

#### **G. OTHER SERVICES**

- 1. There is a strong ART SALES AND RENTAL PROGRAM and the gallery has the facility to package and ship works of art as required.
- 2. There is a multi-purpose space that can be rented by community groups for meetings, seminars, receptions or special events. The gallery uses the space for its film and lecture programs.
- 3. There is a ROOFTOP CONSERVATORY GARDEN & CAFÉ which has a fine view of the waterfront.
- 4. There is a GIFT SHOP.
- 5. There is a COAT CHECK area in the foyer.

#### **H. BEHIND THE SCENES (Storage and Working Area)**

- 1. The administration offices are spacious, well furnished and well lit.
- 2. The storage space for the permanent collection and traveling shows is large, technically up-to-date and easy to maintain.
- 3. There is adequate storage space for all the gallery's other needs.
- 4. The Preparator's work space is large, properly ventilated and well equipped.
- 5. There is a freight elevator connecting all floors.
- 6. There is a loading dock and receiving area for all incoming and outgoing shipments.

#### **I. THE PEOPLE**

The Gallery has a STRONG BOARD AND EXCELLENT PROFESSIONAL STAFF. It also enjoys the commitment of many VOLUNTEERS, and has an effective Volunteer Recognition Program.

**RECEIVED**

JUN 17 2009

DEPARTMENT OF  
PARKS RECREATION AND CULTURE**REQUEST TO APPEAR AS A DELEGATION**ON 2009 - June - 24  
year month day

NAME OF PERSON MAKING PRESENTATION:

Don Rinald

Print

ADDRESS:

6 Maki Rd

street address

Nanaimo

City

BC

Province

V9R6N7

Postal Code

PHONE:

250-754-3325

home

business

FAX:

NAME OF APPLICANT IF OTHER THAN ABOVE:

Nanaimo Rowing Club/Canoe & Kayak Club**DETAILS OF PRESENTATION:**

Presentation to show the Commission plans for a boathouse in Loudon Park. This is a continuation of what was included in the Loudon Park Improvement Plan (Fall 2006). We hope that, as a result of this presentation, PRC will open a public consultation process to discuss the location & design we have proposed.

**PLEASE NOTE**

- **Electronic presentations** must be provided on a CD or by e-mail no later than 9:00 a.m. the day of the Meeting.
- Please submit a written copy of your presentation to the Recording Secretary either at, or prior to, the Meeting.
- **Multiple speakers** on a single issue or topic shall be given 5 minutes each to make their presentations as per Section 18.6 of the Council Procedure Bylaw.

Parks, Recreation and Culture Commission  
500 Bowen Road, Nanaimo BC V9R 1Z7Phone: (250) 755-7511  
Fax: (250) 753-7277  
parks@nanaimo.ca

467

PARKS, RECREATION AND CULTURE COMMISSION

REQUEST TO APPEAR AS A DELEGATION

ON 2009 - JUNE - 24  
year month day

NAME OF PERSON MAKING PRESENTATION: <u>JIM HARRIS</u> Print			
ADDRESS: <u>173 COLVILLETON TRAIL</u> <u>NANAIMO</u> <u>BC</u> <u>V9R6R1</u> street address City Province Postal Code			
PHONE: <u>250 740 0317</u> home		FAX: <u>N/A</u> business	
NAME OF APPLICANT IF OTHER THAN ABOVE: <u>DOUGLAS ISLAND GARDEN SOCIETY (D.I.G.S.)</u>			
DETAILS OF PRESENTATION:			
<u>D.I.G.S. WILL BE ASKING COMMISSION PERMISSION TO BUILD AND</u>			
<u>MANAGE 19 ALLOTMENT BEDS AS PART OF OUR COMMUNITY GARDEN</u>			
<u>PROJECT</u>			
		<div>RECEIVED</div> <div>JUN 11 2009</div> <div>DEPARTMENT OF PARKS RECREATION AND CULTURE</div>	

PLEASE NOTE

- Electronic presentations must be provided on a CD or by e-mail no later than 9:00 a.m. the day of the Meeting.
- Please submit a written copy of your presentation to the Recording Secretary either at, or prior to, the Meeting.
- Multiple speakers on a single issue or topic shall be given 5 minutes each to make their presentations as per Section 18.6 of the Council Procedure Bylaw.

Parks, Recreation and Culture Commission  
500 Bowen Road, Nanaimo BC V9R 1Z7

Phone: (250) 755-7511  
Fax: (250) 753-7277  
parks@nanaimo.ca

468



## **D.I.G.S. SURVEY**

In an effort to gain a sense of islanders' thoughts on allotment style beds D.I.G.S. has developed the following survey. Please check the choices that best convey your opinions.

Allotment gardens are cultivated individually rather than collectively. Allotment gardeners pay a small fee and abide with the constitution and bylaws of the community garden association. The revenue from these fees is used to maintain the entire garden. There are many allotment styles and later, meetings of interested gardeners will decide which style best suits the island. For more information about different allotment styles go to [www.communitygarden.org](http://www.communitygarden.org) and in the search box type in "allotments".

1. Are you in favour, in principle, of having some allotment style beds in the Garden in the Park (Protection Island's community garden)?      \_\_\_\_\_ Yes      \_\_\_\_\_ No

2. If allotment beds in some form were available in the Garden in the Park, would you be interested in leasing one?

\_\_\_\_\_ Strong interest

\_\_\_\_\_ Moderate interest

\_\_\_\_\_ No interest

**If you are interested in acquiring an allotment bed please *either* fill in your name and phone number *or* call/email Jim or Margaret Harris at 250-740-0317 email: [meharris@telus.net](mailto:meharris@telus.net). If enough interest is shown a meeting will be arranged to discuss the rules for their management.**

**Name:** \_\_\_\_\_ **Phone:** \_\_\_\_\_

Please return this questionnaire a.s.a.p. in the attached envelope addressed to:  
Parks Operations Department, 89 Prideaux Street, Nanaimo, BC V9R 2M6

Questions? Contact DIGS members: Jim or Margaret Harris 250-740-0317  
Josephine Kenchenten 250-714-0523

There is room for comments on the back of this sheet.



**DOI LAS ISLAND GARDEN SOCIETY**  
**COMMUNITY GARDEN AGREEMENT 2007**

**1. Registration Fees and Allotment Reservation**

- Each island resident is entitled to rent a plot if space is available
- Annual allotment fees are \$30 per plot or \$15 per half lot. These fees are non refundable.
- The fee includes frugal use of water but does not include soil amendments (fertilizers)
- Allotment rentals are good for 1 year only (March 1 to Feb.28) And DIGS reserves the right to change location and availability of allotments in future years. DIGS retain the right to refuse to rent allotments if there is just cause.
- All allotment registrations are to be renewed annually by March 1. Registration reminders will be mailed to current gardeners at the beginning of each year. Any plot not registered and the fee not paid by March 1 will be made available to new gardeners.
- Allotments must be cleared of weeds by April 1. Failure to do so will result in the plot being reassigned to another gardener.
- After April 1 current gardeners may rent additional plots if they are available.
- If, for any reason, a renter finds that they cannot care for their garden, they are required to notify the allotment coordinator and make arrangements for the care of their garden during their absence.
- Gardeners registering after Aug.15 for fall and winter gardens pay ½ the annual fee (\$15).

**2. Watering**

- The rental fee includes the frugal use of water. A gardener must remain in the garden while his/her garden is being watered. Gardeners must monitor their water use to avoid flooding of his/her garden and neighbouring gardens.

**3. Planting Restrictons**

- a. Only organic methods of growing are permitted - no toxic chemicals, fertilizers, pesticides or herbicides. Gardeners

using these items will lose their gardening privileges.

- b. No trees are allowed because of shade and root problems.
- c. No invasive species (eg. bamboo, scotch broom, purple loose-strife)
- d. Care must be taken with hard to eradicate plants such as birdweed and berry vines. If not kept in check they may be treated as weeds.
- e. Tall plants can only be planted where they will not shade neighbouring plots.

4. Smoking

Smoking is not permitted in the garden area. This is a safety issue and a means of preventing the spread of the tobacco mosaic virus.

5. Weeds and Trash

It is the gardener's responsibility to control the weeds and trash in their own plots and adjacent pathways and to clear their plot of trellis and staking material, plastic mulching, decorations and plant debris by April 1.

6. Rebar

Exposed rebar is not allowed for staking or trellising for safety reasons.

7. Pets

Pets are not allowed in the garden.

8. Storage

Storage on site for gardeners' tools or supplies will not be provided. Gardeners must pack what they need in and out.

9. Gates

Gardeners are asked to close all gates when leaving to keep the deer out.

## 10. Compost and Garbage

A refuse bin (for non organic garbage), a closed or sealed compost bin (for fruits and other organic foodstuffs) and an open compost bin (for leaves, stem and root material) will be available on site. Gardeners are encouraged to recycle their garden wastes in the garden's compost bins.

## 11. Harvesting

No one may pick another gardener's crop unless he/she has been given permission by that plot user.

## 12. Cooperation, Community and Volunteer Requirements

- a. This project will be more successful if the gardeners work together. In addition to the annual fee gardeners are asked to make a contribution of their time by participating in the following communal

Tasks: i) grass cutting – gardeners will be asked to cut the grass once during the season (inside the garden)

- ii) spring and fall cleanup

- iii) construction tasks and maintenance tasks

- iv) watering – gardeners will be asked to water the communal beds once during the season.

- b. Conflicts or concerns with other gardeners should be worked out privately. If not, the coordinator will arbitrate.

## 13. Privacy of Personal Information

All information collected on registration forms will be compiled in a database accessible only to the executive and will be kept confidential. This information will not be lent, rented or sold.

## 14. Please Remember

The purpose of the community garden is to provide access to land and water in an environment that promotes positive social interaction. Its success is a collective responsibility.

These rules will be reviewed annually and may be improved.

# CITY OF NANAIMO

THE HARBOUR CITY

PARKS, RECREATION AND CULTURE COMMISSION

**RECEIVED**

MAY 25 2009

**RECEIVED**

MAY 01 2009

DEPARTMENT OF  
PARKS RECREATION AND CULTURE

REQUEST TO APPEAR AS A DELEGATION

ON 2009 - 05 - 25  
year month day  
JUN 24

LEGISLATIVE SERVICES

NAME OF PERSON MAKING PRESENTATION: DAVID ESSIG  
Print  
ADDRESS: 7 CAPTAIN KIDDS TER., NANAIMO, BC V9R 6R1  
street address City Province Postal Code  
PHONE: 250-741-1065 — FAX: — e-mail: essig@telus.net  
home business  
NAME OF APPLICANT IF OTHER THAN ABOVE: —

## DETAILS OF PRESENTATION:

I WISH TO SPEAK IN SUPPORT OF THE APPLICATION BY THE DOUGLAS ISLAND GARDEN SOCIETY (DIGS) FOR PERMISSION TO CONSTRUCT AND OPERATE AN ALLOTMENT GARDEN ON A PORTION OF THE PARKLAND ON PROTECTION ISLAND NOW DESIGNATED AND OPERATED AS A COMMUNITY GARDEN.

I WILL PROVIDE A WRITTEN COPY OF MY PRESENTATION BY E-MAIL WELL IN ADVANCE OF THE MEETING DATE. I WILL LIMIT MY REMARKS TO FIVE MINUTES.

THANK YOU, David Essig

## PLEASE NOTE

- Electronic presentations must be provided on a CD or by e-mail no later than 9:00 a.m. the day of the Meeting.
- Please submit a written copy of your presentation to the Recording Secretary either at, or prior to, the Meeting.
- Multiple speakers on a single issue or topic shall be given 5 minutes each to make their presentations as per Section 18.6 of the Council Procedure Bylaw.

Parks, Recreation and Culture Commission  
500 Bowen Road, Nanaimo BC V9R 1Z7

☐ Council  
☐ Committee  
☐ Open Meeting  
☐ In-Camera Meeting  
Meeting Date: \_\_\_\_\_

Agenda Item  
Delegation  
Proclamation  
Correspondence

☐ Phone: (250) 755-7511  
☐ Fax: (250) 753-7277  
☐ parks@nanaimo.ca

474

**Presentation by David Essig to the Nanaimo PRC Commission  
24 June 2009**

I am speaking in favour of the application by the Douglas Island Garden Society to designate as allotment beds a small portion of the Community Garden on Protection Island. My fellow islanders and DIGS members are speaking to the technical and administrative aspects of the proposal. I wish to address the issue of the potential economic impact of the proposal on the community.

Allotment gardens are well regarded as an appropriate use of public land in communities throughout Canada, North America and Europe. In determining whether a given proposal for such public land-use is acceptable, local governing bodies consider the economic impacts, both negative and positive that the proposed use would have. The criteria of equity and efficiency are appropriate tools for assessing these impacts.

### **Equity**

The general equity issue is whether this proposed use is fair insofar as it benefits the general community while designating specific public land for private use.

It is important to recognize that the allotment beds would be "private," only to the extent that the allotment holders would be responsible for the care of the beds and the distribution of the produce there from during the limited tenure of their allotment.

The proposed Rules and Guidelines for the allotment beds sets out a clear and fair system for the allocation among interested participants. These provisions ensure an open, inclusive decision-making process whereby the allotment beds cannot become inter-generational sinecures.

I believe these provisions are satisfactory to meet the equity criterion: anyone who wishes to participate in the allotment beds would be welcome to do so. Everyone is treated equally.

### **Efficiency**

I would like to look at this criterion in two ways:

1. This proposal is an efficient use of public land insofar as it would create the positive amenity of gardening opportunities for those community members who wish to partake, at no cost to any other individual members of the community.

As an economist, I can make the case that the proposal is *optimally efficient*, in that some members of the community would be made better without any individual member being made worse off. That is, the *marginal rate of substitution* for the use of this land would be equalized among all community members.

In plain language, this means that no one would suffer a direct or indirect cost for the implementation of the proposal. The proposed beds would be built on the parkland that is already designated for the community garden.

I cannot identify any individual or collective human activity in our community that would be diminished by this proposed use of the land. Since there is no existing competing use for the land, the efficiency criterion is well satisfied.

2. There are well documented positive benefits to the general community that accrue from the use of public land as allotment garden beds – what economists call “positive spill-over effects.”

Principle among these is the creation of a public open space, available to all members of the community, to gather and recreate in a pleasant, welcoming garden environment. I would like to stress that the proposed allotment beds would be an integral feature of the public character of our existing community garden – open to all members of the community at all times.

In the context of Protection Island, the proposed allotment garden beds would be an efficient use of public land.

### **Conclusion**

With the economic criteria of efficiency and equity met, I am pleased to take the philosophical stand that this modest proposal has an emancipating potentiality, in that it could free us, if ever so slightly, from the imprisoning horizon of the immediate.

Although these allotment beds may be viewed as mere garden soil in wooden frames, with their creation, our community could take yet another small but profound step along the path towards actualizing our utopia.

Please support our proposal.  
Thank you.

**David Essig**  
Member  
Douglas Island Garden Society  
Protection Island, Nanaimo, BC





## REQUEST TO APPEAR AS A DELEGATION

ON 2009 - June - 24  
year month day

**RECEIVED**

JUN 17 2009

Print

**DEPARTMENT OF  
PARKS RECREATION AND CULTURE**

NAME OF PERSON MAKING PRESENTATION: Jim Irvine

ADDRESS: 196 Captain Morgans Blvd, Nanaimo, BC B.C. V9R 6R1  
street address City Province Postal Code

PHONE: 250 716 1761 250 713 4136  
home business

NAME OF APPLICANT IF OTHER THAN ABOVE: \_\_\_\_\_

### DETAILS OF PRESENTATION:

**PowerPoint presentation entitled "Protection Island Allotment Beds – Is there a problem?"**

In this presentation, I will provide what I hope is an objective review of perceived, potential, perceived, and/or real problems associated with the proposal to have allotment beds as a component of the Community Garden on Protection Island.

A copy of the presentation is attached.

### PLEASE NOTE

- **Electronic presentations** must be provided on a CD or by e-mail no later than 9:00 a.m. the day of the Meeting.
- Please submit a written copy of your presentation to the Recording Secretary either at, or prior to, the Meeting.
- **Multiple speakers** on a single issue or topic shall be given 5 minutes each to make their presentations as per Section 18.6 of the Council Procedure Bylaw.

**Parks, Recreation and Culture Commission**  
500 Bowen Road, Nanaimo BC V9R 1Z7

477  
Phone: (250) 755-7511  
Fax: (250) 753-7277  
parks@nanaimo.ca

# Protection Island Allotment Beds

Is there a problem?

An objective review of perceived, potential, and/or real problems

Presentation to Nanaimo Parks, Recreation and Culture Commission

By Jim Irvine

24 June 09



# Private Use of Public Space

## Is This a Problem?

- Interpreted to be the use by individuals, frequently for payment, of areas or places that would otherwise be open and accessible to all
- Protection Island (PI) Community Garden is a public space that is open and accessible to all
- Although access to the allotment beds cannot be declined to anyone, in practice, the intent is that beds will be used by those maintaining and renting them; this therefore is an example of the private use of public space
- Private use of public space happens all the time
  - Parking meters
  - Sports facilities
  - Private rentals at Beacon House
  - Boat slips at Mud Bay dock and Nanaimo Harbour Basin
  - Allotment beds in Nanaimo's Beaufort Park

# Private Use of Public Space

## Is This a Problem?

- Auckland (NZ) City Council Policy on Private Use of Public Space states “Council will decline all requests for private use of public space unless such use or occupation is of benefit to the proper use and enjoyment of the public space”<sup>1</sup>
- Auckland policy seems to be a reasonable model to follow here
- PI Allotment Beds will generate income to help operate the community garden, and will provide on-site gardeners who will advise and assist with the operation of the community garden
- PI Allotment Beds will therefore benefit the use and enjoyment of Protection Island and its Community Garden and we conclude:

## Not a Problem

<sup>1</sup><http://www.aucklandcity.govt.nz/council/documents/resources/publicspace/>

# Alternate Uses for Public Space

## Is this a problem?

- Inclusion of allotment beds expands the size of the community garden by ~ 200 m<sup>2</sup>
- Other potential uses for this space include:
  - additional space for community garden
  - additional “green” space
  - dog walk, children’s play area etc.
- However, in the recent survey, since 76% of PI participants (n=160) answered YES to the question, “Are you in favour of having some allotment style beds?”, we conclude:

**Not a Problem**



# Access to Beds by Alternate Users

## Is this a problem?

- Initial assignment of beds based on responses to recent survey
- There currently is one bed not spoken for – any individual or group is welcome to use this bed, which will be advertised upon approval
- Experience elsewhere (e.g. Ottawa) is that after an initial period of enthusiasm, those using beds tends to evolve to a core group of keen gardeners who are willing to spend the time and effort on the beds
- There is no indication that future demand for beds will exceed supply, but if this happens, the issue will be dealt with in a clear and transparent manner guided by the existing rules and procedures
- This perceived issue is currently:

**Not a Problem**

# Experience Elsewhere

- City of Montreal has 75 operating community garden sites, containing 6,654 allotment plots, which are gardened by approximately 10,000 residents<sup>1</sup>
- Vancouver has 18 operating community garden sites, containing 950 allotment plots, which are gardened by approximately 1500 residents<sup>1</sup>
- In May 2006, Vancouver City Council passed a motion to encourage 2,010 new garden plots by January 1, 2010, as a legacy of the 2010 Winter Games, to encourage residents to create urban gardens
- Gabriola Island is currently expanding their allotment beds

<sup>1</sup><http://vancouver.ca/ctyclerk/ccclerk/20060516/documents/a8.pdf>

# Positive Aspects of Incorporating

## Allotment Beds Within PI Community Garden

- Garden provides communality, shared tips and plants while Allotment Beds allow individuals the freedom to grow what they're interested in
- Every PI citizen, every child is encouraged to enjoy the same sort of fresh, healthful food that our emerging food movement is advocating
- Community gardens are about community. Food is a bonus
- Allotment beds provide a small, but guaranteed income for the operation of the Community Garden that does not have to be raised by fund raising or provided by the city



# Protection Island Allotment Beds

Benefits appear to outweigh any problems



## REQUEST TO APPEAR AS A DELEGATION

ON 2009 – JUN - 24

year month day

**RECEIVED**

**JUN 18 2009**

**DEPARTMENT OF  
PARKS RECREATION AND CULTURE**

NAME OF PERSON MAKING PRESENTATION: Linda Irvine

Print

ADDRESS: 196 Captain Morgan's Blvd., Nanaimo, B.C. V9R 6R1

street address

City

Province

Postal Code

PHONE: 250-716-1761

home

FAX: 250-751-3405

business

NAME OF APPLICANT IF OTHER THAN ABOVE: \_\_\_\_\_

### DETAILS OF PRESENTATION:

Summary comments on the allotment beds, administered through D.I.G.S, at the Community Garden on Protection Island.

### PLEASE NOTE

- **Electronic presentations** must be provided on a CD or by e-mail no later than 9:00 a.m. the day of the Meeting.
- Please submit a written copy of your presentation to the Recording Secretary either at, or prior to, the Meeting.
- **Multiple speakers** on a single issue or topic shall be given 5 minutes each to make their presentations as per Section 18.6 of the Council Procedure Bylaw.

**Parks, Recreation and Culture Commission**  
500 Bowen Road, Nanaimo BC V9R 1Z7

Phone: (250) 755-7511  
Fax: (250) 753-7277  
parks@nanaimo.ca

486

# THE PORT THEATRE MONTHLY ACTIVITY REPORT

May, 2009

#	DATE	EVENT	TIME	CATEGORY	AUD	ARTIST
1	1	Jesse Cook	7:30pm	Music	804	9
2	2	Nanaimo Conservatory	7pm	Music	572	53
3	3	Voices of the Island	2:30pm	Music	377	104
4	6	Reaching Beyond	9am	Workshop	316	7
5	12	Tour of Building	9:30am	Tour	10	106
6	14	May Queen Crowning	5:00pm	Rehearsal	0	24
7	15	May Queen Crowning	7pm	Pageant	350	116
8	16	Memeza Africa	7:30pm	Music	359	24
9	22	The Odds	8pm	Music	380	11
10	24	Belly Dance Superstars	7:30pm	Dance	369	17
11	26	Herrington Dance Academy	4:30pm	Rehearsal	0	66
12	27	Queen Tribute	7pm	Music	713	16
13	29	Temp Dance Academy	12:00pm	Rehearsal	0	200
14	30	Temp Dance Academy	1pm	Dance	682	200
15	30	Temp Dance Academy	7pm	Dance	677	200
16	31	Herrington Dance Academy	7pm	Dance	344	66

5149    1210

## TOTALS

**Number of Events: 16**

**Estimated Audience Attendance: 5149**

**Estimated Number of Artists/Crew: 1210**

**Total people through the building: 6359**

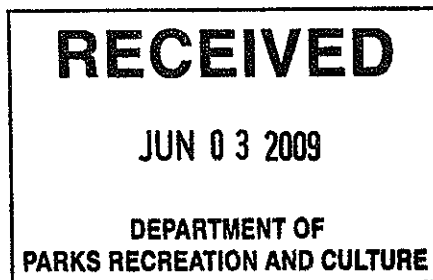

487

**THE PORT THEATRE  
MONTHLY ACTIVITY REPORT**

	# Events 2005	# Events 2006	# Events 2007	# Events 2008	# Events 2009	# Patrons 2005	# Patrons 2006	# Patrons 2007	# Patrons 2008	# Patrons 2009
Jan	24	18	12	22	13	7,082	7,609	5,626	5,126	4,191
Feb	23	26	20	32	18	8,141	11,692	8,161	10,911	8,308
Mar	20	19	18	16	27	5,758	8,075	8,305	5,078	9,604
Apr	34	31	32	20	33	12,520	10,784	12,389	7,888	10,137
May	31	38	29	28	16	14,170	15,615	13,851	13,173	6,359
Jun	36	25	25	29		15,262	14,408	12,055	12,507	
Jul	26	4	11	20		6,317	2,191	4,304	6,908	
Aug	3	3	3	2		643	865	701	1,339	
Sep	9	15	20	15		2,245	3,551	5,934	6,787	
Oct	20	19	13	26		8,069	7,915	5,119	8,067	
Nov	22	28	21	34		12,326	14,392	9,765	14,306	
Dec	19	31	14	24		6,895	15,378	5,049	9,302	
<b>TTL</b>	<b>267</b>	<b>257</b>	<b>218</b>	<b>268</b>	<b>107</b>	<b>99,428</b>	<b>112,475</b>	<b>91,259</b>	<b>101,392</b>	<b>38,599</b>

comparison of attendance for the same month last year  
comparison of events for the same month last year

-52% increase
-43% increase

five yr. average attendance for same month  
five yr. average number of events same month

12,634
28

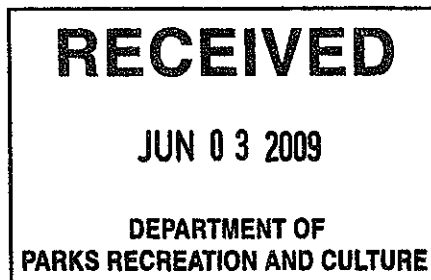

488

# THE PORT THEATRE MONTHLY ACTIVITY REPORT

Patron Attendance Comparison

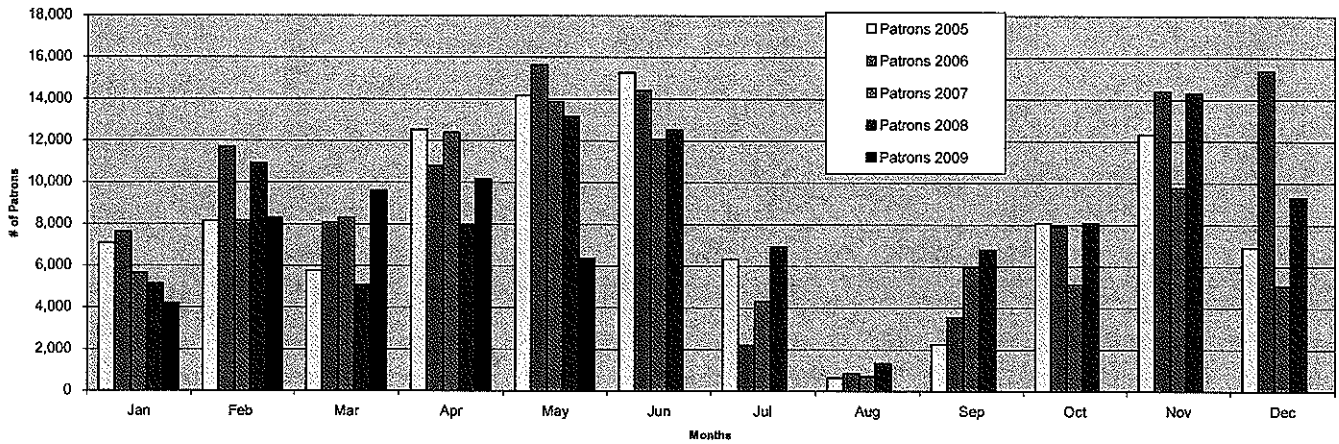

Event Comparison

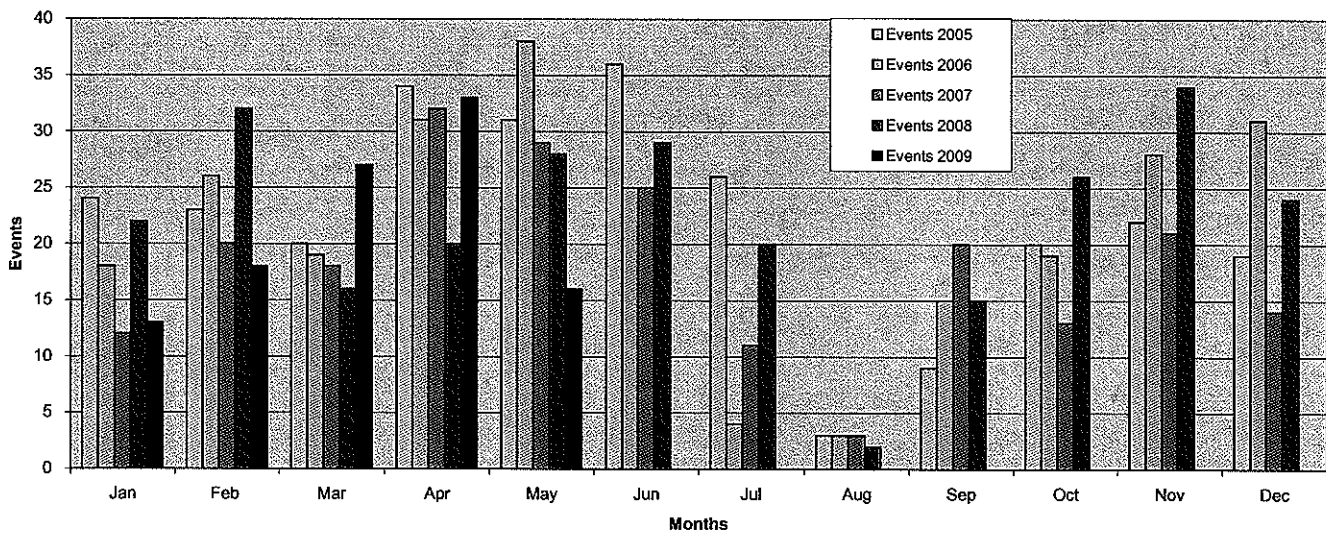

**RECEIVED**

JUN 03 2009

DEPARTMENT OF  
PARKS RECREATION AND CULTURE

489



City of Nanaimo-Parks, Recreation and Culture Commission  
Nanaimo Art Gallery: Activity Report  
May 1, 2009 to May 31, 2009

*Submitted by Ed Poli, Gallery Manager*

**The Campus Gallery** (900 Fifth Street) presented:

- ***Progressions*** – From April 17th to May 9<sup>th</sup> – The annual 2009 student art show for graduating art and design students at Vancouver Island University. The work includes painting, ceramics, drawing, sculpture, printmaking, photography, interior design, and graphic design.
- ***A Moment in Time*** – From May 15th to June 20th – An exhibit by Cowichan Valley artist Lynda Faulks presenting her portraits from the North American Indigenous Games. This set of portraits called "A Moment In Time" is a project the artist created on the games site depicting indigenous peoples in their regalia
- ***The David Lambert Collection of Pottery and Ceramics*** – From May 15 to June 20<sup>th</sup> -.The David Lambert Collection of Pottery and Ceramics is a collection made possible by the generous donation of the Marlon Lambert family of Vancouver. The collection, funded by an endowment from the family, comes from purchase awards from the graduating students in ceramics at VIU's art and design department.

**Campus Gallery Attendance                      212**

**The Downtown Gallery** (150 Commercial Street) presented:

- ***Federation of Canadian Artists- Spring Juried Show*** - April 23 to May 9 - New works from established and emerging artists from the Central Island area.
- ***Gala Premiere*** of the Documentary Film *EJ Hughes the Restoration* on May 14 at the Shaw Auditorium in the Vancouver Island Conference Centre, including presentation to the City of a limited Edition print of EJ Hughes *Harbour Scene Nanaimo*
- ***EJ Hughes – the Man and his Art*** – from May 15 to June 7 – An exciting exhibit featuring the work of renowned Canadian painter, E. J. Hughes. Approximately 50 pieces of Hughes' work spanning a broad period of his working career were on display. Most of the art work was from private collections and is not normally available for public viewing. The exhibit also featured ongoing screenings of the documentary film *EJ Hughes – The Restoration*

**Note** – due to incredible demand and thanks to the generosity of the private collectors the exhibit will be going back up from July 3 to August 16.

**Downtown Gallery Attendance                      1270**

**Total Attendance:                      1482**

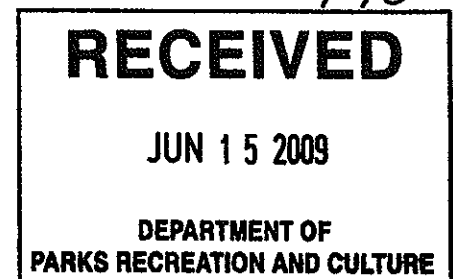

Report to Parks, Recreation & Culture Commission  
Nanaimo Museum – May 2009  
Submitted June 12, 2009 by Debbie Trueman

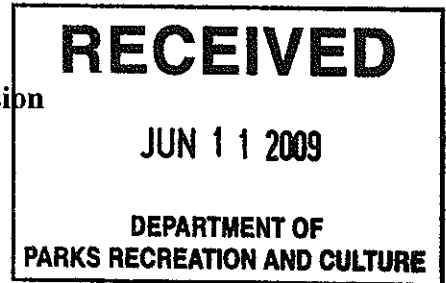

**Financial**

- Final Cultural Capitals grant from the City has been paid and all aspects of our project are complete-thank you again.
- We did receive approval for 2 students who are in place and doing well.
- We were able to submit a claim for some costs incurred that qualify on the final claim of the Cultural Spaces grant that will be a nice bonus to help defray extra operating costs for this year.
- All stats continue to break all old records!

**New Space**

- Fixing the gallery door outstanding,-we are working on the gallery and offices air temp problems.
- Piping from the basement for the heat pumps will be going through our space in early July-Richard has redesigned the Timber exhibit to accommodate the new wall.
- Serious Coffee is opening soon and the door to our lobby is in place.
- Signage outside is still a big problem complicated by the fact that some directional signs at the water still have the old Museum and several well used maps have the new museum in the wrong place or not at all! We are working on all!

**Programs and Events (see schedule of events attached)**

- Timber will open this summer with Service/Downtown section to follow in the fall. Planning for coal mine tunnel is in progress which will be the grand finale of the permanent exhibit. Planned completion and opening for this is heritage/Olympic time 2010.
- Sports Hall of Fame- 21 nominations were received. **2009 Inductees have been chosen now and will be announced at the opening of *Rocket Richard* (feature exhibit from the Canadian Museum of Civilization) exhibit July 18 which will also be our birthday celebration.** This years' banquet is Sept. 19<sup>th</sup>. You can book tickets now by calling the Museum.
- Pub tours, downtown walks, Cemetery strolls all start and the Coaltown Music Festival program all going on this summer.

**Community/Misc.**

- We have submitted a bid to hold the 2010 BCMA Conference here.
- The Nanaimo Art Gallery visioning Committee continues.
- Planning has begun with Tourism for the Tourism Roundtable for EDG in October.
- We continue to receive rave reviews for the Gallery, Shop and the space in general-most recently from the former Director of the new Surrey Museum.

491

- I continue to sit on the Destination Nanaimo committee and we have Board representation on the Heritage and Cultural committees.
- The Bastion opened May 15 (daily 10-3) and the cannon is firing daily.

### **Favourite Visitor Comments**

"You know what man, I don't like museum but since I saw your museum I LOVE IT!" Sarah L. from Quebec

Ayumi Campbell age 3 recent visitor to the Museum asked her parents "where is the big stone I saw last time?" This would have been the large piece of coal in the old museum that she saw in the fall of 2007! She also wanted to know "where is the magic tablet that makes everything come alive?" She had seen Night at the Museum 2 and was a little concerned about coming in!

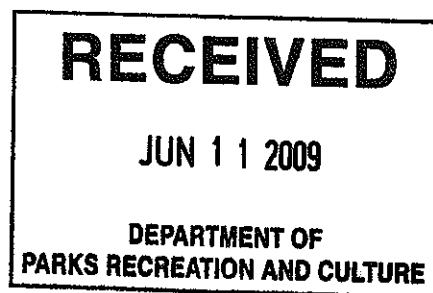



# NANAIMO MUSEUM

## Summer Events Schedule

### Bastion Summer Season Starts

**Friday, May 15**

10 am to 4 pm - Special Noon Cannon Firing Ceremony

### Down The Aisle

**Friday, May 15**

A sampling of wedding dresses from the museum's collection

### Finding Malaspina's Gallery, 1792

**Friday, May 15**

A collection of artwork related to Alexandro Malaspina's scientific voyage to the north west coast in 1792

### The Bastion Era

**Monday, May 18** display opens in the museum

### International Museum Day

**Monday, May 18**

FREE ADMISSION

### Historical Pub Tours

**Monday, June 22, July 20 & Aug. 17**

7pm - 9:30pm Cost \$15 Meet at the Nanaimo Museum



### Cemetery Tours Cost \$15

**Monday, June 29, July 27 & Aug 25**

7 pm to 9 pm Meet at Nanaimo Cemetery - Howard Street Entrance

### Theatre In the Museum Cost \$15

**Saturday, July 4** from 1 to 3:30 pm

**Thursday, July 16 and 23** from 7:30 to 10 pm

### "Rocket" Richard: The Legend-The Legacy

**Coming this summer!**

A traveling exhibition produced by the Canadian Museum of Civilization



- Limit 10 per class
- \$25 each, or 2/ \$40
- Museum members receive 15% discount.
- 10 am to 4 pm

## Summer Workshops at the Museum

The Nanaimo Museum will be offering summer workshop for students ages 8 to 12 on Tuesdays and Thursdays. The class size is limited to 10 participants for each session. Refreshment will be served throughout the day, but participants will need a lunch.

### Rowboats (6 hrs) - July 7 & 9

Build a motorized rowboat and race in Nanaimo's Around the Pool Regatta

### Carving (6 hrs) - July 14 & 16

Learn the art of First Nations carving from Snuneymuxw carver Joel Good as you carve an eagle head letter opener

### Solar Car (6 hrs) - July 21 & 23

Build a solar powered car and race against other participants in the Nanaimo Museum 500 racing circuit

### Brick Houses (6 hrs) - July 28 & 30

Build a cottage using brick and mortar. Tour the museum's 1890s miner's cottage

### Recycled Robot (6 hrs) - August 4 & 6

Create your own techno robot with moving arms

### FM Radio (4 hrs) - August 11 & 13

Build your own FM radio and then tune in your favorite station. Includes a radio station tour

### Catamaran (6 hrs) - August 18 & 20

Build a catamaran out of plastic drink bottles and race in Nanaimo's first Sine to be Swift race.

### Dynamo Torch (6 hrs) - August 25 & 27

Build a battery free flashlight.



We acknowledge the financial assistance of the Province of British Columbia



Canadian Heritage Patrimoine canadien



100 Museum Way

250-753-1821

www.nanaimomuseum.ca

493

## FOR INFORMATION ONLY

REPORT TO: THE PARKS, RECREATION AND CULTURE COMMISSION

FROM: RICHARD HARDING, DIRECTOR, PARKS, RECREATION AND CULTURE

AUTHORED BY: SUZANNE SAMBORSKI, SENIOR MANAGER, RECREATION AND CULTURE

**RE: EJ HUGHES COPYRIGHT AGREEMENT**

---

### RECOMMENDATION:

That Commission receives the report.

### EXECUTIVE SUMMARY

At the 2008-OCT-29 Commission meeting a recommendation was moved that staff investigates having a copyright on the E.J. Hughes Mural and that any proceeds from the sale of E.J. Hughes mural images be deposited into the Public Art Fund.

Nanaimo Community Archives Society (the Archives) acquired permission from the of E.J. Hughes Estate (the Estate) for both the Archives and the City of Nanaimo to use images of the mural in very specific circumstances

The City of Nanaimo and the Archives will share revenue from projects involving the sale of reproductions of the mural on a case by case basis.

### BACKGROUND:

At the 2008-OCT-29 Commission meeting, it was moved and seconded that the City of Nanaimo investigates having a copyright on the E.J. Hughes Mural and that images of the E.J. Hughes Mural be made and used on promotional material, to be sold by the City of Nanaimo, with proceeds going to Art in Public Places.

The EJ Hughes Mural is owned by the Nanaimo Community Archives Society (the Archives) and the City of Nanaimo has been granted a permanent loan of the artwork by the Archives.

The Archives acquired permission from the of E.J. Hughes Estate (the Estate) for both the Archives and the City of Nanaimo to use images of the mural in very specific circumstances. The Estate also gave permission for the mural to be photographed by the public for personal use only. Requests for professional use of the image must be made by application to the Archives.

On a case by case basis the City of Nanaimo and the Archives will work to an acceptable revenue sharing agreement on any projects involving the sale of reproductions of the mural. Any revenue collected by the City of Nanaimo will be returned to the Public Art fund that financed the conservation of the mural.

Respectfully submitted,

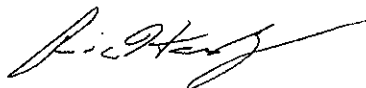

Richard Harding, Director  
Parks, Recreation and Culture

REPORT TO: THE PARKS, RECREATION AND CULTURE COMMISSION  
FROM: RICHARD HARDING, DIRECTOR, PARKS, RECREATION AND CULTURE  
AUTHORED BY: SUZANNE SAMBORSKI, SENIOR MANAGER RECREATION AND  
CULTURE

**RE: DRAFT BEBAN PARK FACILITY REDEVELOPMENT CONCEPT PLAN**

---

**RECOMMENDATION:**

That the Parks, Recreation and Culture Commission hold an open house and forward the DRAFT Beban Park Facility Redevelopment plan for public review and comment.

**EXECUTIVE SUMMARY:**

The Beban Park Facility Redevelopment project got underway in January, 2009.

In late May 2009, the federal government unveiled a new funding program called the Recreation Infrastructure Canada Program (RIInC).

At the 2009-JUN-01 Council meeting, Council passed a motion to "endorse Beban Park Complex Rehabilitation as the application to be submitted for the 2009-JUN-19 deadline for the Recreational Infrastructure Canada Program (RIInC)".

The Beban Park Redevelopment consulting team created a redevelopment concept plan based on current and future demographics, recreation trends, and research to date. The consulting team presented these plans to the Nanaimo City Council and the Parks, Recreation and Culture Commission at a workshop on 2009-JUN-12.

To meet the tight timelines of the RIInC program, staff was unable to get the concept plans to the public prior to submitting the application. It is requested that the Parks, Recreation and Culture Commission receive the Beban Park Facility Redevelopment concept and phasing plan and have an Open House to forward the Plan for public and stakeholder review and comment.

**BACKGROUND:**

The Beban Park Facility Redevelopment project got underway in January, 2009. Throughout the past six months, the consulting team of Asbell Management Consulting Inc. and CEI Architecture gathered input and feedback from stakeholders, the general public and facility users regarding the potential redevelopment of Frank Crane Arena, Beban Pool and the Beban Social Centre.

In late May 2009, the federal government unveiled a new funding program called the Recreation Infrastructure Canada Program (RIInC). The RIInC fund is appropriate for rehabilitation and repair projects of recreation facilities (including arenas, swimming pools, and other multi-purpose physical recreation facilities).

At the 2009-JUN-01 Council meeting, Council passed a motion to “endorse Beban Park Complex Rehabilitation as the application to be submitted for the 2009-JUN-19 deadline for the Recreational Infrastructure Canada Program (RInC)”.

The Beban Park Redevelopment consulting team created a redevelopment concept plan and phasing approach to assist the City in finalizing a funding application by 2009-JUN-19. Based on current and future demographics, recreation trends, and research to date, the consulting team presented concept plans to the Nanaimo City Council and the Parks, Recreation and Culture Commission on 2009-JUN-12.

Part of the redevelopment process included getting feedback from public and stakeholders on the concept plans developed via the planning process. To meet the tight timelines of the RInC program, staff was unable to get the concept plans to the public prior to submitting the application. It is requested that the Parks, Recreation and Culture Commission receive the Beban Park Facility Redevelopment concept and phasing plan and have an Open House to forward the Plan for public and stakeholder review and comment.

Respectfully submitted,



Richard Harding, Director  
Parks, Recreation and Culture

2009-JUN-17  
File: A2-3 / K8-2  
G:\Admin\PRCC\RptComm\PRCCRPT090624BebanParkFacilityRedevelopmentConcept.doc

# Beban Park Redevelopment <sup>497</sup>

Beban Park

2009 06 12



# Map of Beban Park

City of Nanaimo

com

©Weller Cartographic Services Ltd.  
2960 Coagrove Crescent,  
Nanaimo, British Columbia,  
V9S 3P8  
weller@nanaimo.net

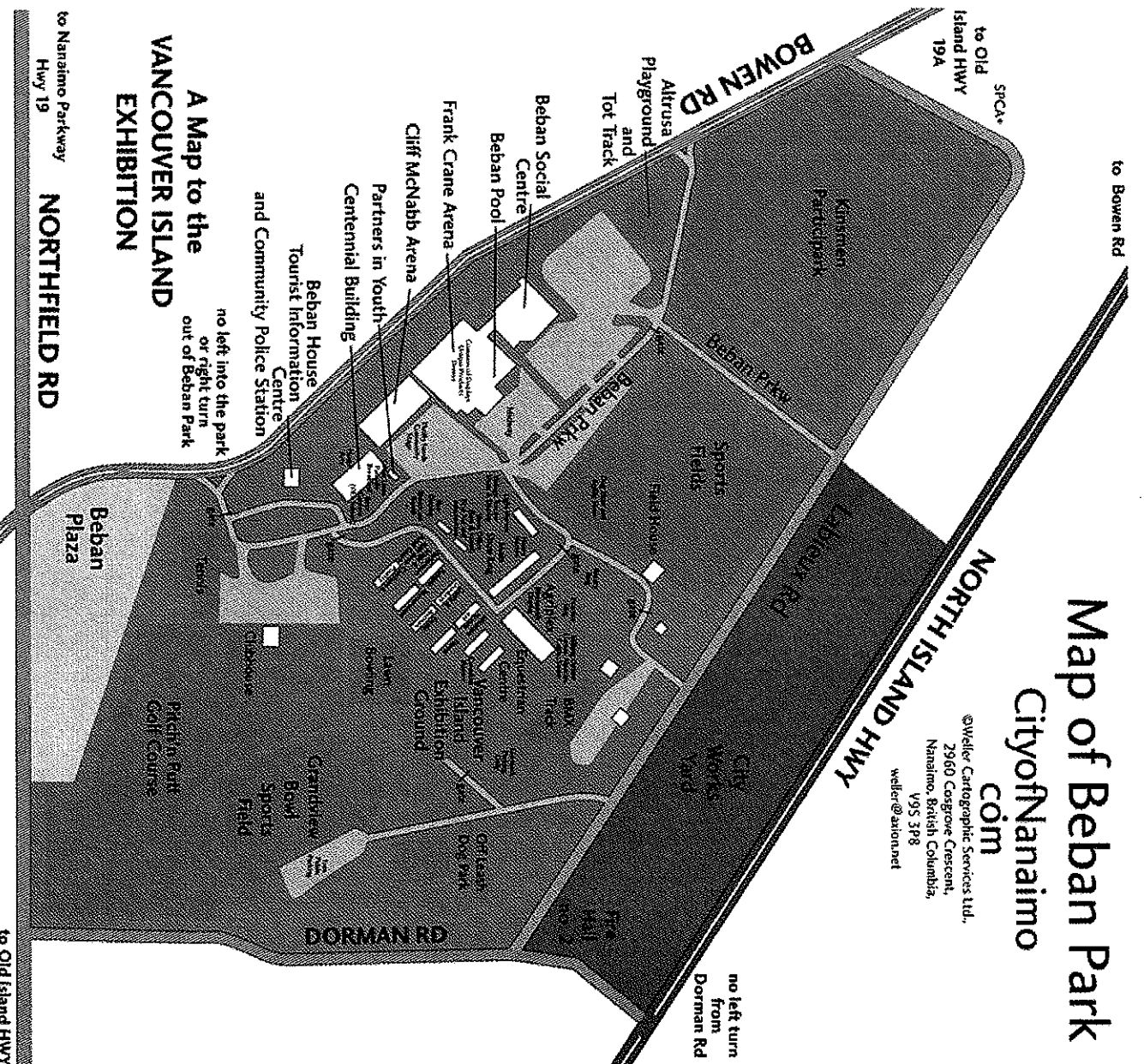

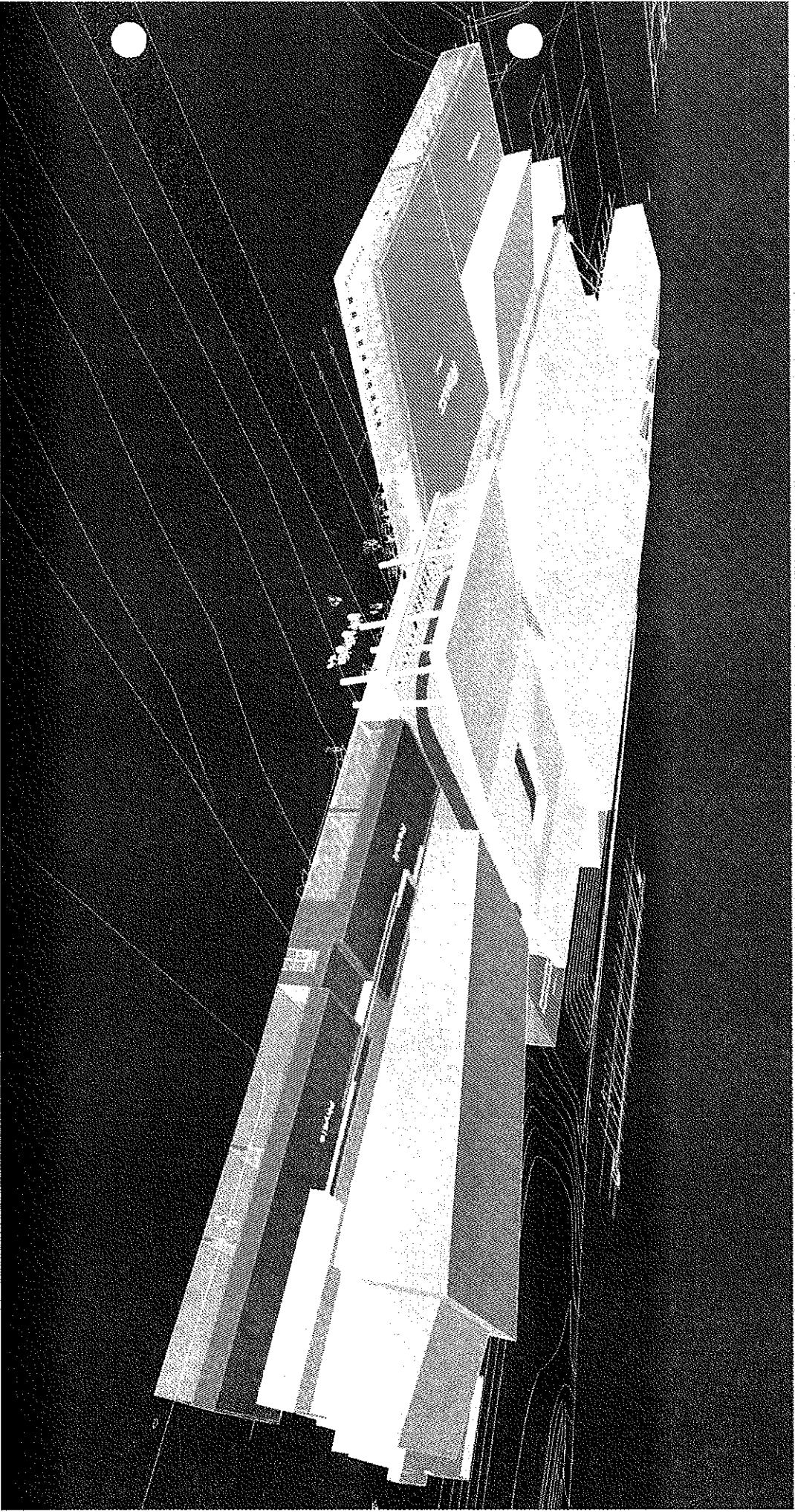

Beban Park

Aerial of site

2009 06 12

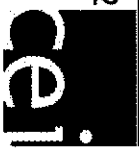



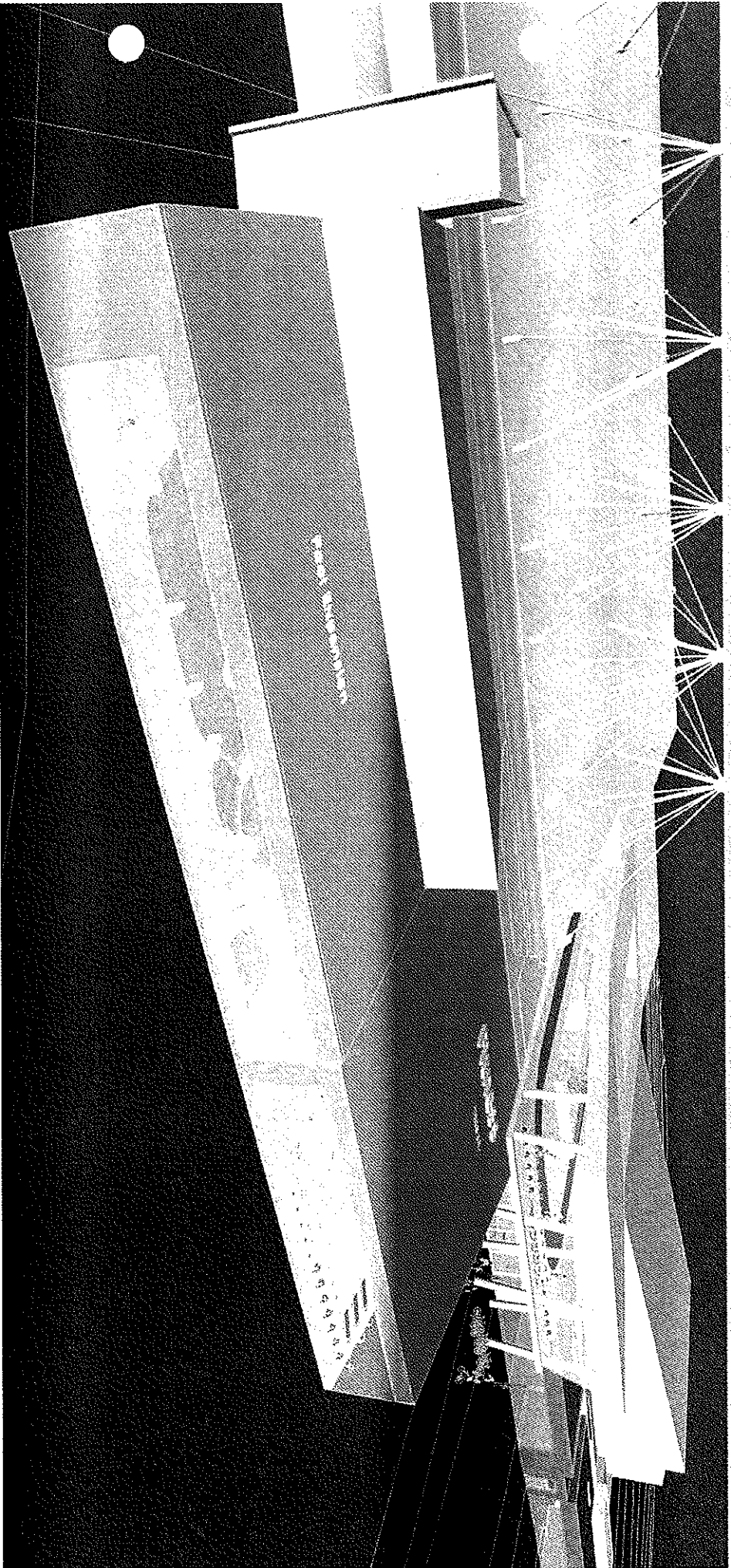



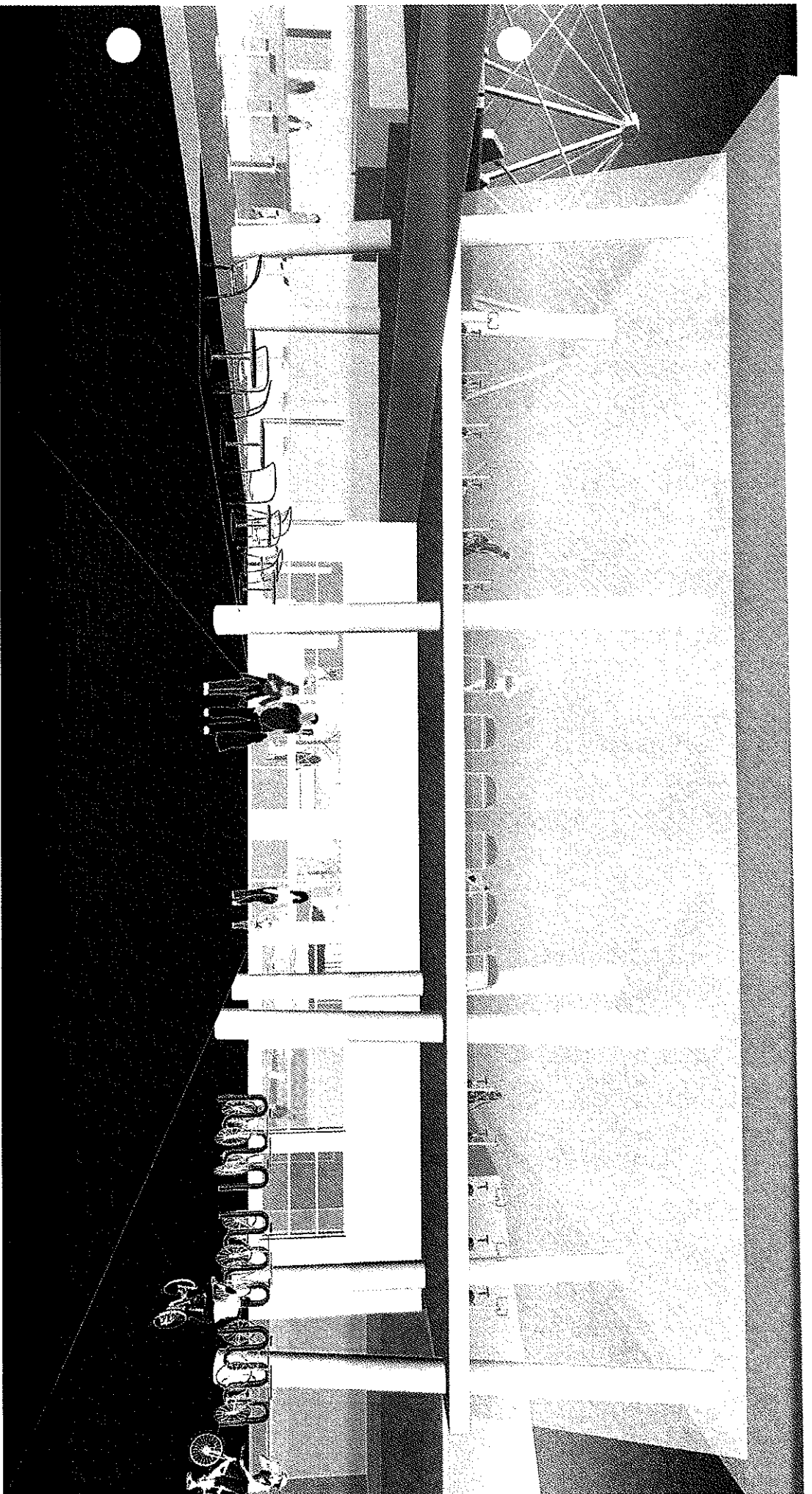

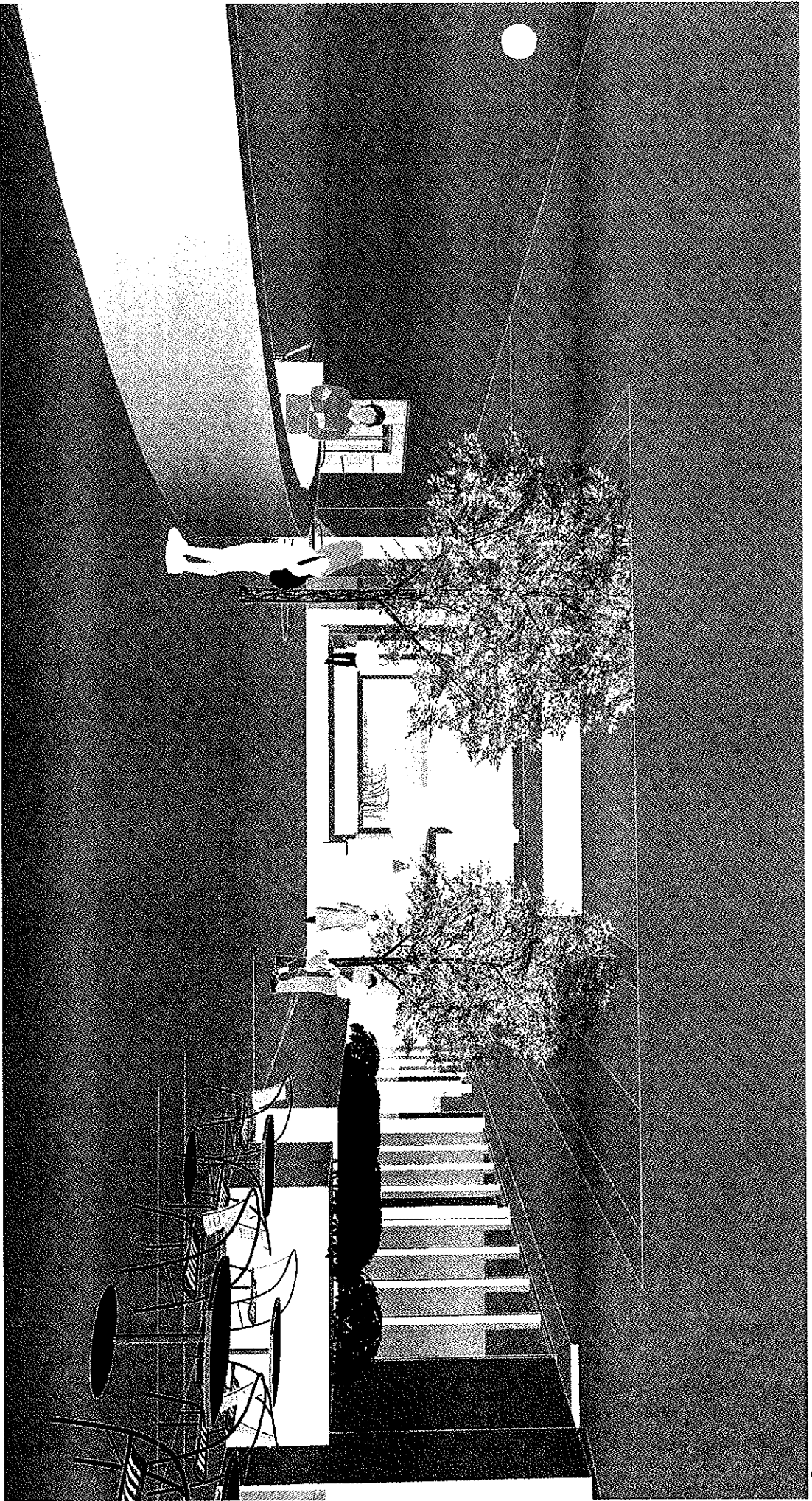

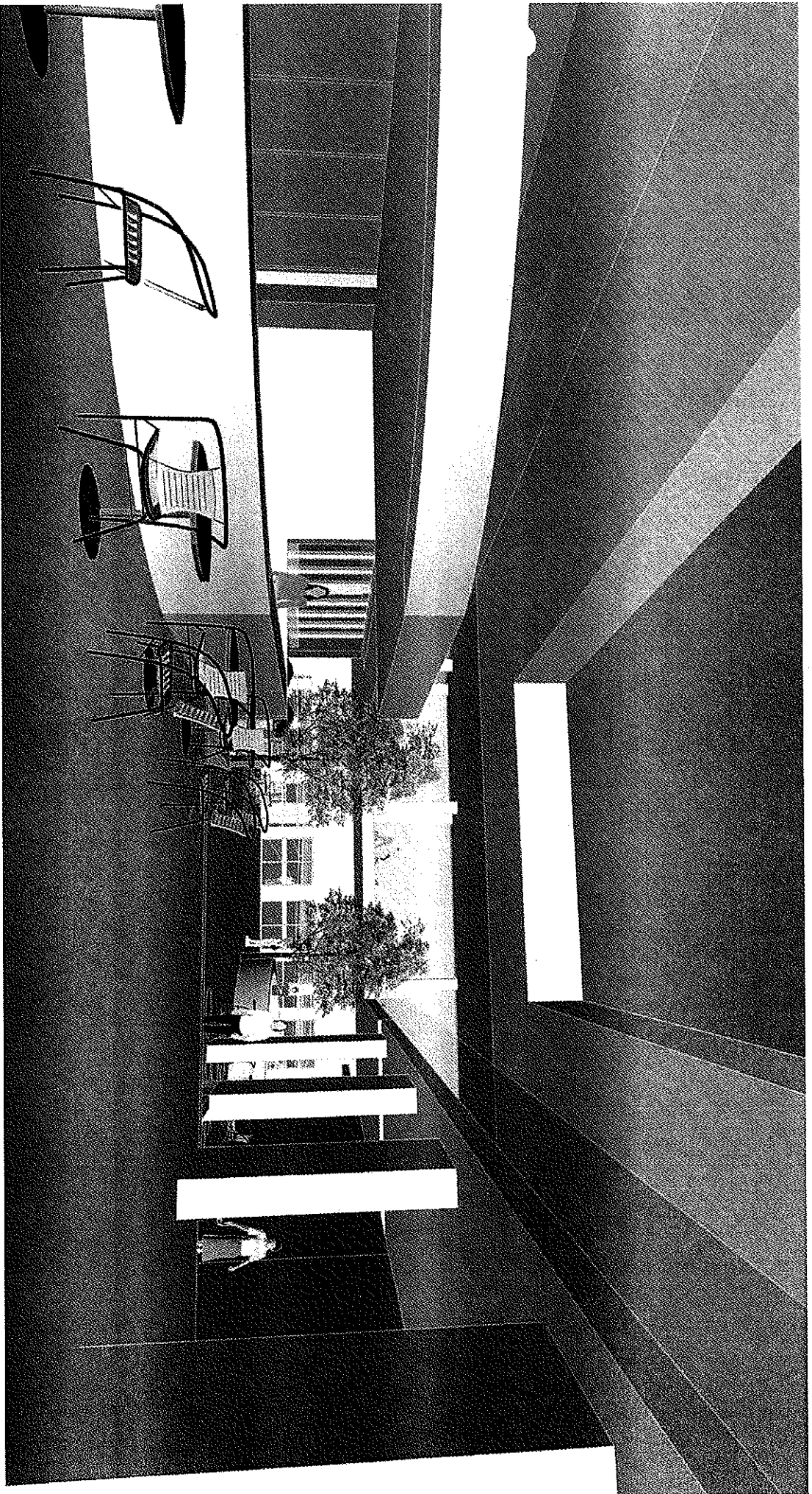



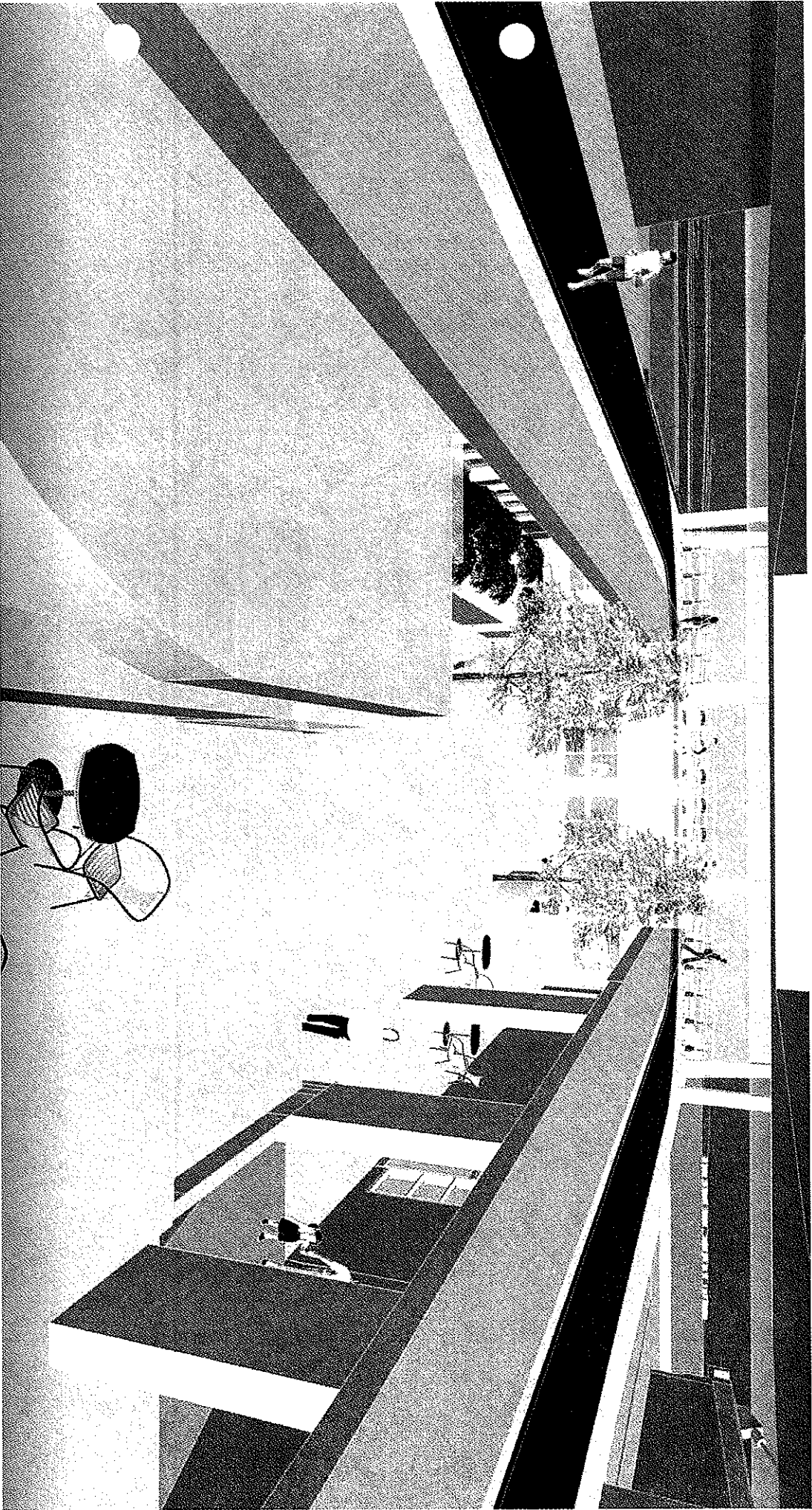

504

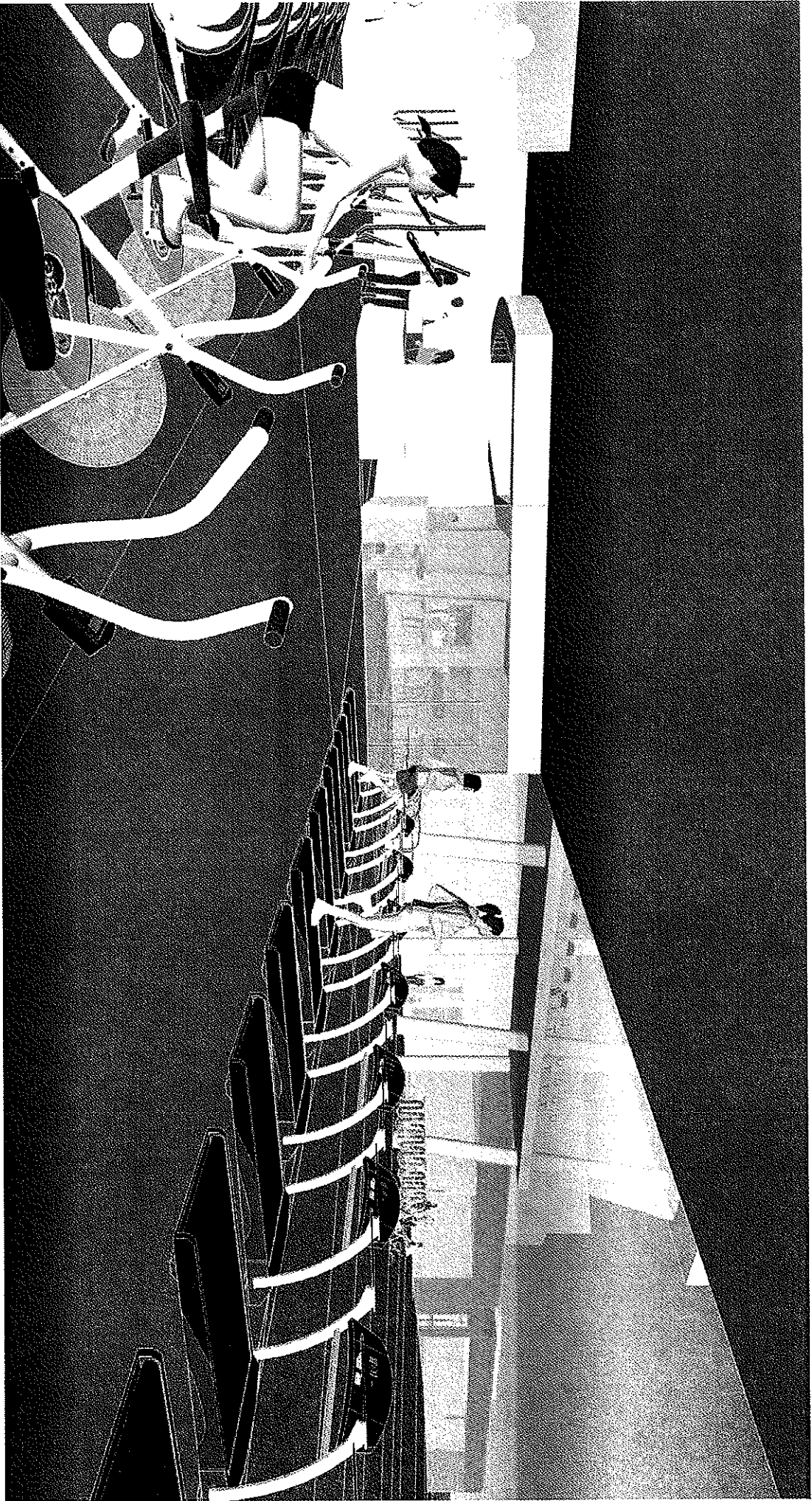

505

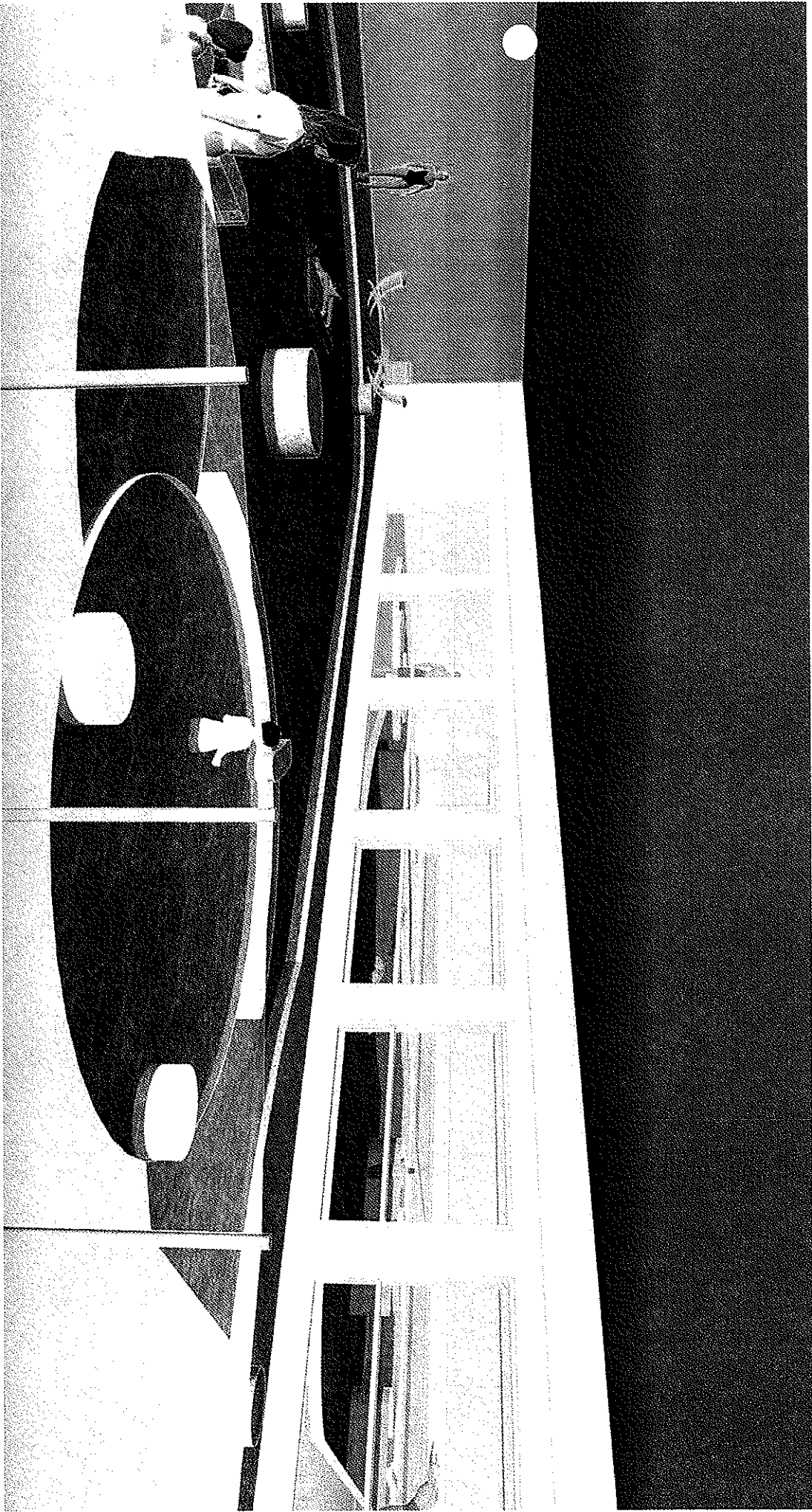

506



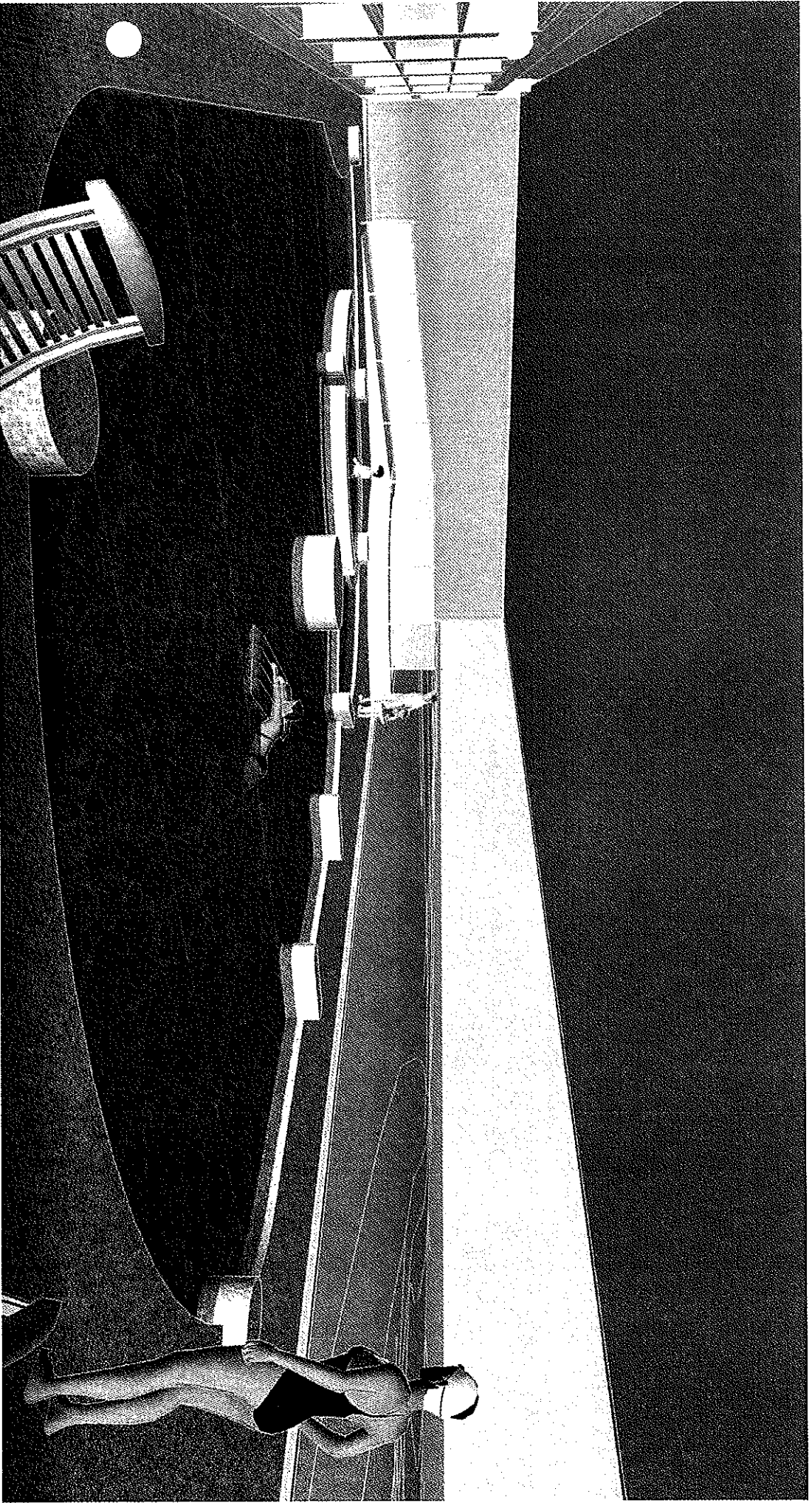

REPORT TO: THE PARKS, RECREATION AND CULTURE COMMISSION  
FROM: RICHARD HARDING, DIRECTOR, PARKS, RECREATION AND CULTURE  
AUTHORED BY: JEFF RITCHIE, SENIOR MANAGER OF PARKS  
**RE: COMMUNITY GARDENS POLICY**

---

RECOMMENDATION:

That the Parks, Recreation and Culture Commission adopt the Community Gardens Policy as attached.

EXECUTIVE SUMMARY:

There are currently two community gardens on public land in the City of Nanaimo. This policy identifies the VIP process that groups would follow to initiate the garden development process, it identifies the need for a "License of Use" agreement, as well as sets some common courtesy rules for the community garden to follow. This policy will enable staff to collaborate with interested groups to further develop community gardens.

BACKGROUND:

The first community garden on City of Nanaimo parkland was at Beaufort Park under the direction of the Montessori School on Waddington Road. This community garden started as communal but currently consists of 17 plots, 3 operated by the school and the remainder allotted to specific individuals in the neighbourhood. This group first came to the Parks, Recreation and Culture Commission in the spring of 2005 and received support under the VIP program.

The second community garden began in 2007 with the Douglas Island Garden Society (DIGS) on Protection Island. Through the VIP program DIGS was allocated funds to start up the garden. The initial garden was 100% communal beds. DIGS are currently requesting nine new additional plots within the existing garden area be allotment beds.

The Community Garden Policy being proposed considers three possible approaches:

- All plots communal.
- All plots are allotted.
- A combination of communal and allotment plots.

Respectfully submitted,



Richard Harding, Director  
Parks, Recreation and Culture



## **COMMUNITY GARDENS POLICY**

### **INTRODUCTION**

Community gardening provides a valuable recreational activity that contributes to community development, environmental awareness, positive social interaction and community education. This Community Garden Policy will enable the Parks, Recreation and Culture Commission and City staff to collaborate with interested groups to develop community gardens. The Official Community Plan promotes food security and neighborhood connections and community gardens foster these goals.

### **DEFINITION**

A community garden is defined as a community development program operated by a non-profit society or community organization. A community garden has the following features:

- Improves the quality of life for people living adjacent to the garden.
- Provides a catalyst for neighborhood and community development.
- Stimulates social interaction.
- Encourages self-reliance.
- Beautifies neighborhoods.
- Produces nutritious food.
- Reduces family budgets
- Creates opportunities for recreation-promoting exercise and therapy.
- Fosters educational opportunities.
- Preserves green space.
- Provides opportunities for intergenerational and cross-cultural connections.

### **CLAUSE ONE**

The Parks, Recreation and Culture Commission will support the development of community gardens in Nanaimo through the following means:

- Providing access to information on the development and operation of community gardens.
- Assisting interested groups in searching for suitable land for the development of community gardens. This inventory must include City-owned land, land controlled by other government agencies, and privately-owned land.
- Assisting in the development of user agreements with the owners of sites chosen.
- Assisting with the development of a community led environmental education program.

### **CLAUSE TWO**

If it is determined that park land is the most suitable site for community gardens, the following conditions will apply: The garden is developed at no cost to the City, except that prior to the first season, the Parks, Recreation and Culture Commission will, through the Volunteers in Parks (VIP) Program, allocate funds to the Garden Society for start-up costs. A community consultation process indicates neighborhood support for the garden.

- A garden site plan must be drawn up and approved by the City. The plan must include the layouts of the plots and include any proposed structures or fences.
- A non-profit society agrees to develop and operate the gardens according to a users agreement which will specify the term of use management responsibilities, user fees and access procedures including the following specific terms:

a. The standard term of the user agreement will be five (5) years. The Parks, Recreation and Culture Commission may consider the granting of multiple terms in exceptional circumstances. The issuance of such longer terms is warranted in circumstances where the Society can demonstrate that the standard five-year term would significantly restrict the Society's ability to:

1. Comply with Parks, Recreation and Culture Commission policies and direction;
2. Conduct community outreach programming beyond the Societies members'
3. Implement a long term plan;
4. Execute significant approved site improvements;
5. Such other circumstances that the Parks, Recreation and Culture Commission deems relevant;
6. For terms longer than five (5) years, a review and formal reporting to the Parks, Recreation and Culture Commission will be required at each five (5) year period and the agreement will incorporate a strengthened termination clause to allow both the Society and the Parks, Recreation and Culture Commission the option to terminate the agreement with adequate notice. Failure to maintain the Community Garden and follow the rules set out in the policy could result in termination of the agreement with three (3) months written notice.

For those gardens with allotment beds:

- Allotments of space will be done by random selection from a waiting list of interested parties. While community gardens are a neighborhood initiative, membership in the Society and the opportunity to be allotted a plot, must be open to any resident of Nanaimo. Organic gardening methods and integrated pest management principles are to be followed. Allotment fees charged by the society must be reported to the City. The Society must adhere to maintenance standards set by the Parks, Recreation and Culture Commission. No barriers to general public access to the site can be erected. Garden practices shall comply with all Parks, Recreation and Culture Commission and City Policies and Bylaws.

Although located on Parks with the prior approval of the Parks, Recreation and Culture Commission, Community Gardens are operated by volunteers from the community.

### **CLAUSE THREE**

The plots within the garden can take any of the following approaches:

**Communal** – all plots are community beds. That is they are open to any members of the community to gather and garden to grow what is agreed to collectively by the members. Maintenance of the beds is the responsibility of all members. The produce is there for the community.

**Allotment** – all plots are allotted to individuals who can grow whatever they choose.

**Combination** – the garden is a combination of community and allotment beds.

### **BENEFITS OF ALLOTMENT BEDS**

- Individuals more willing to contribute to their plot and while simultaneously contributing to the community garden at large.
- Increase the use of parkland for recreational enjoyment.
- Opportunity for individuals to grow their own food.
- Those interested in an allotment bed would be placed on a list and selected through a draw.
- The term and fee for the allotment would be determined by the Community Garden Society in conjunction with Parks staff.
- The opportunity for an allotment bed would be open to the entire neighborhood community.

### **COMMON COURTESY RULES OF THE COMMUNITY GARDEN**

- Garden organically;
- Maintain paths adjacent to your plot;
- Allow your neighbors their fair share of sun;
- Water responsibly;
- Secure the tool boxes and shed and help maintain tools;
- Produce may not be sold, but sharing produce is encouraged;
- If you go out of town, have someone maintain your garden;
- Don't smoke in the garden;
- If you bring a radio to the garden; keep the volume low;
- Take home your garden waste;
- Keep your dog on a leash, within the boundary of your plot;
- Resolve differences in a neighborly way;
- Closely supervise your children;
- You must provide at least eight (8) hours of communal time;
- Don't neglect your plot.

**REPORT TO: RICHARD HARDING, DIRECTOR, PARKS, RECREATION AND CULTURE**

**FROM: JEFF RITCHIE, SENIOR MANAGER OF PARKS**

**RE: MONTHLY REPORT FOR MAY 2009 – PARKS OPERATIONS**

---

The following highlights are the park initiatives for May 2009. Regular maintenance tasks are not listed.

### **PARK DEVELOPMENT AND SPECIAL PROJECTS**

- The Maffeo Sutton Spirit Square will be completed in June with the grand opening scheduled for Canada Day, 2009-JUL-01. Improvements to the parking lot and Snuneymuxw First Nations site continue with construction winding up in July. Design work will begin over the summer for Phase 2 which entails the new amenities building.
- The Oliver Woods Wellness Park has been installed and will be opened on 2009-JUN-24.
- The Deverill Square water park is complete and open. The next phase of improvements is expected to begin early 2010.
- Design and tender work for more improvements at Diana Krall Plaza are underway.
- Staff is reviewing a second draft of the Sports Field Strategy and will post it online for user group review over the summer. A focus group will be scheduled with user groups for September.

### **VOLUNTEERS IN PARKS**

- Over 50 volunteers from various neighbourhood associations attended a plant-out in Maffeo Sutton Park on 2009-JUN-03 and assisted staff in planting the newly-built landscaped beds. The planting was a requirement from the "Trees for Canada grant that was received for the park improvements.
- Park wardens are removing broom at Neck Point Park.
- An introductory neighbourhood meeting was held at Rockridge Park on 2009-MAY-20 at 6:00 p.m.
- The Stephenson Point Neighbourhood Association is busy removing invasive species from neighbourhood parks.
- VIP broom bashing was completed at Neck Point.
- Carmanah Way VIP playground installation is complete.

### **TRAIL DEVELOPMENT**

- The new trail connection from Merle Logan Field to the Lions Pavilion has been completed. New fencing has been installed to separate the trail from the VIEX site.
- A new paved trail at Ecole L'Ocean was installed. The trail runs the perimeter of the school grounds and allows access to the highway tunnel crossing.
- The gravel trail at Oliver Woods was completed.

## **MAINTENANCE AND CONSTRUCTION**

- Parks Carpenters constructed a new kiosk for the disc golf at Bowen Park. VIP group will be replacing all the tee boxes using concrete instead of rubber matting.
- A new play structure was installed at Country Club Park.
- The Raines Cabin in Bowen Park was dismantled and returned to the original site, where the owner plans to rebuild it.
- Staff have been working on the completion of the Maffeo Sutton Spirit Square including: upgrades to the existing washroom, installing litter receptacles, installing signage and various other items.
- Painting has been completed at Maffeo Sutton, along the waterfront and the downtown area. Bleachers at Gyro Park and Robins Park have been repaired and painted for the season. Washroom buildings have also been spruced up for the summer.
- Utility staff had to do major repairs at the Bowen East Washroom Building due to vandalism.

## **HORTICULTURE**

- Parks has assigned a (summer) full-time staff presence at Maffeo Sutton Park, with the intention to answer all questions from visitors as well as perform a list of duties to keep the park fresh and clean.
- Parks Horticulturists held two very successful hanging basket workshops for the City Wellness Committee.
- Staff has completed landscape renovations at the entrance into the Nanaimo Aquatic Centre, Beban Youth Gyro Facility Entrance and Hailey's Rhododendron Grove.
- A new rock garden was installed in Maffeo Sutton Park near the public art statue.
- Staff have been working with volunteers who will be planting annual plants at the Bowen Lawn Bowling club and the entrance to Beach Estates Park.
- Nanaimo Parks Department has partnered with Foodshare and Nanaimo Community Gardens and have planted two demonstration gardens at Beban Park and City Hall gardens. (see report).

## **TURF AND PARKS**

- Comox Park has had shrub clean-up and trees limbed up to open sight lines.
- There are new caretakers at Westwood Lake.
- We are continuing with needed static security at Westwood Lake, Long Lake and the new Maffeo Sutton Park.
- Egg Addling program continued this year at all City lakes.

## **URBAN FORESTRY**

- An Urban Forest Management Strategy Open House was held Wednesday, 2009-JUN-03 at Oliver Woods Community Centre. Those that attended gave valuable feedback and offers of support.
- Seven Tree Removal Permits were processed for various subdivisions and commercial development sites.
- Hazard tree removals and dead wooding of trees occurred in several locations including the beach access on McGuffie Road, Mansfield Park, Country Hills Park, Kin Park, Captain Morgan Park, Beban Park, Bowen Park and Comox Park.
- Grinding of stumps took place at Country Club Park in preparation for installation of new play equipment.
- Two trees were planted in the downtown area on Victoria Crescent and Commercial Street as replacements for trees lost during the winter to MVA's.
- Five Tree Management Plans were reviewed for prospective subdivisions and commercial developments.
- Ninety phone calls were received regarding tree concerns and questions resulting in sixty-seven site visits.

## **TRAIL COUNTS FOR MAY 2009**

<b>Park Sites</b>	<b>March Daily Average</b>	<b>April Daily Average</b>	<b>May Daily Average</b>	<b>May Peak Time Of Use</b>
Bowen Side Channel	55	73	119	3:00 p.m. – 4:00 p.m.
Diana Krall Plaza (Conference Centre stairs)	96	135	203	12:00 noon – 1:00 p.m.
Diana Krall Plaza (Commercial Street)	407	534	639	12:00 noon – 1:00 p.m.
Diana Krall Plaza (Port Theatre Stairs)	264	333	455	12:00 noon – 1:00 p.m.
*E&N Trail (Terminal Park Bus Stop)	58	72	74	2:00 p.m. – 3:00 p.m.
*Westwood Lake Entrance	134	201	263	4:00 p.m. – 5:00 p.m.
*Oliver Woods Playground (Side Entrance)	68	92	97	2:00 p.m. – 3:00 p.m.
*Oliver Woods Playground (Front Entrance)	100	139	155	2:00 p.m. – 3:00 p.m.
Pipers Spit	192	222	278	5:00 p.m. – 6:00 p.m.
Pipers Knoll	78	137	184	5:00 p.m. – 6:00 p.m.

(\* Numbers have been divided by two as counter location is point of entrance and exit)

## **VANDALISM REPORT FOR MAY 2009**

### **BUILDING AND ENGINEERING R&M**

- |                                      |             |
|--------------------------------------|-------------|
| • Graffiti removal and painting      | \$ 4,501.02 |
| • Replace broken window Port Theatre | \$ 294.25   |
| • Tree replacement                   | \$ 1,057.50 |

<b>COST</b>	<b>\$ 5,852.77</b>
-------------	--------------------

### **MATERIALS AND SUPPLIES**

- |                                |           |
|--------------------------------|-----------|
| • Materials for Bowen Washroom | \$ 804.71 |
| • Fencing for NIC trail        | \$ 213.99 |
| • Misc Supplies                | \$ 589.89 |

<b>COST</b>	<b>\$ 1,608.59</b>
-------------	--------------------

### **LABOUR AND FLEET (City Vehicles)**

<b>COST</b>	<b><u>\$ 3,126.42</u></b>
-------------	---------------------------

<b>TOTAL COST</b>	<b>\$10,587.78</b>
-------------------	--------------------

It was a busy month of vandalism. Both washrooms at Bowen East were totally destroyed with toilets broken, sinks and cabinets torn off, bathroom partitions broken and holes kicked in the walls. Staff were able to make quick repairs and re-open in time for a scheduled picnic. Graffiti removal occurred at many locations. Red hearts have been showing up on trees, rocks and other places. Removal from trees and rocks in isolated areas is proving to be very difficult. Windows broken twice at the Rotary Field House (invoice not received yet), the old Museum and at the Port Theatre. Fencing on the NIC trail was cut. Trees at NIC and Victoria Road were vandalized.

**REPORT TO: RICHARD HARDING, DIRECTOR, PARKS, RECREATION AND CULTURE**  
**FROM: SUZANNE SAMBORSKI, SENIOR MANAGER OF RECREATION AND CULTURE SERVICES**

**RE: MONTHLY REPORT – MAY 2009 - RECREATION AND CULTURE SERVICES**

---

***Recreation and Culture***

Harbour City Seniors' programs and special events continue to be popular with residents. 1,749 memberships have been sold since 2008-NOV-01; this is 43 more than last year at this time. 410 participants attended Thursday Special Events during May and 102 seniors took part in van trips. The Nanaimo Harbour City Seniors Annual General Meeting was held 2009-MAY-20 with 15 in attendance.

Department programs running in Cinnabar Elementary School were very successful in June, with 19 of 22 spots filled. Evaluations showed that parents would like to see more sports and dance programs offered in Cinnabar Valley.

Two "Fitness in the Park" programs started at Beban Participark, with the necessity to add two more classes due to popularity. The program teaches participants to use fitness equipment located in the Participark.

The City was awarded a BCRPA Facility Excellence Award for the Oliver Woods Community Centre at the recent BCRPA Conference. The award will be on display at that facility. The Oliver Woods Adult Fitness Park site preparation is now complete and the park is being installed with a grand opening date set for 2009-JUN-24.

The Healthy Bites Committee participated in two teleconferences with approximately 20 other communities. The Committee, with the assistance of a VIHA nutritionist, has prepared a PowerPoint presentation as a resource guide for the City of Nanaimo. A vendors forum will be held in June, along with a final vending machine/vendor services audit and customer survey.

Staff presented at Vancouver Island University (VIU) to third year Child and Youth Care students and covered various topics such as the Healthy Choices Program, LEAP, and Youth and Special Needs programs. Staff also participated in the recent Country Club Mall Children's Festival where information regarding Department programs was provided to the public.

Healthamongus ran for only two of the five days planned due to weather, however, managed to put 1,700 participants through the event.

Nineteen LIT/QUEST presentations were done in schools by the LIT/QUEST Coordinator, resulting in an increase to 81 registered in the leadership program, up from 44 registrations in 2008. Nanaimo Youth Week was held 2009-MAY-01 to 2009-MAY-07, with special activities including a BBQ and Karaoke Night with 160 participants, a beach volleyball tournament, a viewing of the movie "Twilight", and a Choosing Health & Integrating Changes ("CHICS") workshop. A group of youth are planning a fundraiser at Harewood Lacrosse Box entitled



“Youth Sticking Together”, with the ultimate goal of setting a new world record for the longest street hockey game played. The original date was planned for early in July 2009, but has been postponed until 2010.

An enhanced recycling program is being put in place at all major PRC facilities in partnership with the Nanaimo Recycling Exchange. Summer camps will be working closely with the new program as part of the department’s sustainability focus.

### ***Aquatics***

In May there were 627 participants registered in lessons at the Nanaimo Aquatic Centre (NAC) and Beban compared to 520 in May 2008. The 2009 numbers are higher because of higher registration and no lessons at NAC in 2008 due to maintenance shutdown.

An Aquatic Emergency Assistant course was offered to the front end staff at NAC and Beban to provide them with information about their role in an aquatic emergency and to offer some insight into the more challenging rescues that are performed by lifeguards. The school swim lesson program has been streamlined to provide a better, more consistent product to schools.

The Riptides Swim Team held a very successful “Spring Sprint” invitational meet at NAC with over 200 swimmers attending. Preparations are underway for the Vancouver Island Regional Championships to be held at NAC in the beginning of June.

### ***Arenas***

Nanaimo Ice Centre was host to the Trade Show for International Fire Chief Convention 2009-MAY-28 to 2009-JUN-02. Over 1,000 people visited the show each day, viewing 350 exhibits.

Cliff McNabb is the only Department arena with ice in at this time. Forty-three percent (43%) of all “arena” hours booked overall for the month of May were booked at Cliff McNabb. For the month of June there are only 88 hours of ice available to book between 7:00 a.m. and 11:00 p.m.

## Statistics

### Front Desk:

May 2009	2008	2009	Difference
<u>Numbers</u>			
Registrations	3,036	2,979	-57
FITT Passes	89	142	53
Economy Tickets	7,258	8,664	1,406
<b>TOTAL:</b>	<b>10,383</b>	<b>11,785</b>	<b>1,402</b>
<u>Sales</u>			
Registrations	178,268	244,475	66,207
FITT Passes	14,085	22,251	8,166
Economy Tickets	24,527	30,537	6,010
<b>TOTAL:</b>	<b>216,880</b>	<b>297,263</b>	<b>80,383</b>

### Arenas:

May 2009	Hours of Use		Attendance	
	Current Month	Last Year	Current Month	Last Year
Public Admissions:	64.50	55.0	1,032	682
Lessons: Department programs and Schools:	85.75	73.5	1,532	2,064
League Rentals:	327.50	324.5	14,148	10,367
Other/Casual:	326.25	189.0	7,984	5,812
<b>TOTAL:</b>	<b>804.00</b>	<b>642.0</b>	<b>24,696</b>	<b>18,925</b>

<u>Hours:</u>		<u>Attendance:</u>	
FCA –	117.25	FCA –	8,012
NIC 1 –	175.25	NIC 1 –	6,380
NIC 2 –	169.50	NIC 2 –	3,218
CMM –	342.00	CMM –	7,086
<b>Total –</b>	<b>804.00</b>	<b>Total –</b>	<b>24,696</b>

### Receipts:

May 2008: \$455,893  
 May 2009: \$504,381

### L.E.A.P.:

January to May 2008: 768 applications  
 January to May 2009: 1,026 applications

## 2006 to 2009 Recreation and Culture Programs Registrations and Revenues

**Program Registration Revenue**

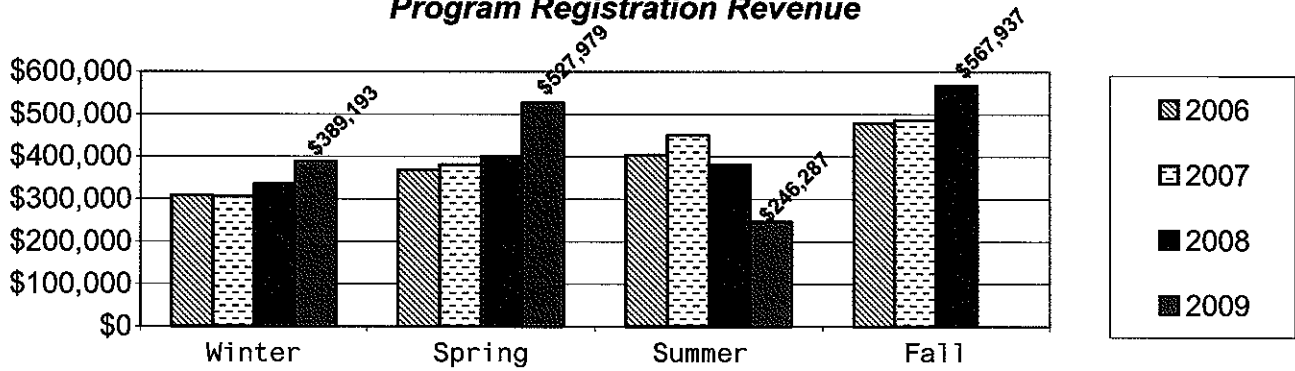

**Program Registrations\***

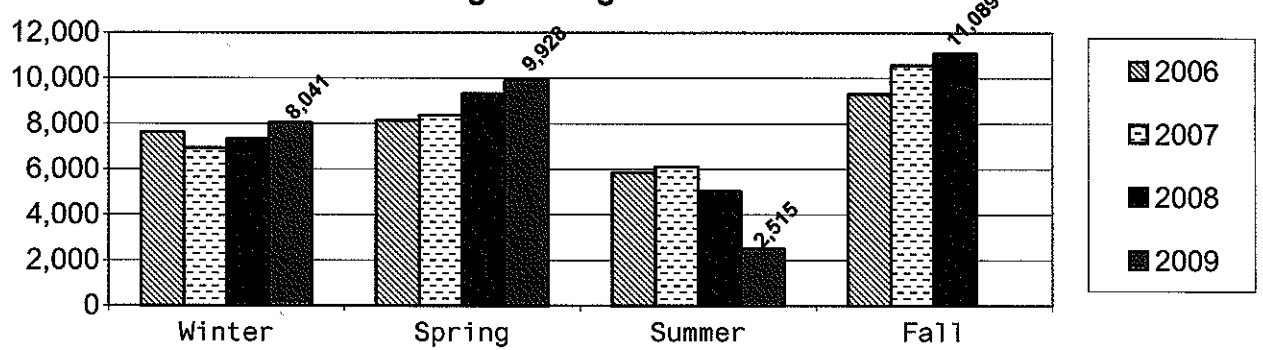

## Summary of Recreation And Culture Services - May 2009

### Arena Public Skate Revenue

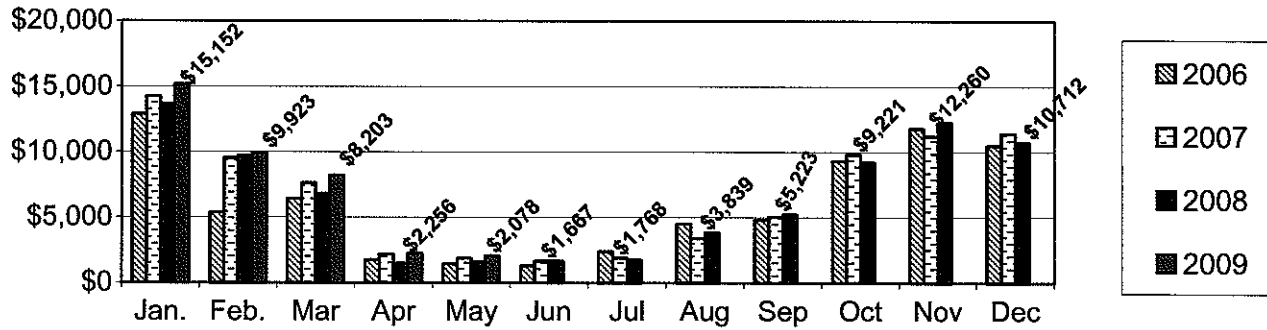

### Arena Public Skate Admissions

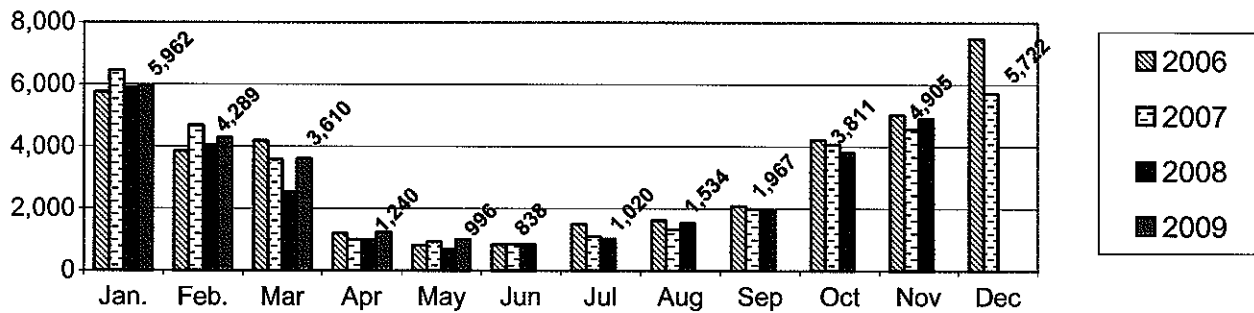

### Aquatic and Fitness Gym Revenue

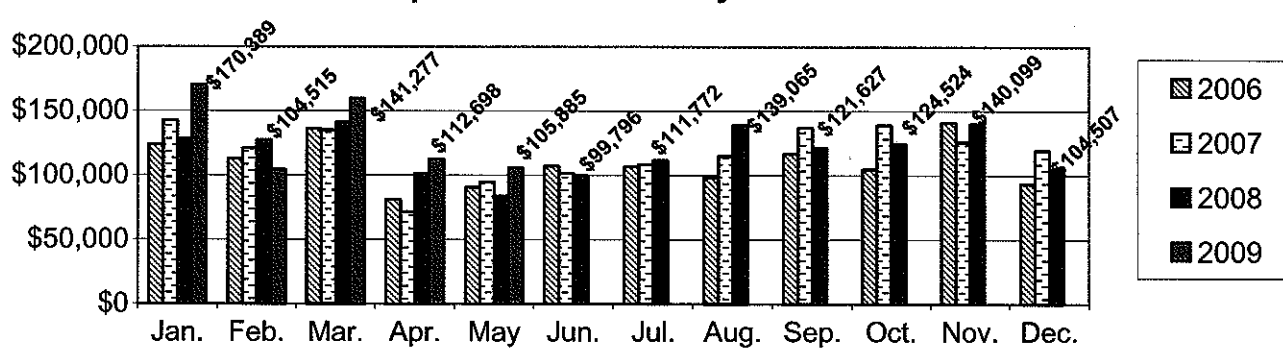

### Aquatic and Fitness Gym Public Admissions

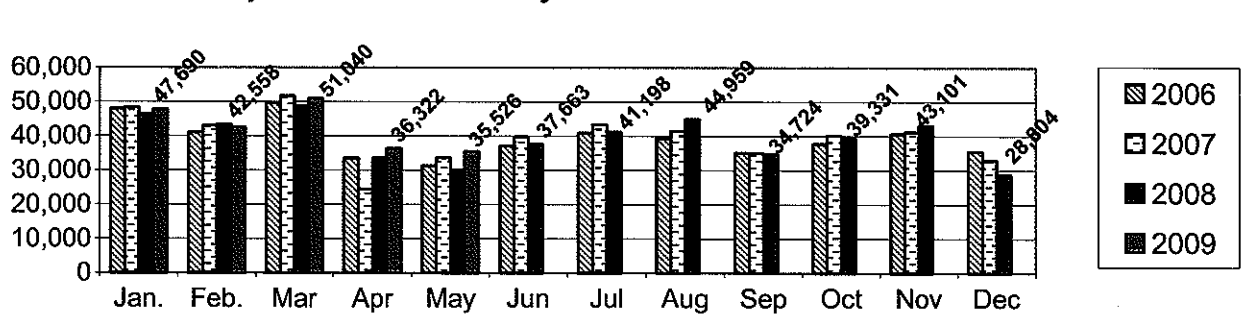

**MINUTES OF BOARD OF DIRECTORS' MEETING**  
**NANAIMO HARBOUR CITY SENIORS - June 12, 2009**

**In Attendance**

President Lynda Avis in the Chair, Jane Adkins, Sally Monteith, Colleen Evans, Pat Foley, Bob Davies, Brian Sugiyama.

**Regrets:** Bob Nixon, Anne Smith, Miriam Peacock.

**Call to Order**

President Lynda called the meeting to order at 9 a.m.

**Welcome to New Board Members**

Lynda congratulated the returning officers and welcomed our new Director, Sally Monteith.

**Changes/Additions to Agenda**

None.

**Minutes of Last Meeting**

**M/S/C** That the minutes of the May 1<sup>st</sup>, 2009 meeting be adopted as read.

**Business Arising from the Minutes**

1. Wellness Park - Official Opening of the Wellness Park is scheduled for Wednesday, June 24<sup>th</sup>. Refreshments will be served after the Opening. Brian asked if any Directors could come about 10:30 a.m. to help organize refreshments, etc., it would be appreciated. There is also a media shoot scheduled for Monday, June 22<sup>nd</sup> at 10:15 a.m. Directors were asked to be in attendance if at all possible.
2. Mid-Island Co-op Health & Wellness Workshops - Brian said that 9 people came to the Workshop held on May 27<sup>th</sup>. The last Workshop of the series will be on June 24<sup>th</sup> and should be well-attended - the topic is "Abuse and Neglect of Seniors".
3. Summer Meeting with Mayor Ruttan - scheduled for Thursday, August 13<sup>th</sup>, at 9 a.m. at Bowen Complex. Lynda would appreciate any suggestions on items to be discussed at this meeting.

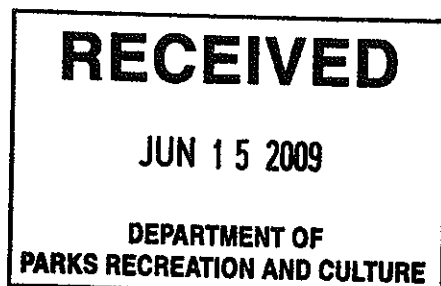

521

**Correspondence**

1. Lynda advised that a letter has been received from the Federal Government re our Non Profit status and that we will be assigned to an officer within the next six months.
2. Lynda has received an email from Hilde Schlosar of the Multicultural Society advising that they are still waiting for approval for their New Horizons grant.

**Financial Report**

In the absence of the Treasurer, Lynda reported that a Money Order in the amount of \$18,000.00 will be sent by the Secretary to the City of Nanaimo as our contribution to the Wellness Park.

**M/S/C**      That a Money Order in the amount of \$18,000.00 be sent to Mr. Jeff Ritchie, Senior Manager of Parks, City of Nanaimo, as our contribution to the Wellness Park.

**COMMITTEE REPORTS**

**Program**

No report.

**Lobby**

No report.

**Seniors Coordinator**

- A total of 1749 memberships have been sold to date, 43 of which were sold over the past month.
- Spring activities continue with some new seasonal classes starting up. Some computer classes were cancelled but other programs are fully registered.
- Bob Davies noted that the kitchen cupboards upstairs at Bowen Complex are in need of a good cleanup. Secretary was asked to send a note to Bob Kuhn asking if the custodial staff could see to this.

**New Business**

1. Summer Dance - scheduled for Friday, August 14<sup>th</sup>, with cocktails at 6:15 p.m. and dinner to be served between 7:15 and 8:15 p.m. Catering will be done by Spice of Life, with dancing to follow until 11 p.m. Anne Smith and Bob Nixon will be in charge of the bar, with Jane Adkins helping out. Pat and Colleen volunteered to take tickets at the door, and Sally and Bob will sell bar tickets. Directors were asked to help decorate the hall in the afternoon.
2. Website Update - Lynda said that David Burns is doing an excellent job on our new website. The Computer Club has requested that their newsletter be incorporated into our website. Brian said that the Seniors' newsletters will be printed every two months from now on, instead of monthly.
3. Goals and Objectives for 2009-2010 - Lynda asked the Directors to give this some thought over the summer.

**Adjournment**

Meeting adjourned at 10 a.m.

**Next Meeting**

Friday, September 4<sup>th</sup>, at 9 a.m. at Oliver Woods - Hemlock Room. Terry Paterson will take the photo of the Directors following the meeting.

/pf